

# ASSEMBLY INSTRUCTIONS FOR FASTENER FREE PARTITION CUPBOARD.

- PLEASE STUDY THE ASSEMBLY INSTRUCTION CAREFULLY & FAMILIARISE YOURS SHELF WITH PARTS BEFORE ASSEMBLY .
- TOOLS REQUIRED: WORK AREA AT TABLE HEIGHT LEVEL & SOFT HAMMER
- ENSURE THAT THE ITEMS LISTED IN PARTS LIST ARE PRESENT BEFORE ASSEMBLY

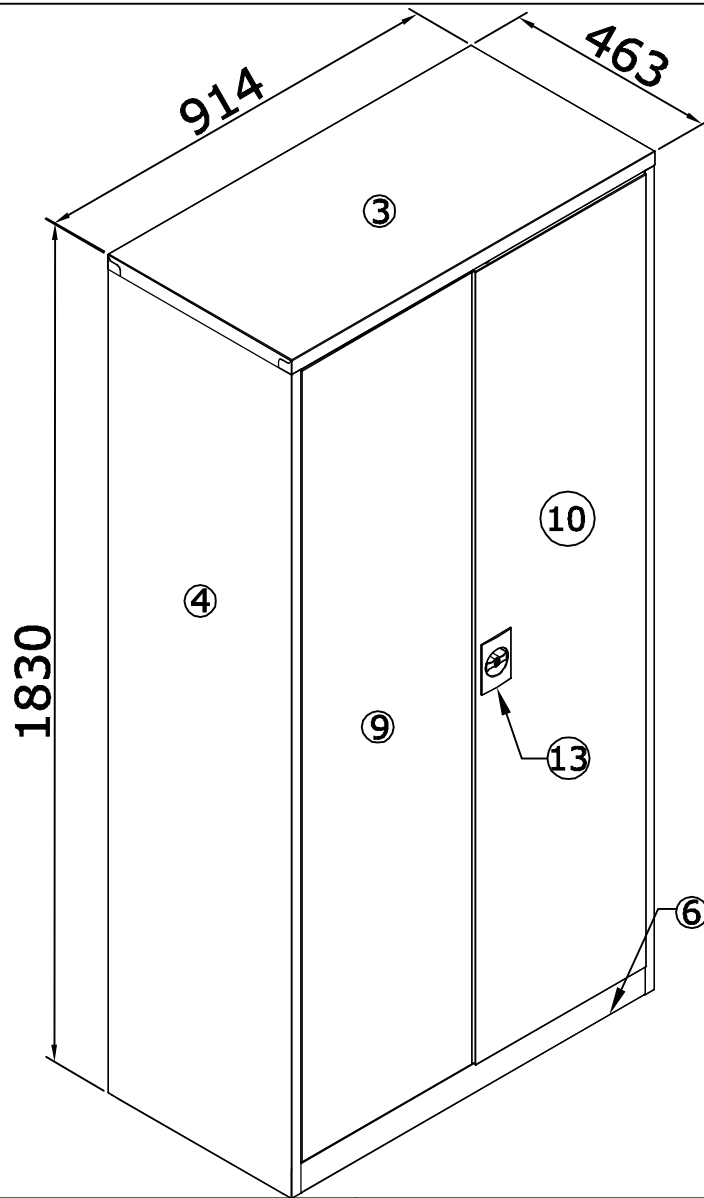

## PART LIST

PART NO	DESCRIPTION	QTY.
1.	BACK PANEL(RH)	1
2.	BACK PANEL (LH)	1
3.	TOP PANEL	1
4.	SIDE PANEL (LH)	1
5.	SIDE PANEL (RH)	1
6.	FRONT FRAME ASSY	1
7.	BACK FRAME ASSY	1
8.	BOTTOM PANEL	1
9.	DOOR(LH)	1
10.	DOOR (RH)	1
11.	HINGE PIN	6
12.	HANGING ROD	1
13.	LOCK	1
14.	SHELF SUPPORT BRACKET	16
15.	SHOOTING BOLT	2
16.	'L' ANGLE	2
17.	PARTITION PANEL	1
18.	SHELF	4
19.	FIX SHELF	1

## HARD WARES

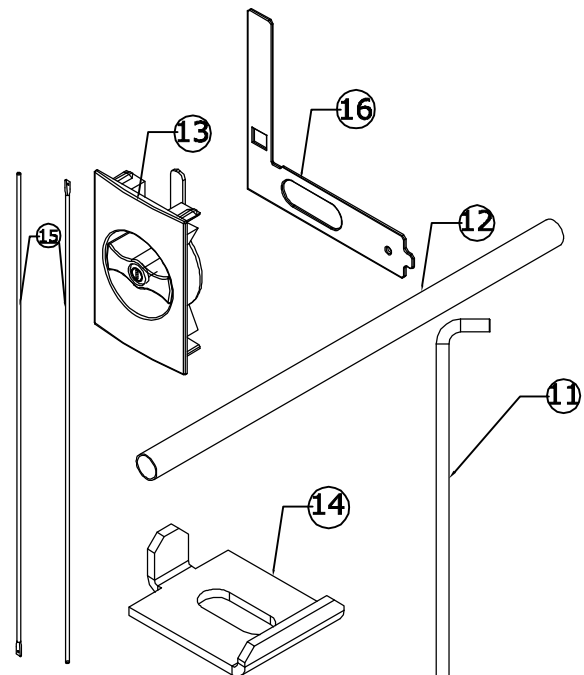

**STEP:6A**

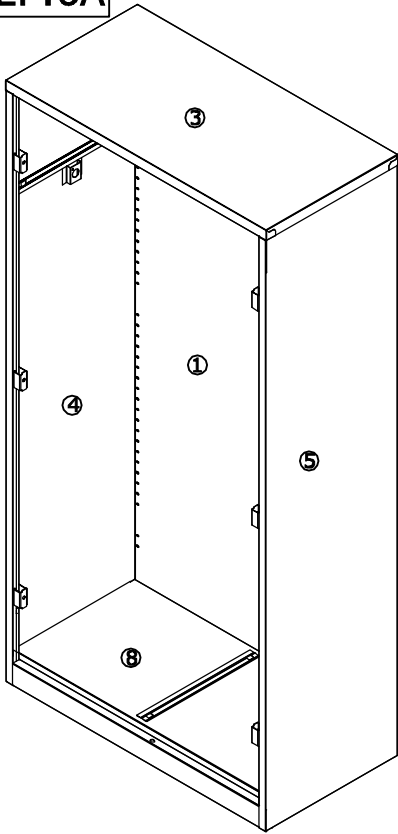

**LIFT THE CABINET TO VERTICAL POSITION**

**STEP: 7** **FIX SHELF ASSEMBLY**

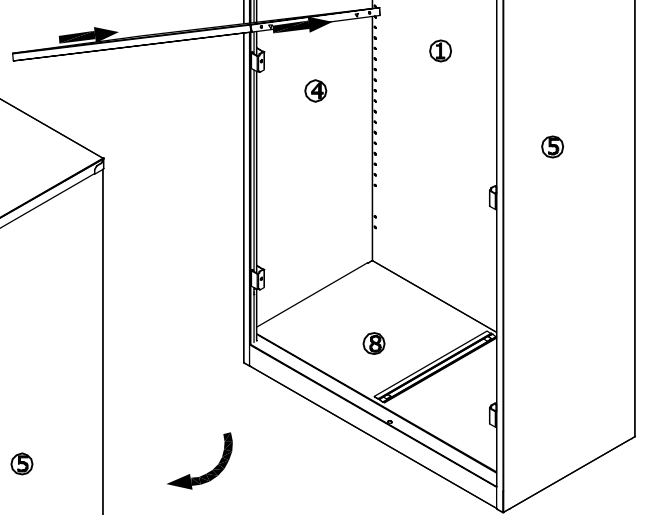
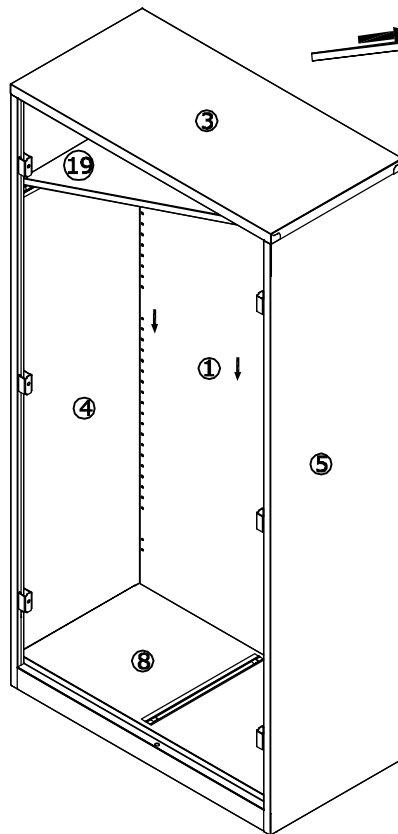
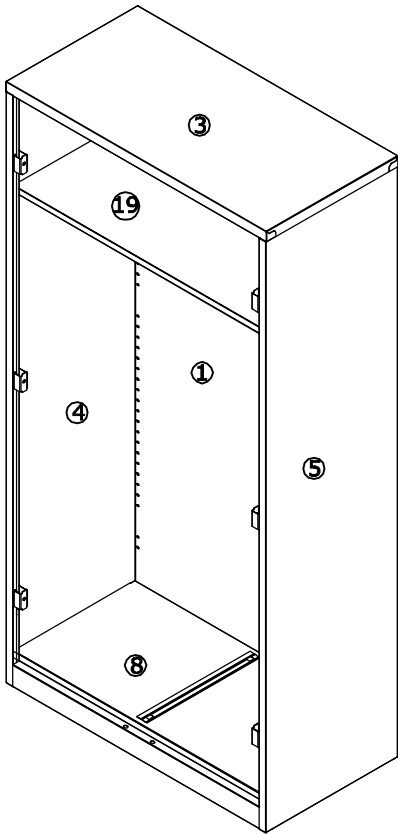
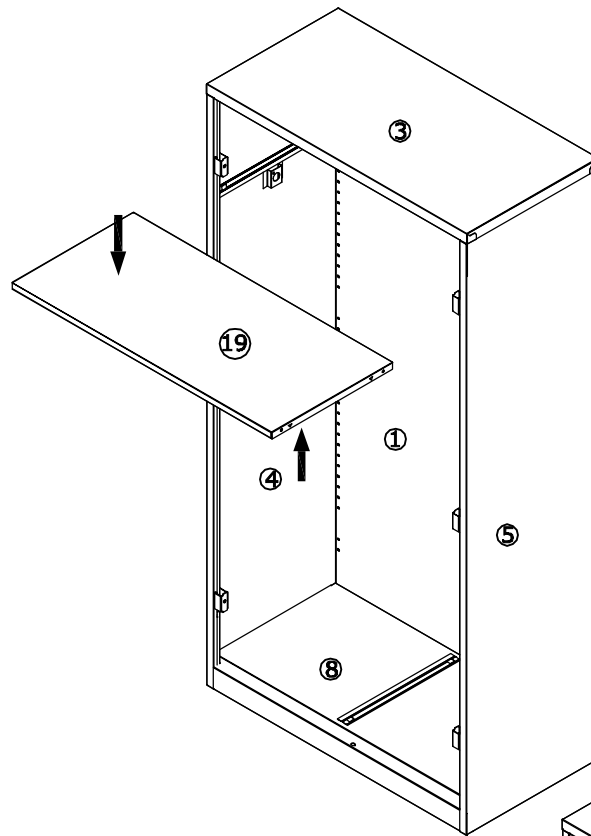

**FIX THE FIX SHELF ASSEMBLY PER SHOWN . AND ENSURE THE PROPER LOCKING OF LANCINGS**

**STEP: 8**

**PARTITION PANEL ASSEMBLY**

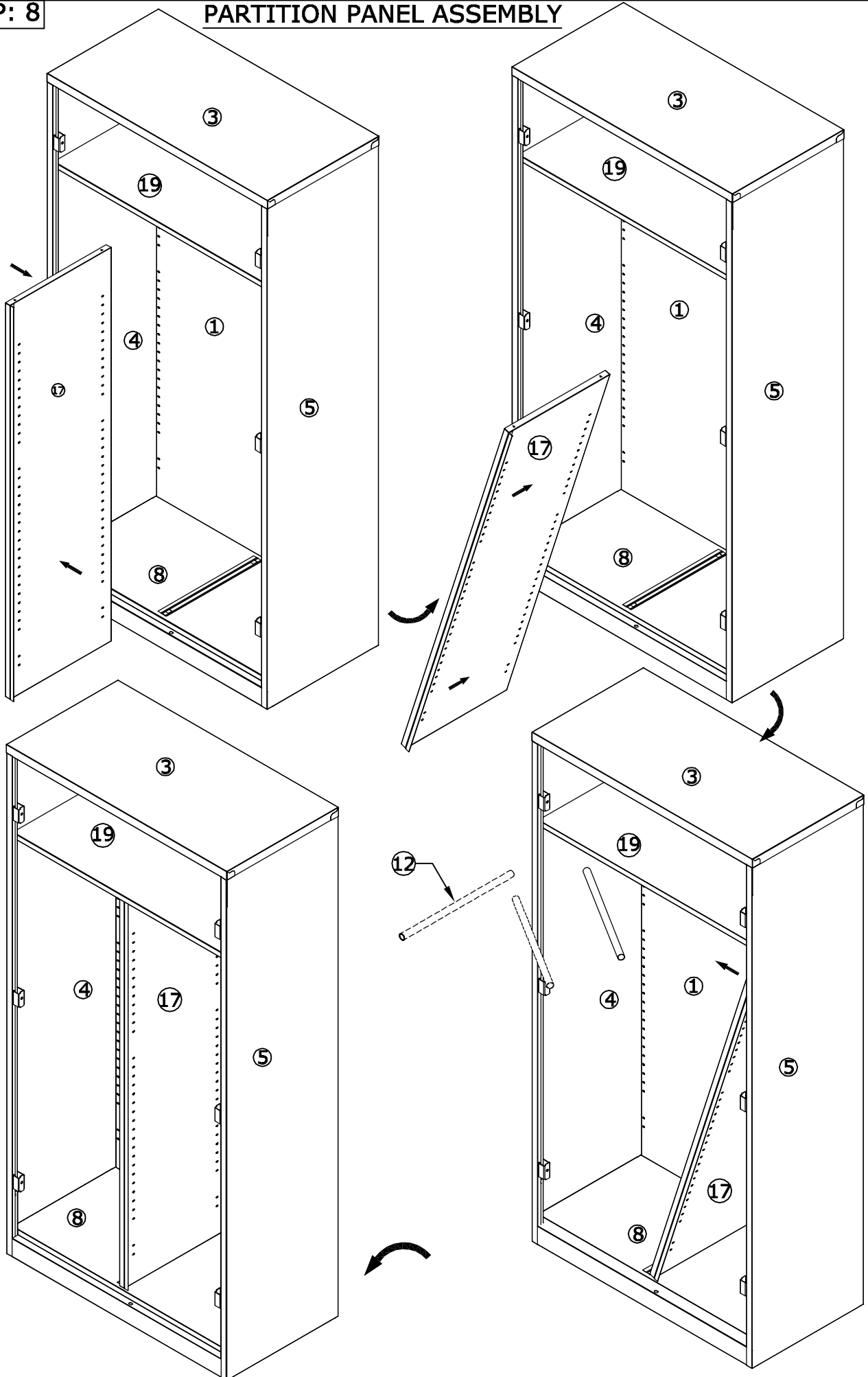

**FIX THE PARTITION PANEL AND HANGING ROD AS PER SHOWN . AND ENSURE THE PROPER LOCKING OF TOP AND BOTTOM LANCINGS**

**STEP:8A**

**SHELF SUPPORTING BRACKET ASSEMBLY**

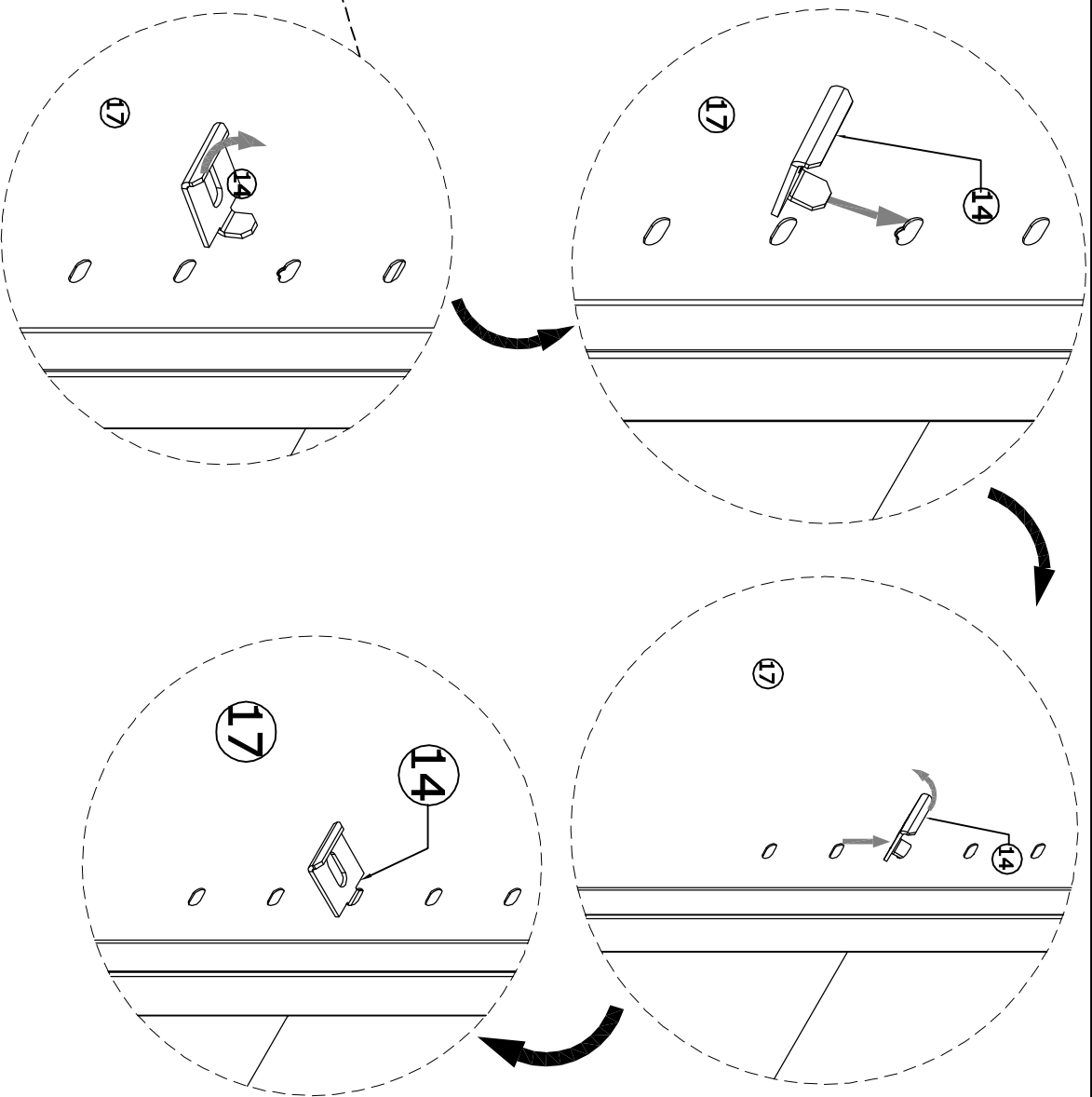
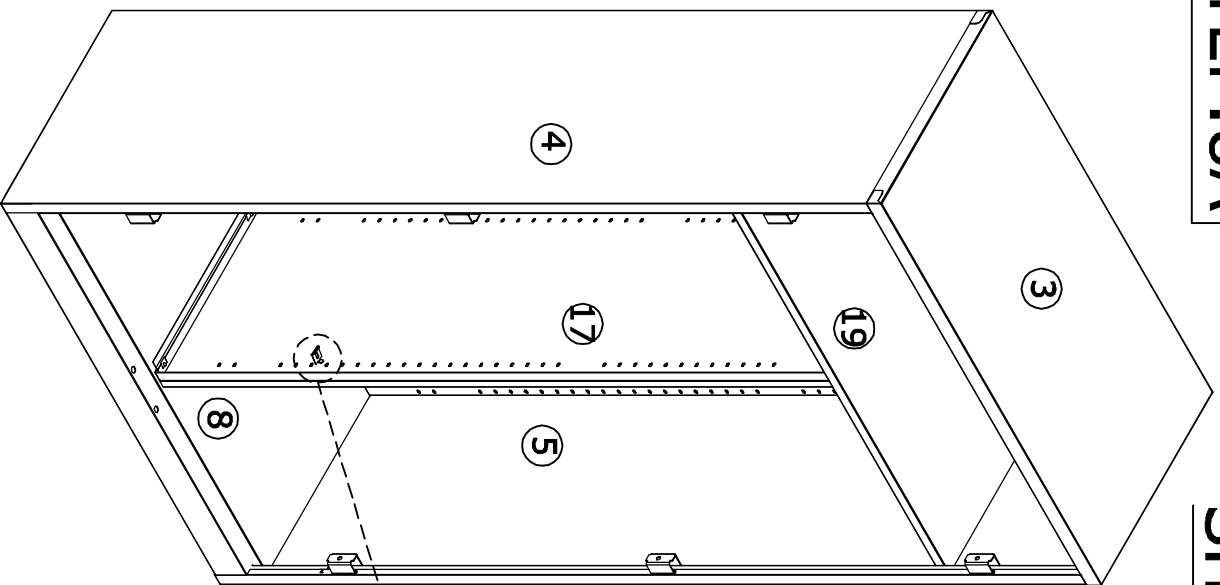

**INSERT THE SHELF SUPPORTING BRACKET AS PER SHOWN. AND ENSURE PROPER SETTING.**

**STEP:9**

**SHELF PANEL ASSEMBLY**

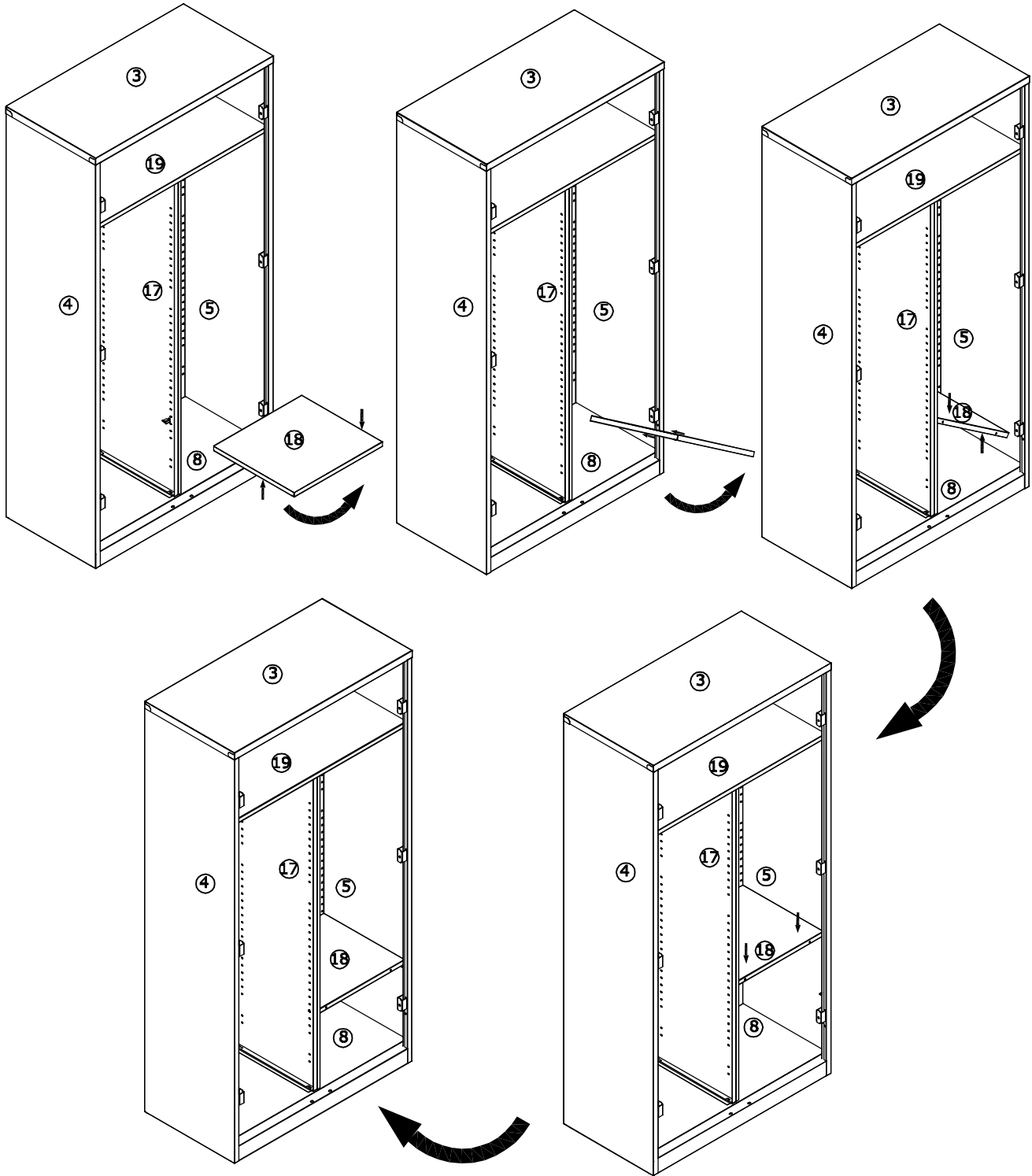

**FIX THE SHELF PANEL AS PER SHOWN.  
AND ENSURE PROPER SETTING.  
FIX THE ALL SHELF SAME PROCEDURE.**

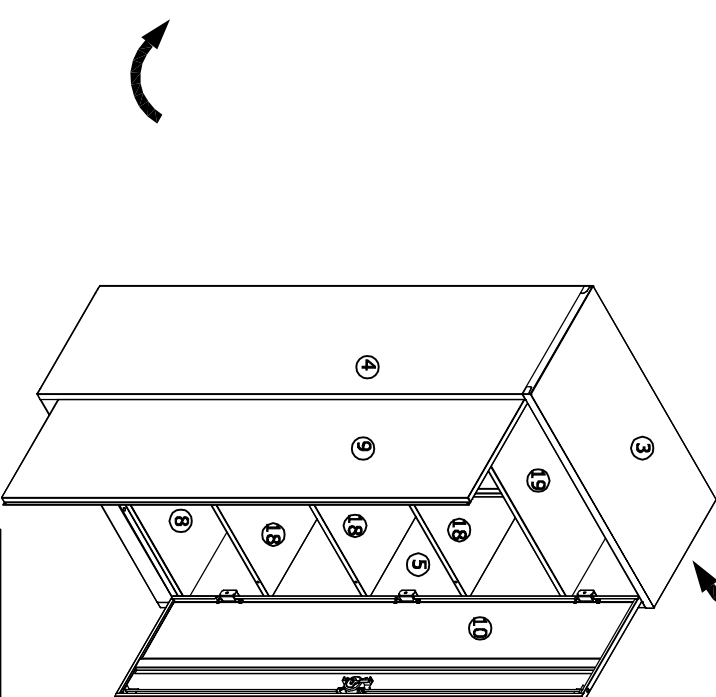
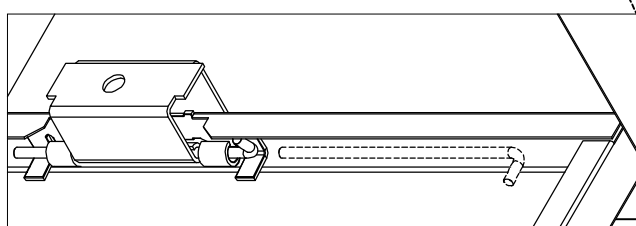
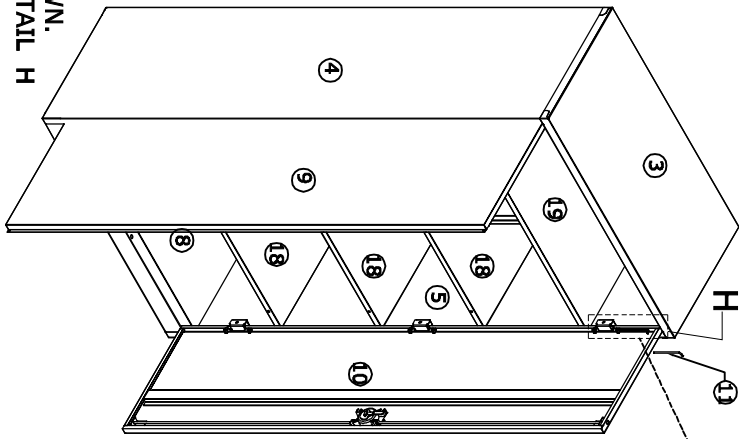
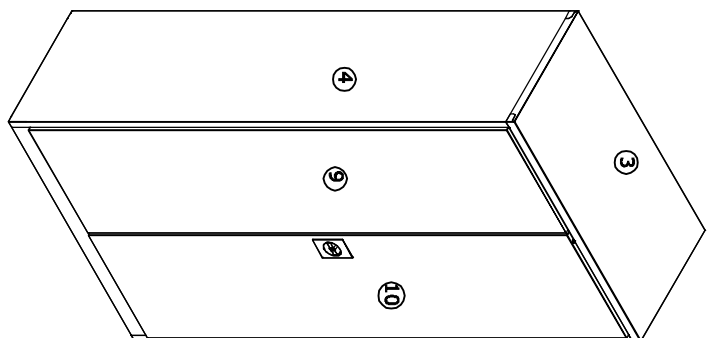
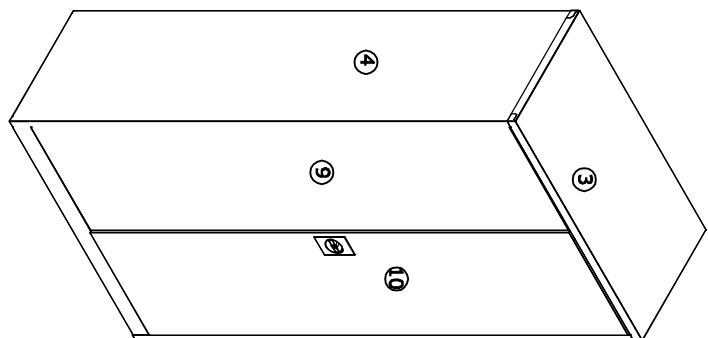
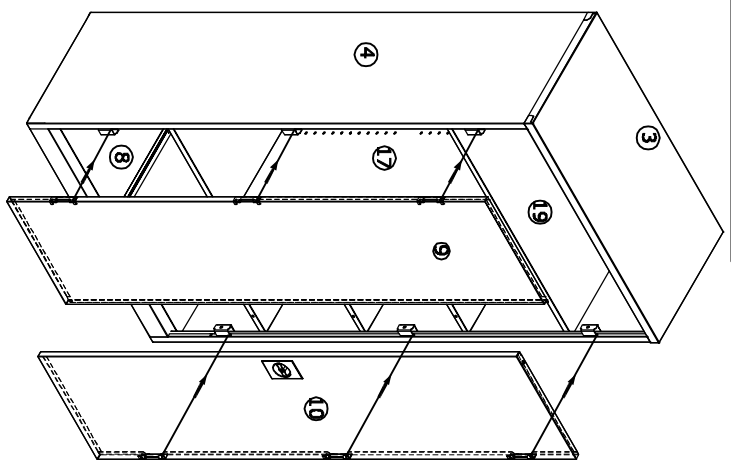

FIX THE BOTH DOOR AS PER SHOWN.  
INSERT THE HINGE PIN AS PER DETAIL. H

**STEP: 1 BACK (LH) & BACK (RH) ASSEMBLY**

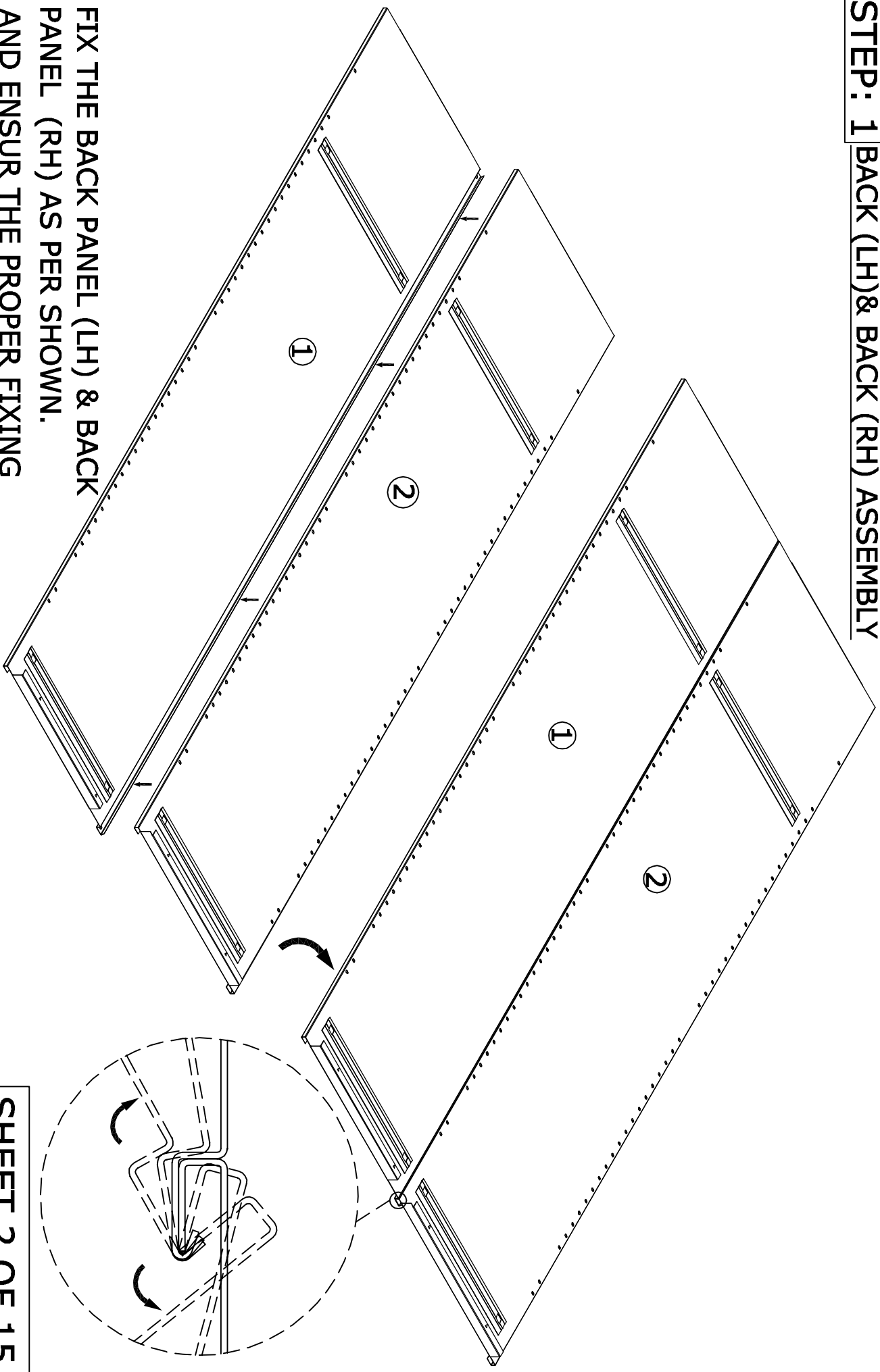

**FIX THE BACK PANEL (LH) & BACK  
PANEL (RH) AS PER SHOWN.  
AND ENSUR THE PROPER FIXING**

**STEP: 2**

**BACK WITH TOP ASSEMBLY**

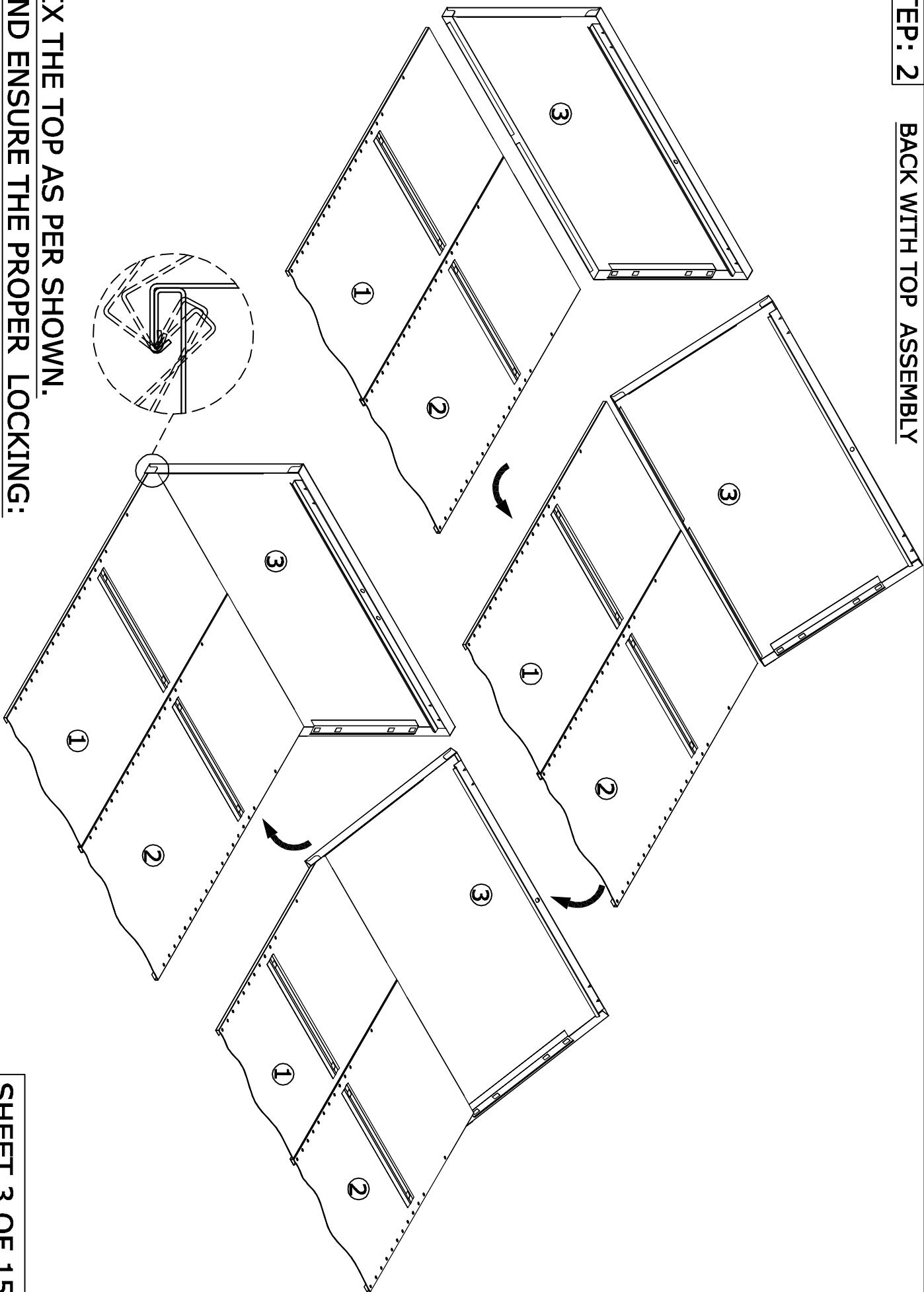

**FIX THE TOP AS PER SHOWN.  
AND ENSURE THE PROPER LOCKING:**

**STEP:2A**

**TOP WITH 'L' PIECE ASSEMBLY**

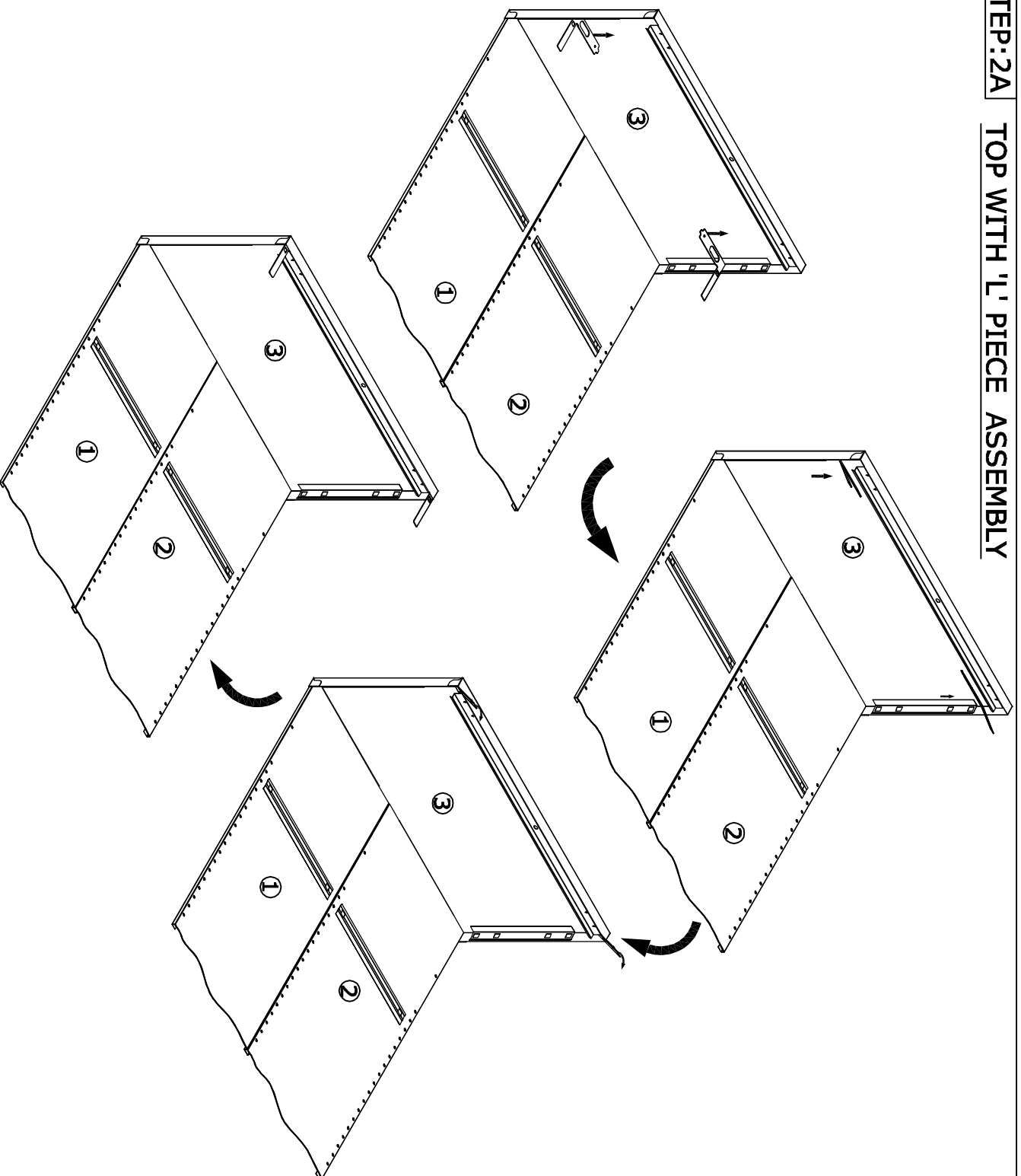

**FIX THE 'L' PIECE AS PER SHOWN  
AND ENSURE THE PROPER LOCKING OF LANCESING**

**STEP : 3**

**SIDE PANEL ASSEMBLY**

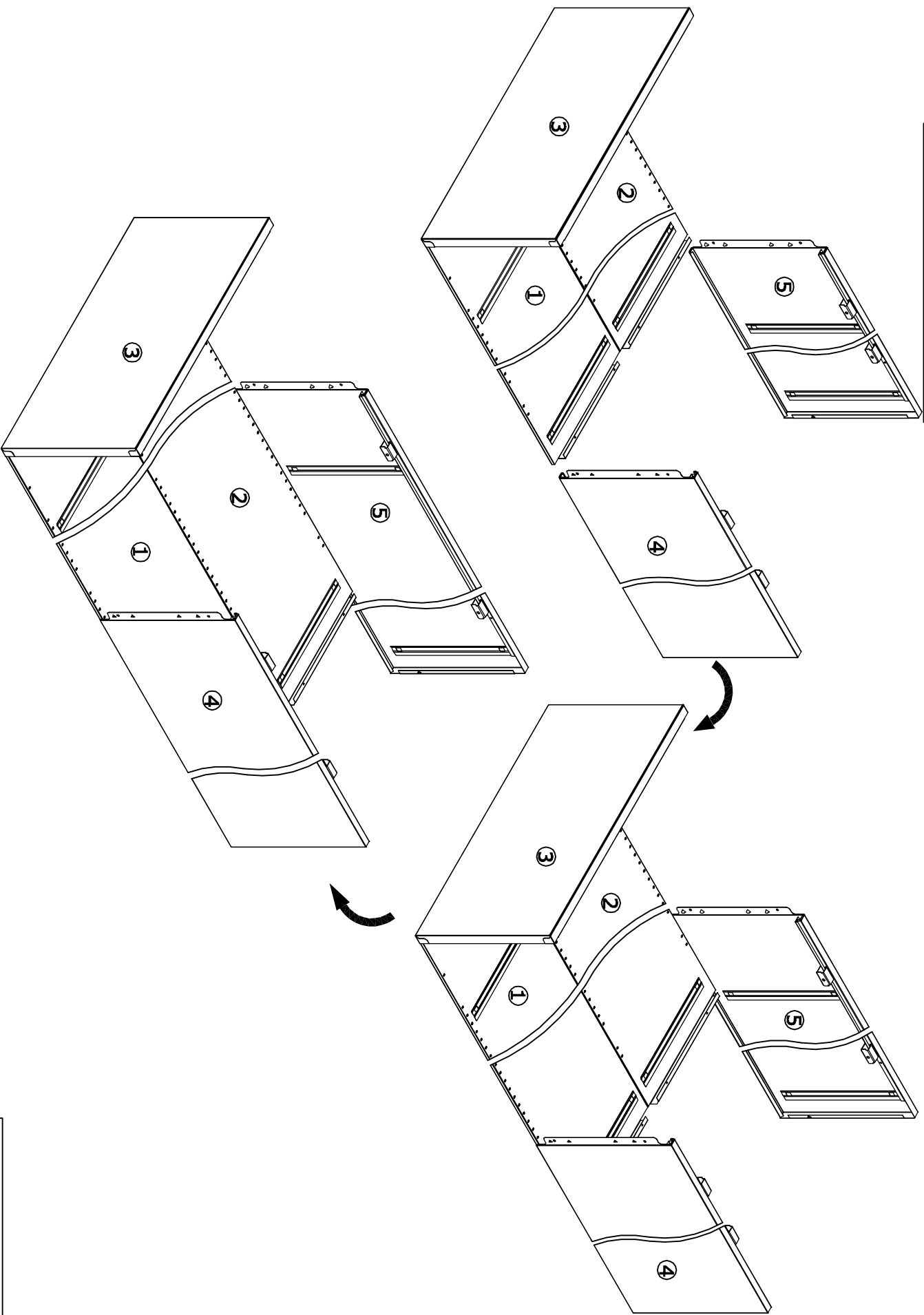

**FIX THE SIDE PANEL AS PER SHOWN.**

FRONT FRAME ASSEMBLY

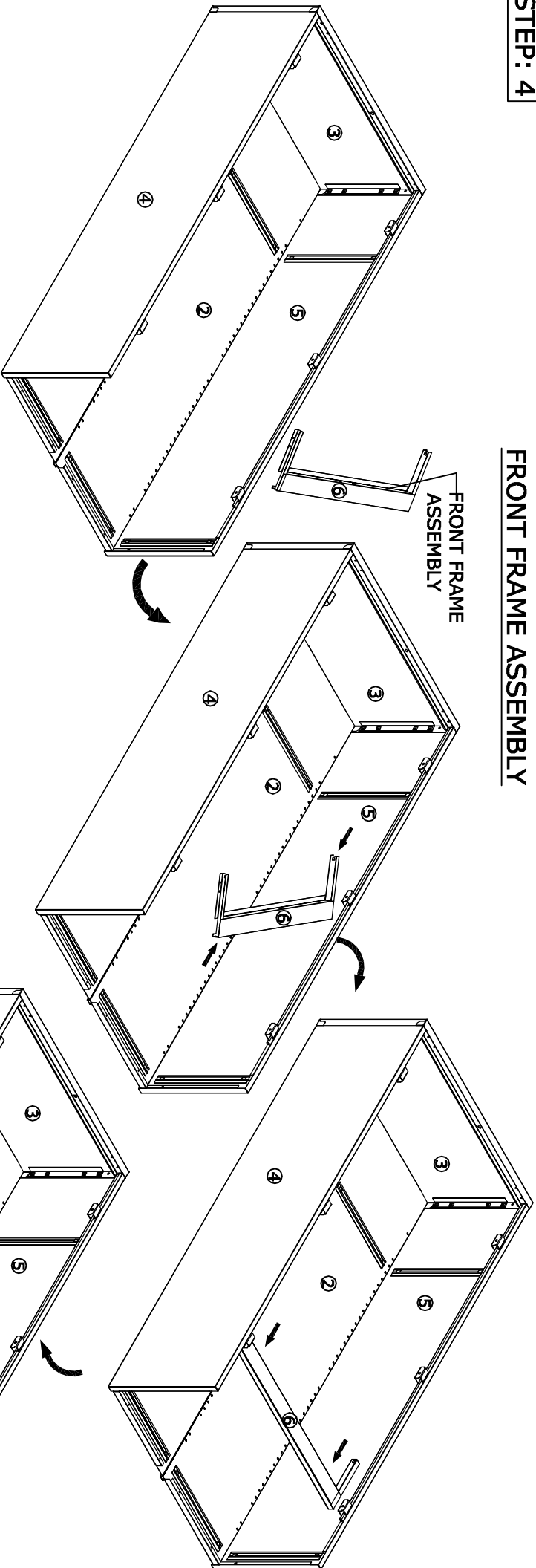

INSERT THE FRONT FRAME ASSEMBLY  
AND FIX THE AS PER SHOWN

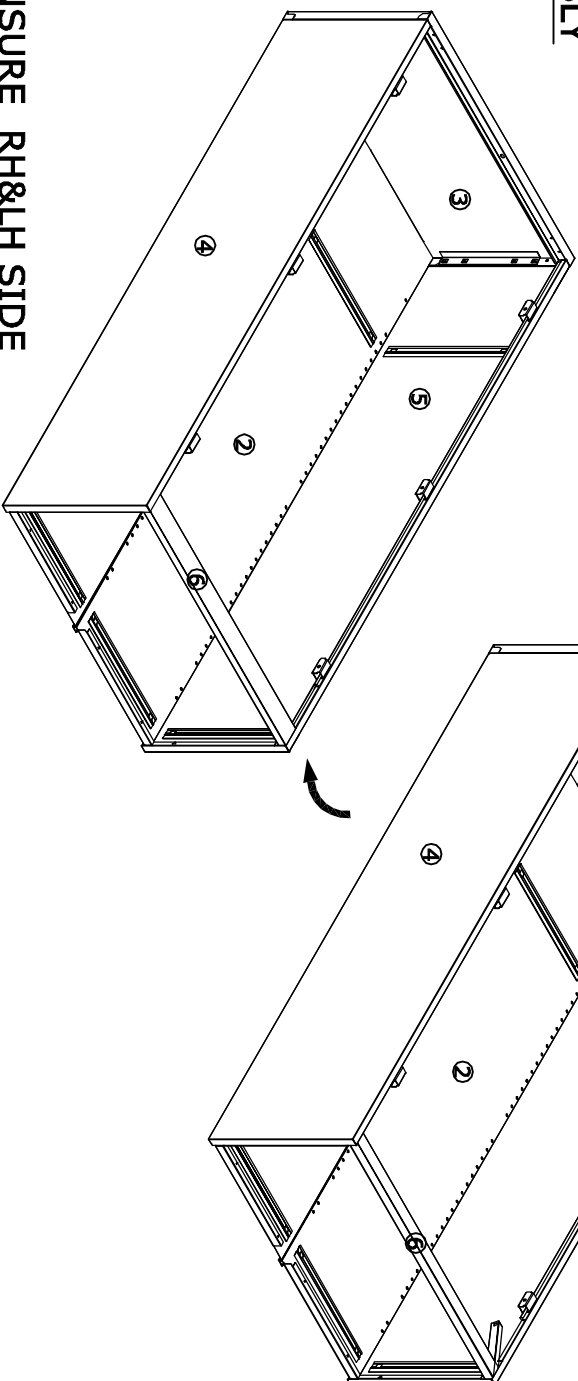

AFTER FIXING FRONT FRAME, AND ENSURE RH&LH SIDE  
PANEL FRONT LANCINGS ARE HELD BY SLOTS

STEP: 5

BACK FRAME ASSEMBLY

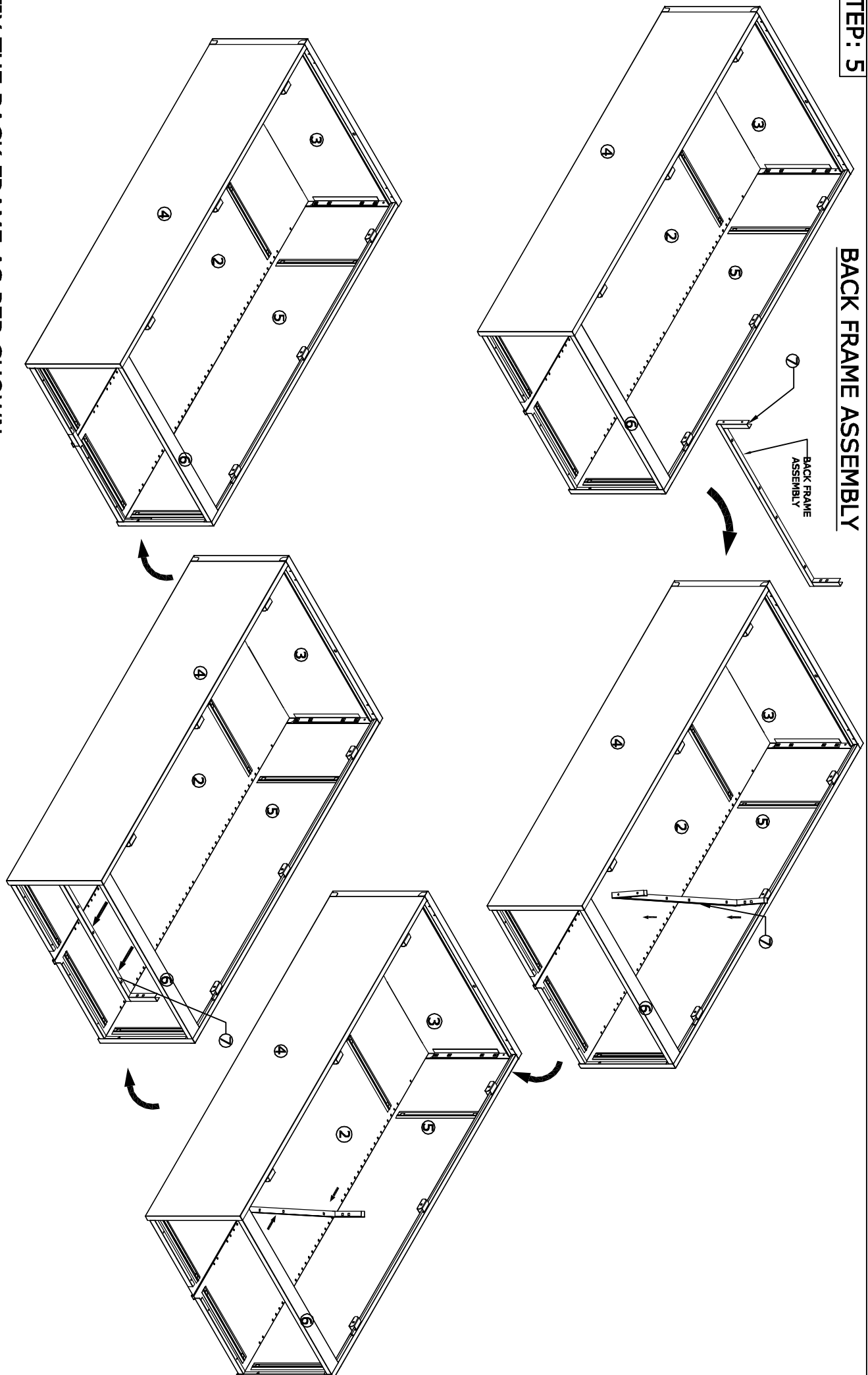

FIX THE BACK FRAME AS PER SHOWN.  
ENSURE RH&LH SIDE PANEL FRONT LANCESING ARE HELD BY SLOTS.

BOTTOM PANEL ASSEMBLY

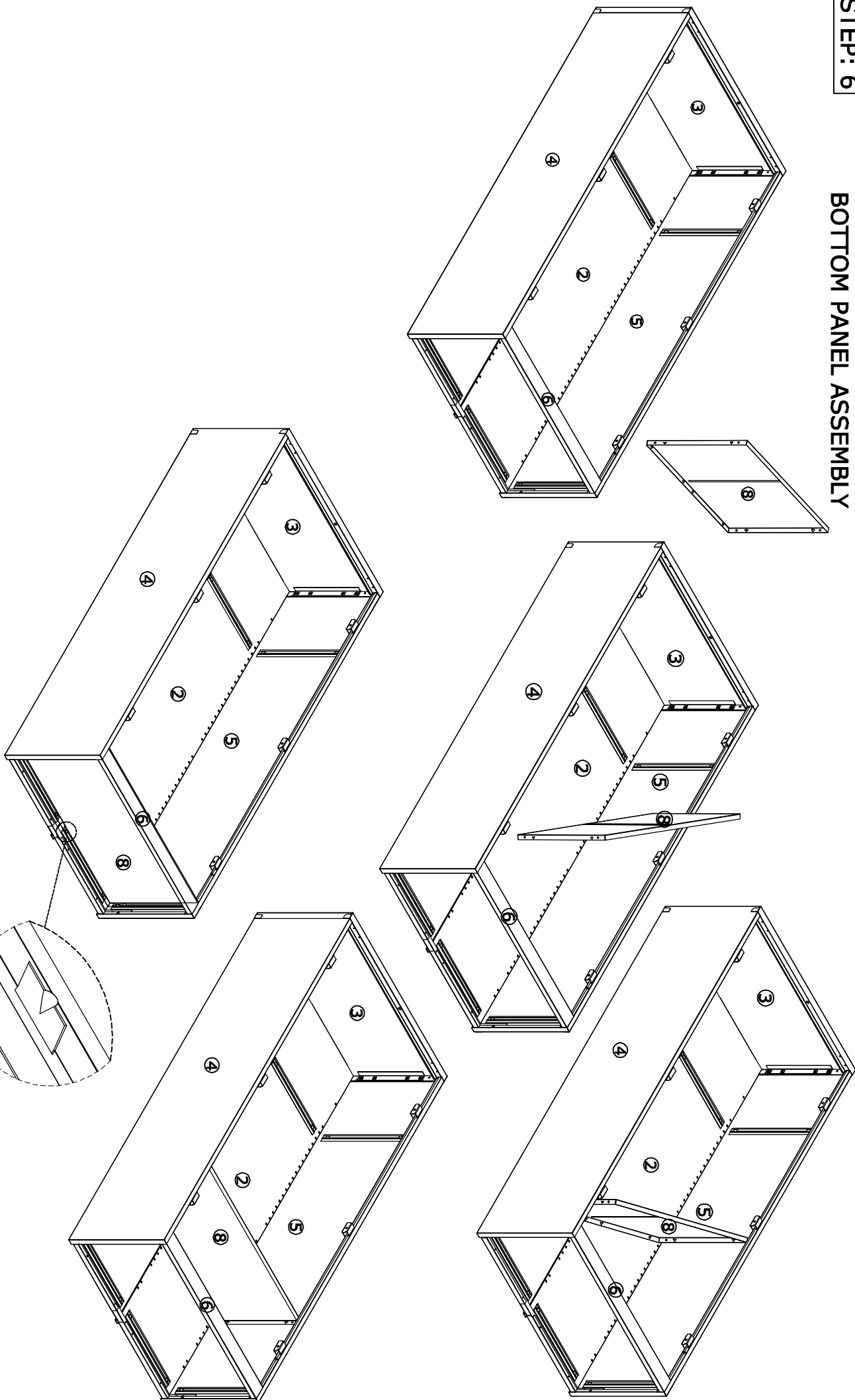

**FIX THE BOTTOM PANEL AS PER SHOWN . AND ENSURE THE PROPER LOCKING OF LANCINGS AS PER DETAIL A**

**DETAIL - A**

**STEP:10 DOOR WITH LOCK & SHOOTING BOLT ASSEMBLY**

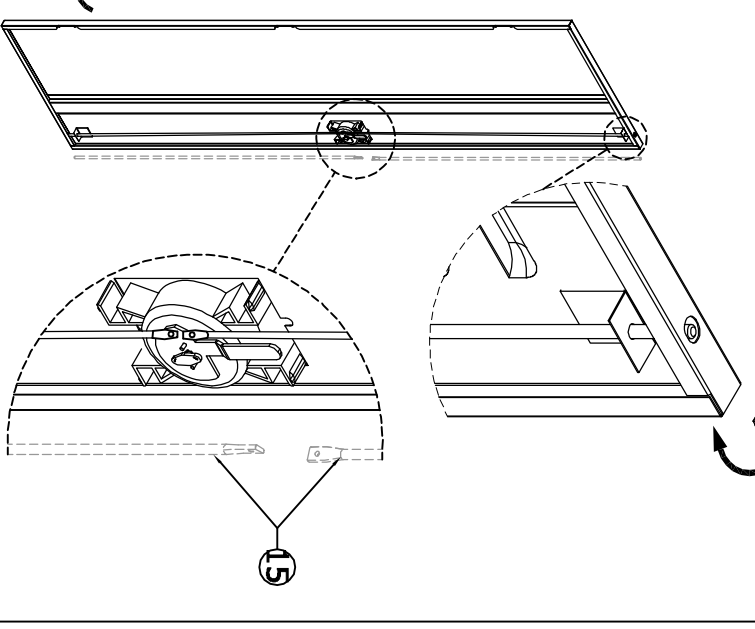
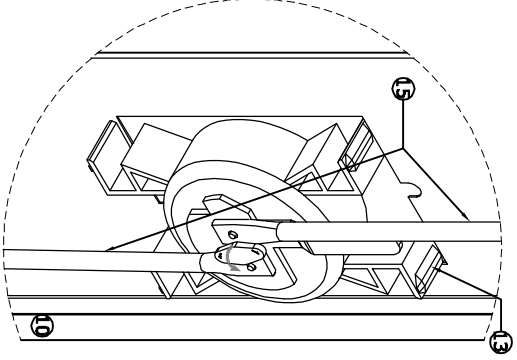
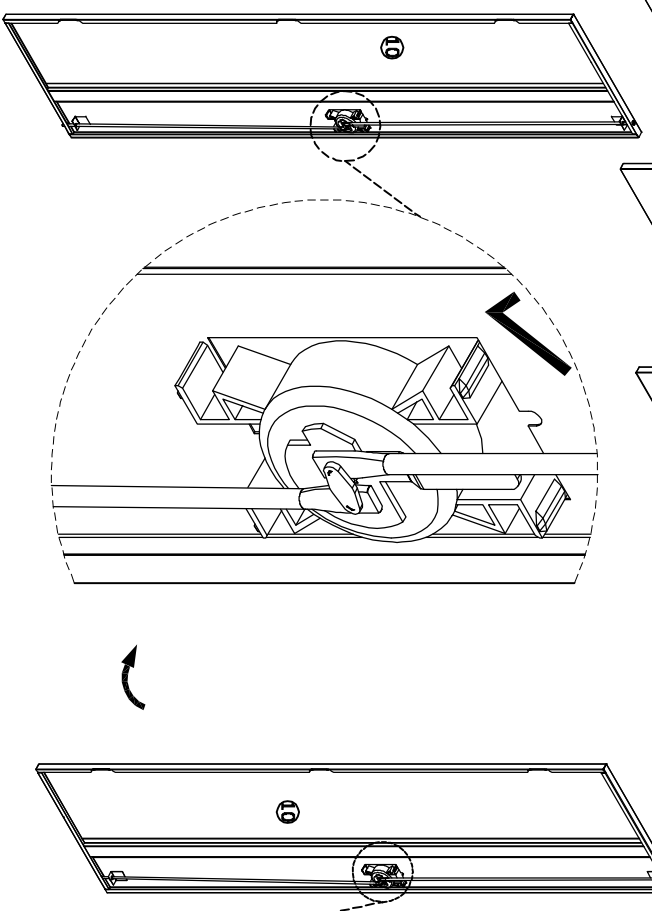
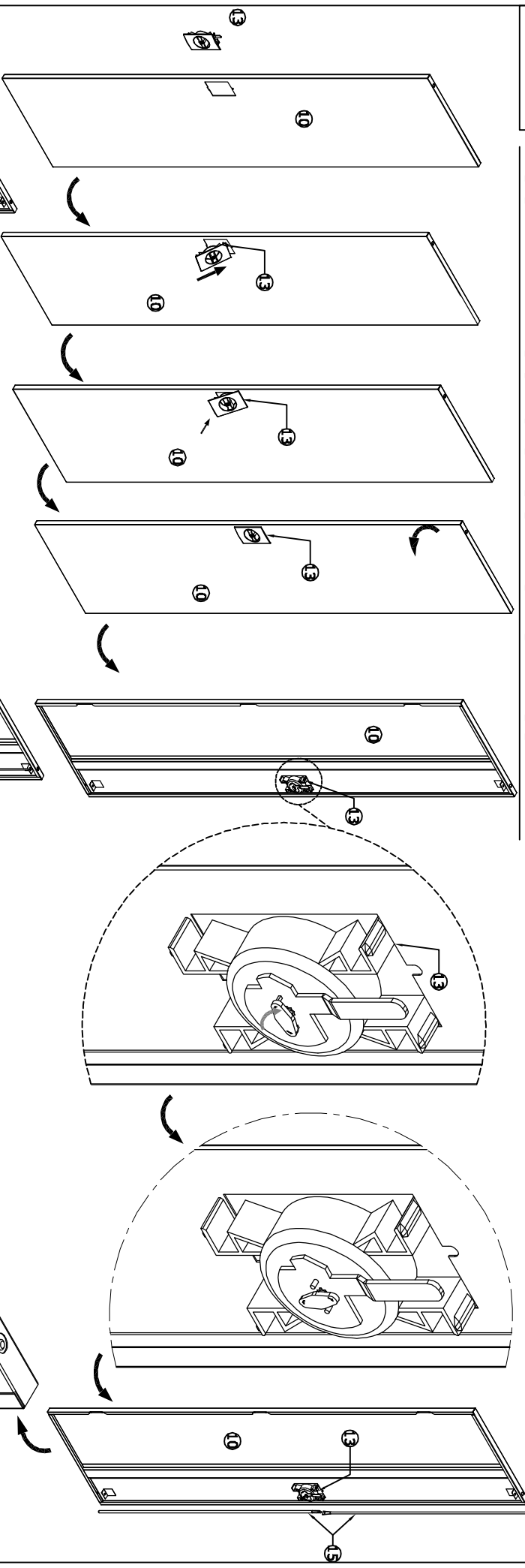

**FIX THE DOOR LOCK & SHOOTING BOLT AS PER SHOWN AND ENSUR PROPER LOCKING ON LOCKING PIN**

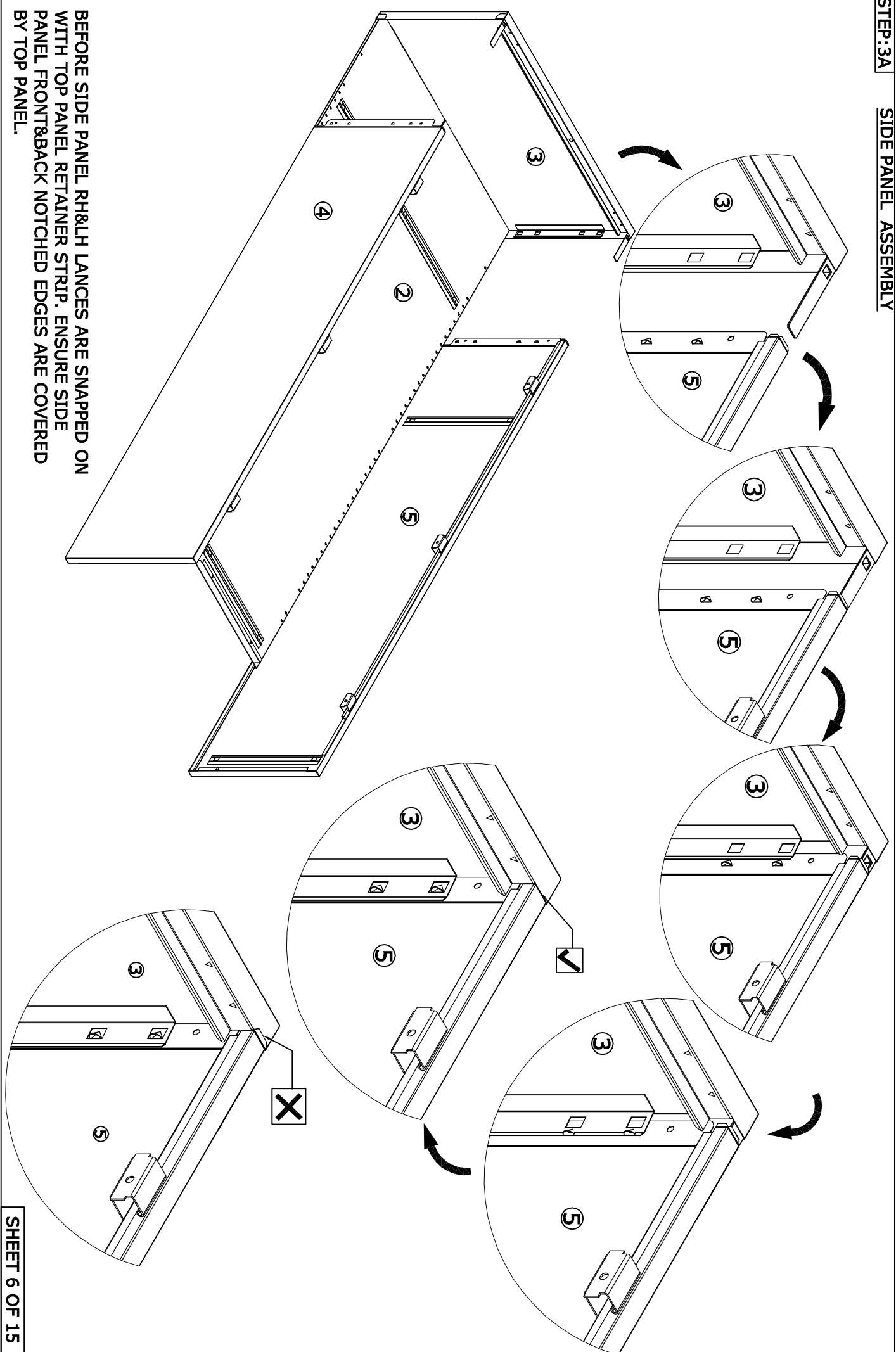

BEFORE SIDE PANEL RH&LH LANCES ARE SNAPPED ON WITH TOP PANEL RETAINER STRIP. ENSURE SIDE PANEL FRONT&BACK NOTCHED EDGES ARE COVERED BY TOP PANEL.