

# ASSEMBLY INSTRUCTIONS FOR FULL HEIGHT GLASS SWING DOOR CUPBOARD

\* PLEASE STUDY THE ASSEMBLY INSTRUCTIONS CAREFULLY & FAMILIARIZE YOURSELF WITH THE PARTS BEFORE ASSEMBLY.

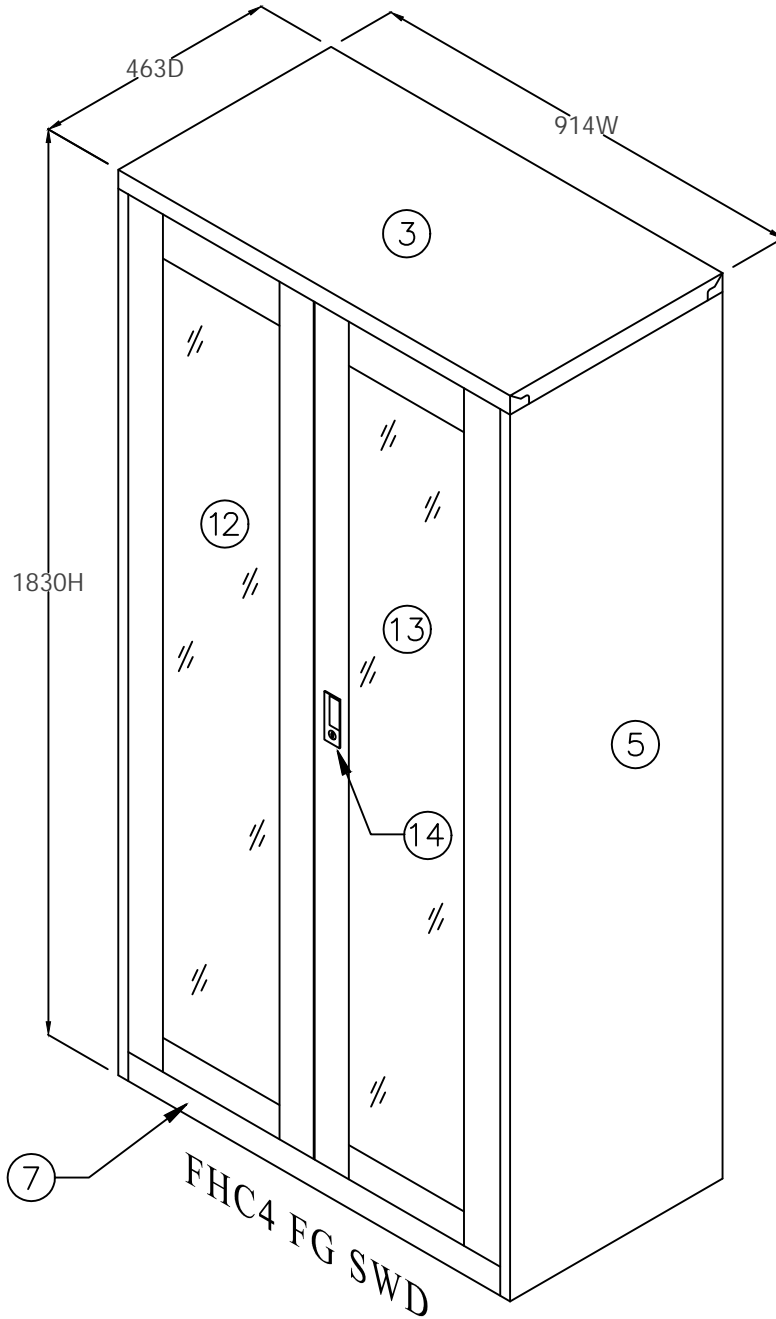

## HARDWARE

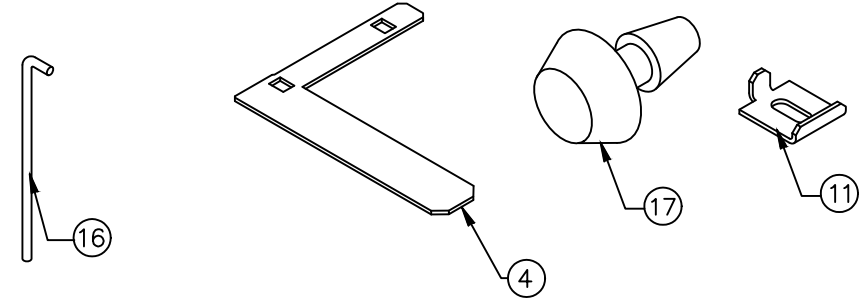

## Part List

Part No.	Description	Qty. (FHC4)
1	R. H. Back panel	1
2	L. H. Back panel	1
3	Top panel	1
4	' L' Piece	2
5	R. H. Si de panel	1
6	L. H. Si de panel	1
7	Front frame assembly	1
8	Back frame assembly	1
9	Bottom panel	1
10	Shelf	4
11	Shelf support bracket	20
12	L. H. Door	1
13	R. H. Door	1
14	Handle cum lock with 2way cam	1
15	Shooting bolt	2
16	Hinge pin	6
17	Banger	4

STEP : 1

BACK PANEL RH&LH JOINING

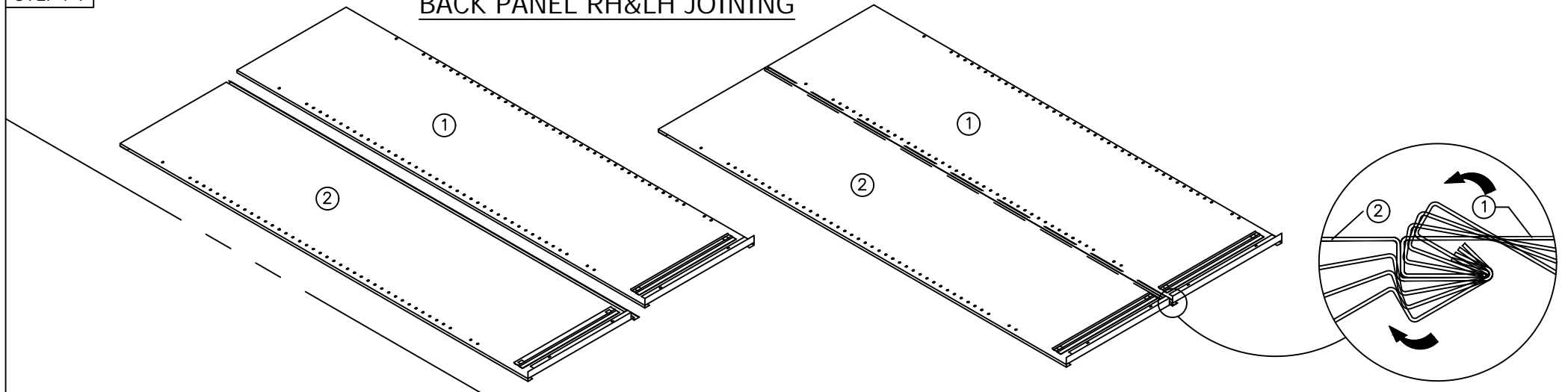

STEP : 2

TOP PANEL INSERTION

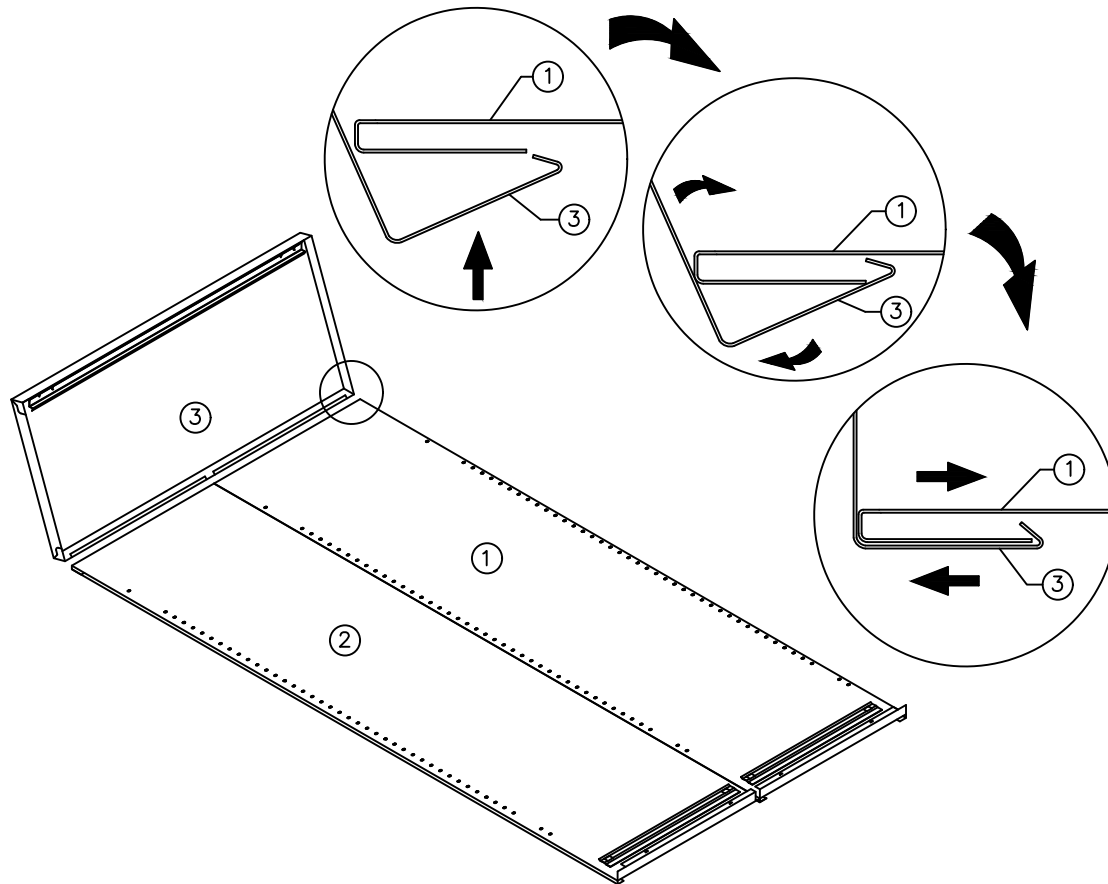

STEP : 3

LOCATING THE CORNER STRENGTHENING PIECE IN THE TOP PANEL

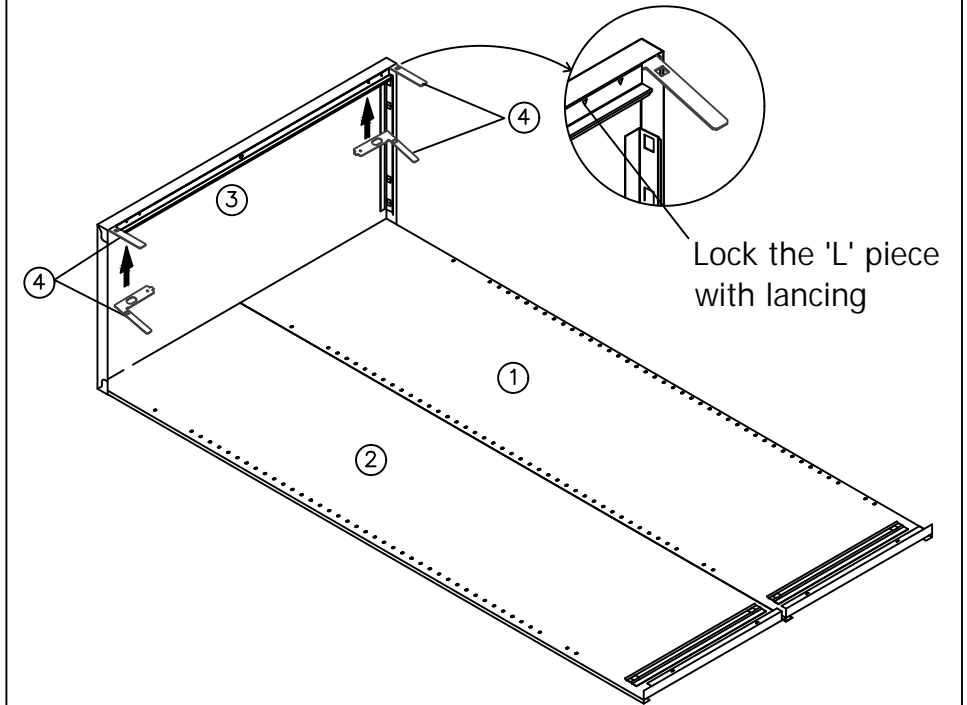

STEP : 4A

## SIDE PANEL INSERTION

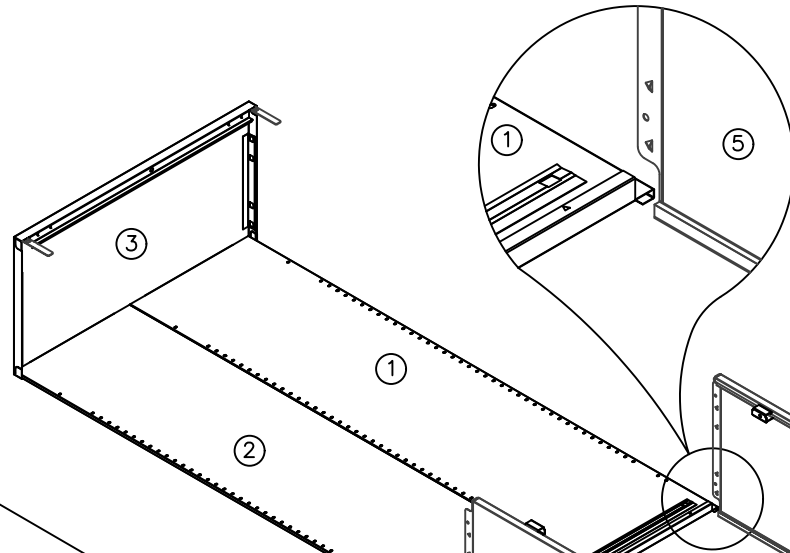

Insert the side panel RH & LH into the back panel as shown.

Then slide the side RH & LH till it connects the 'L' piece.

STEP : 4B

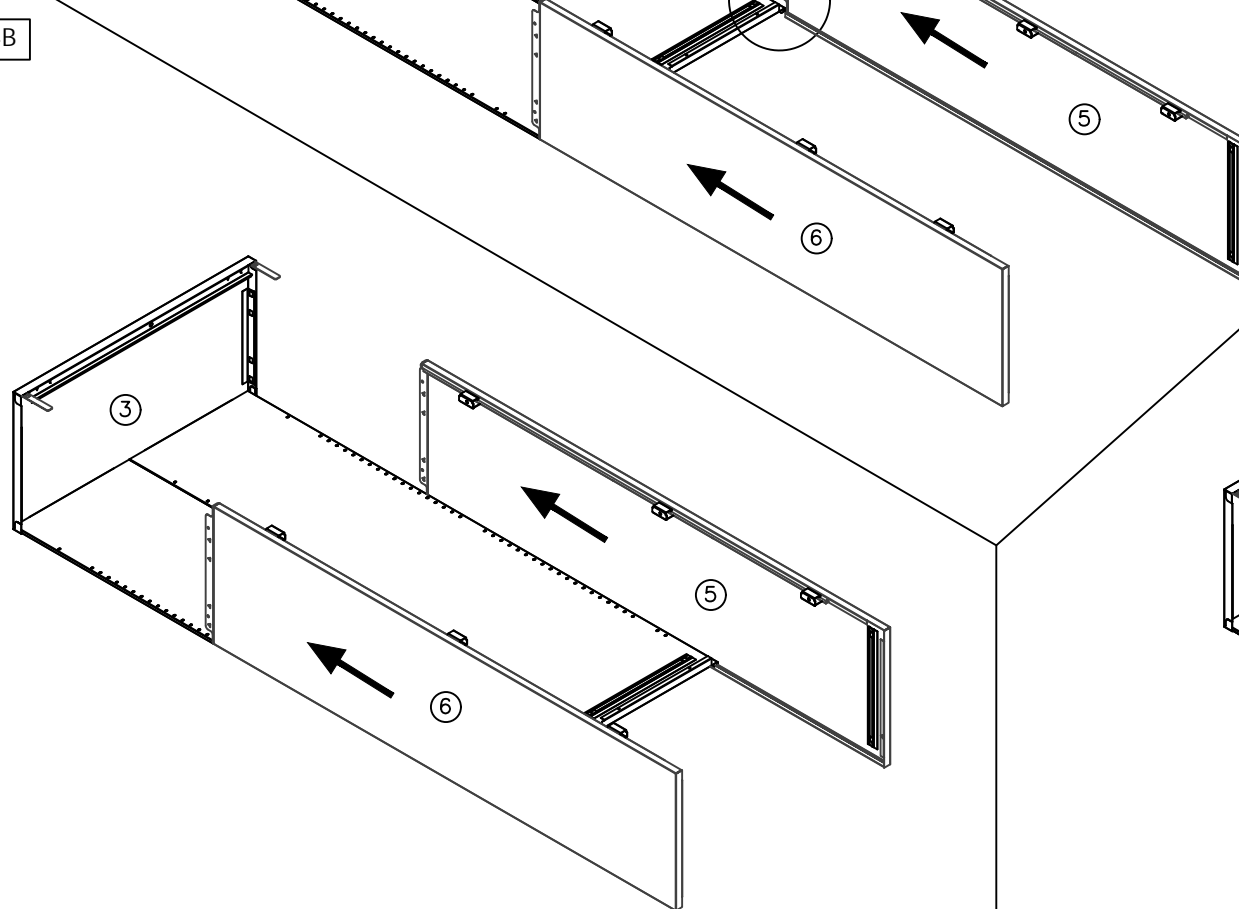

STEP : 4C

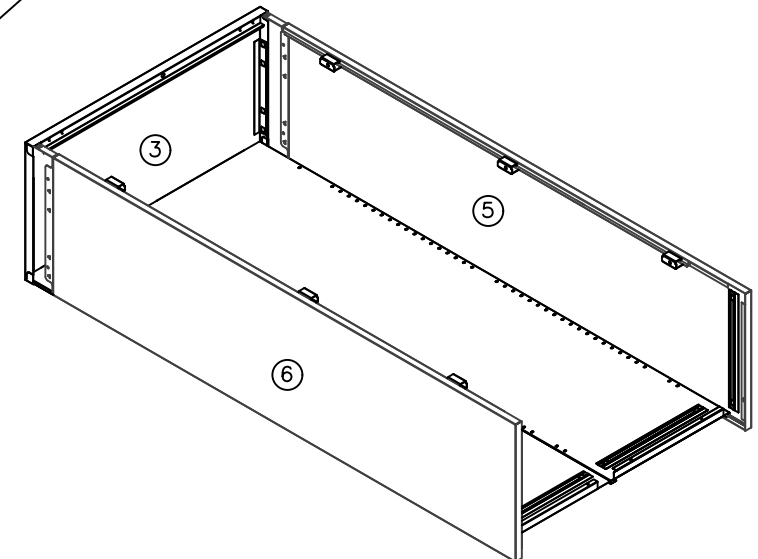

## SIDE PANEL INSERTION

Before the lancements are engaged with top retainers, ensure the side panel front & rear fold profiled edges are covered by top panel.

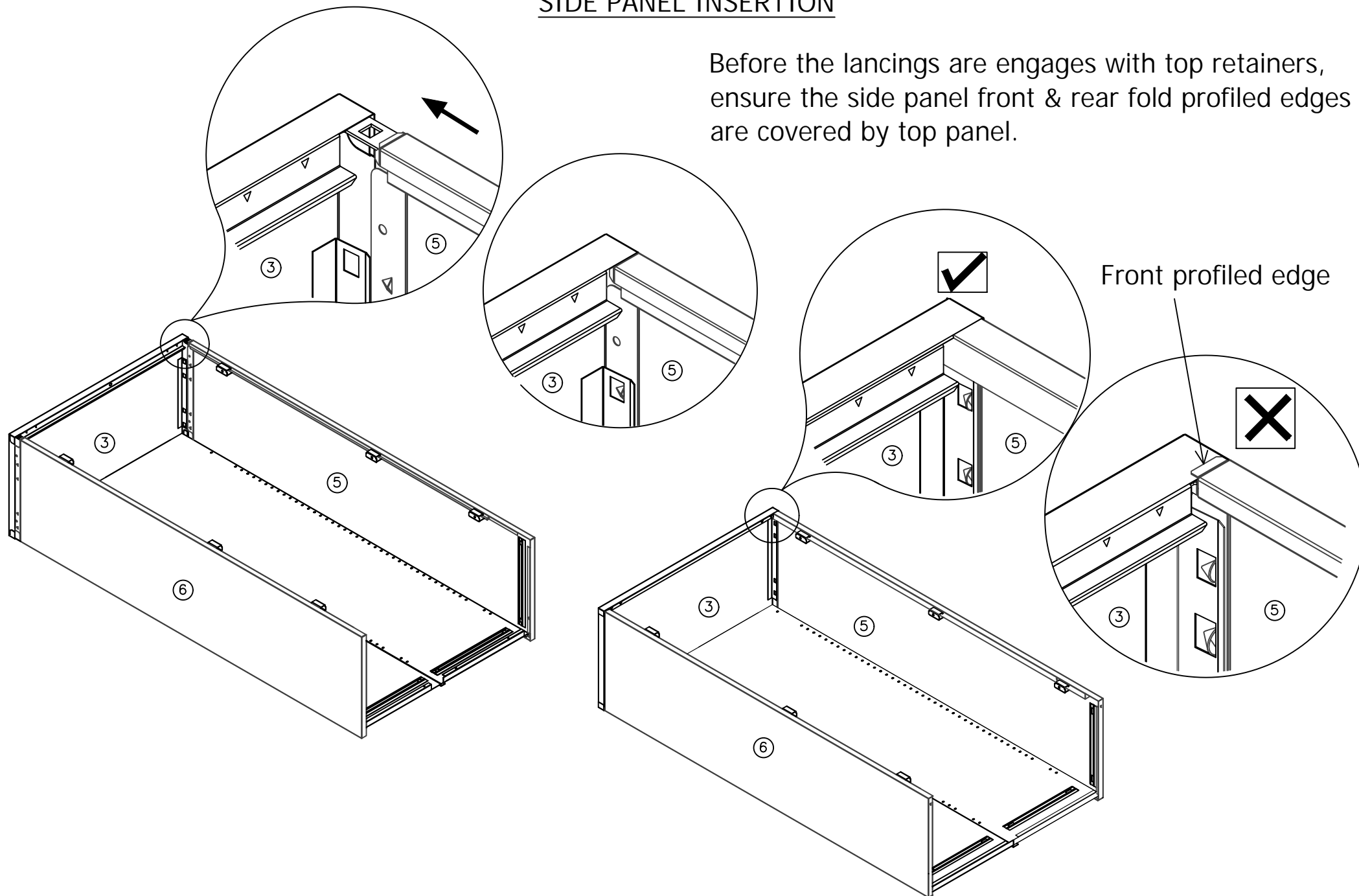

# FRONT FRAME INSERTION

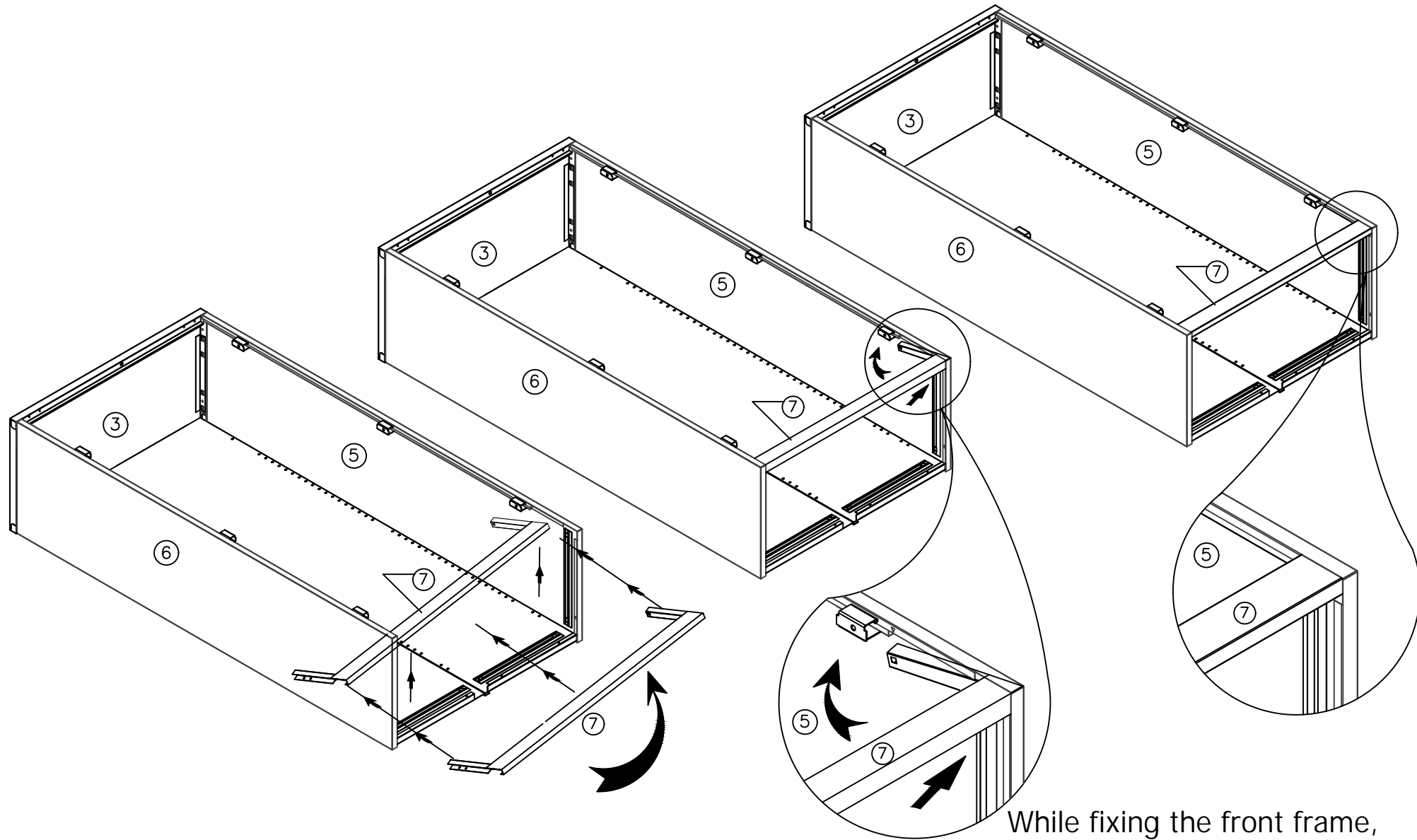

While fixing the front frame, ensure side panels front fold lancing's are engage with the front frame slots.

STEP : 7

### BACK FRAME INSERTION

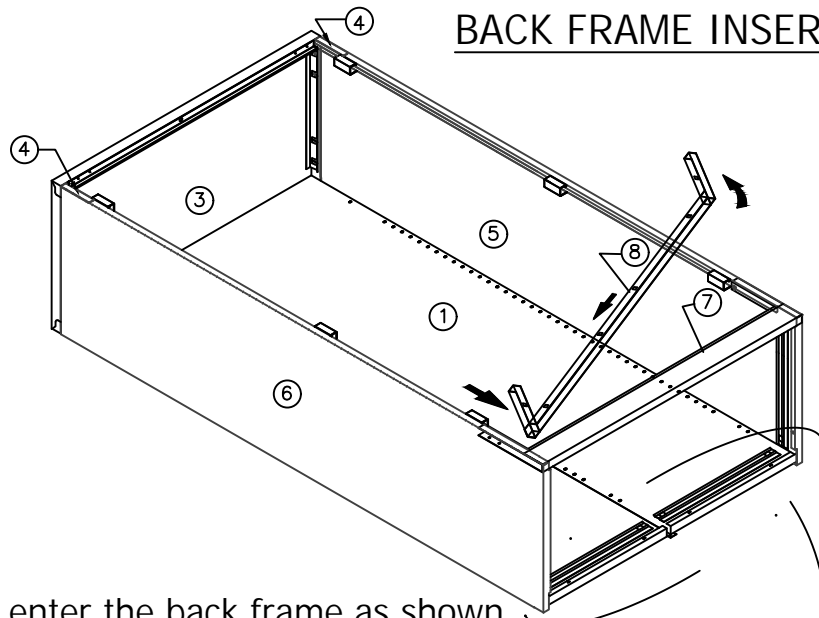

Tilt and enter the back frame as shown and insert into the side & back folds.

While fixing back frame, ensure the side panels and back panels bottom fold lancing's are engage with the back frame slots.

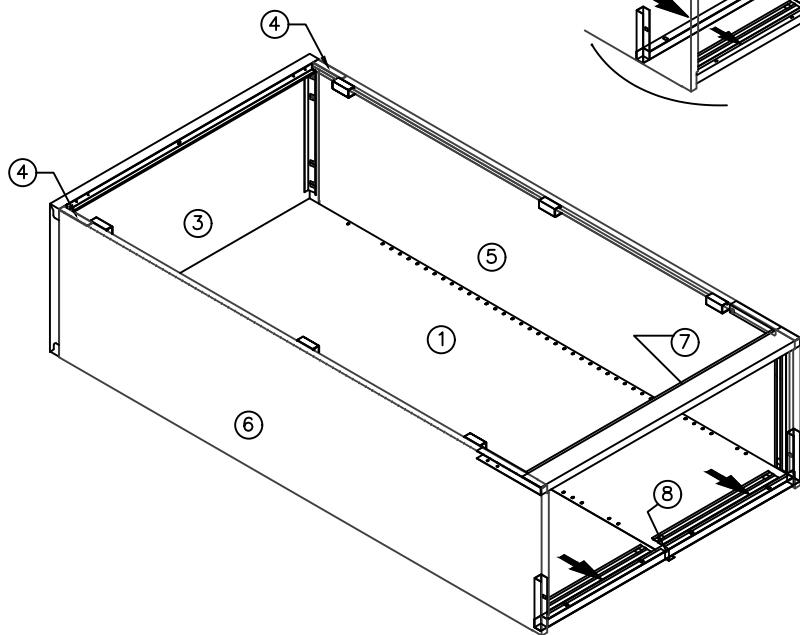
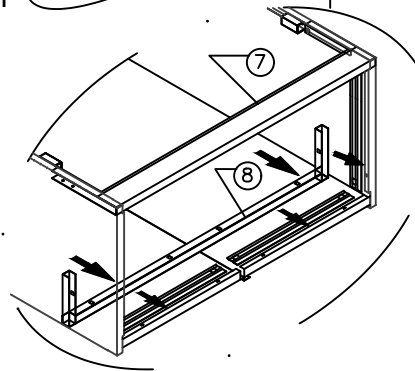

STEP : 8

### BOTTOM PANEL FIXING

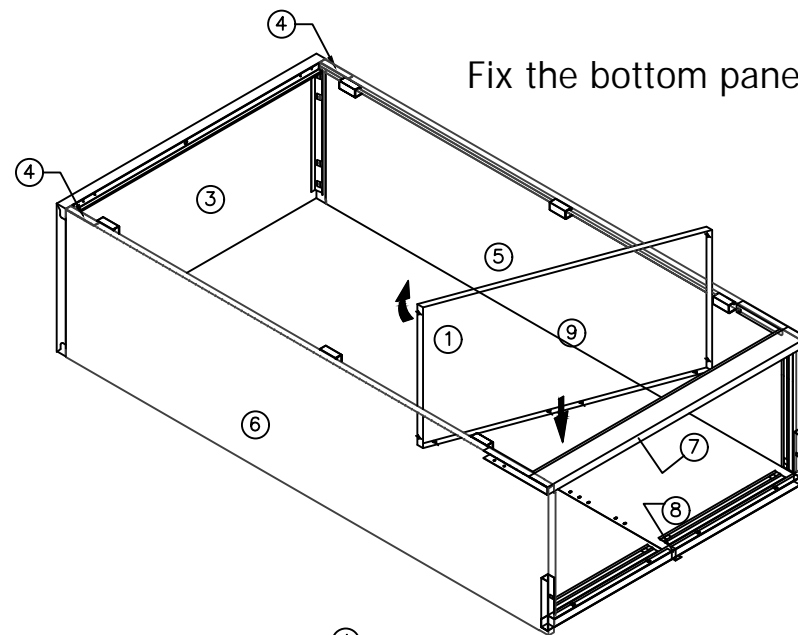

Fix the bottom panel as shown.

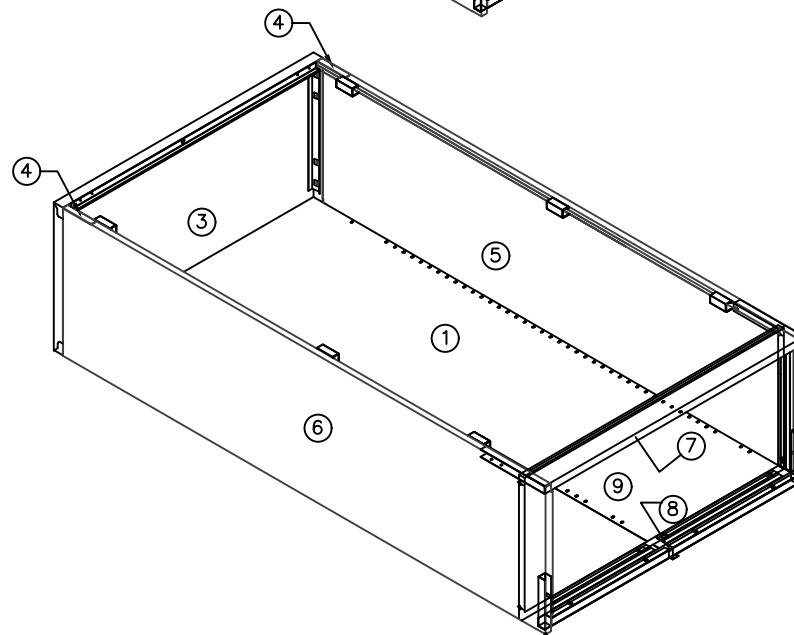

### DOOR FIXING

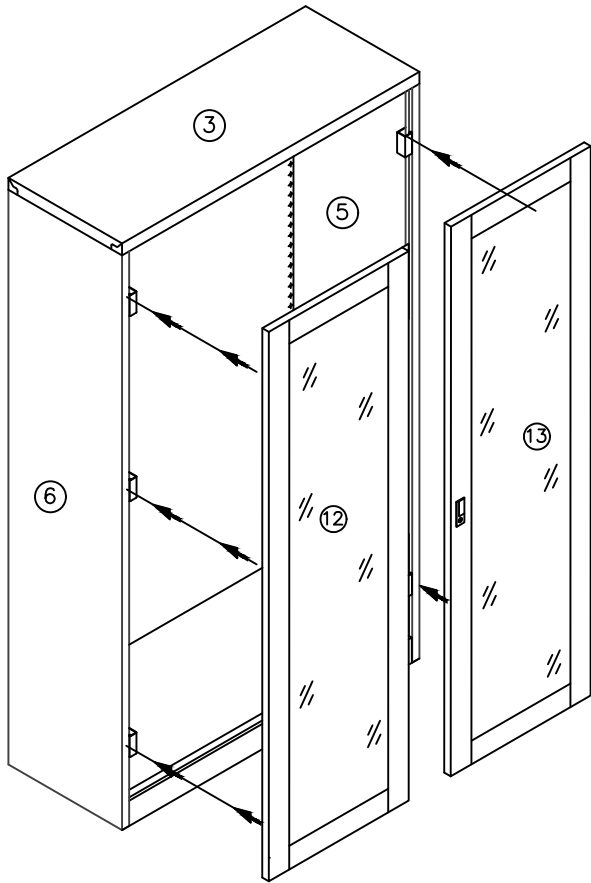

Hold the door in closed position and align the door hinges with the side hinges, then push inside to fix.

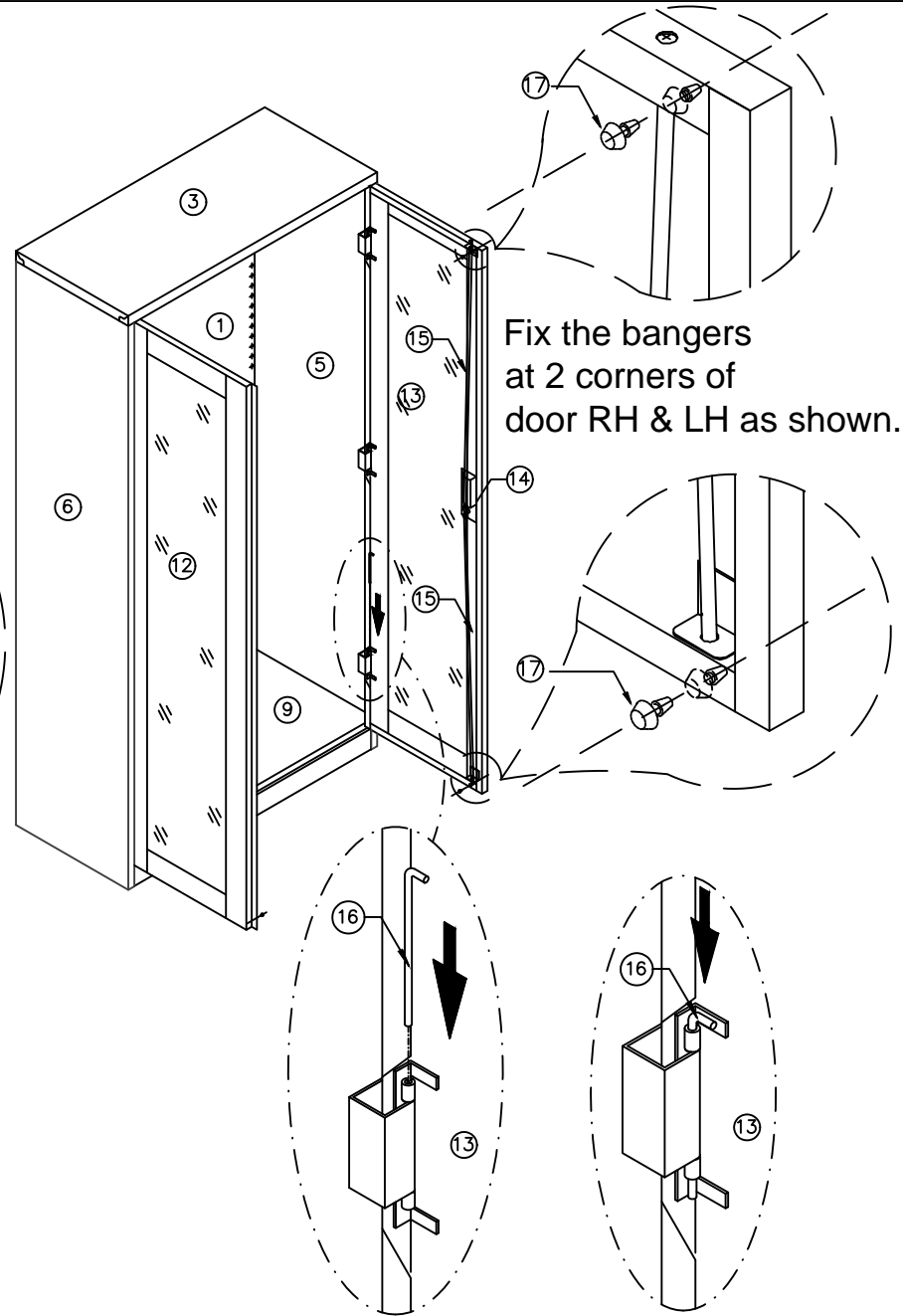
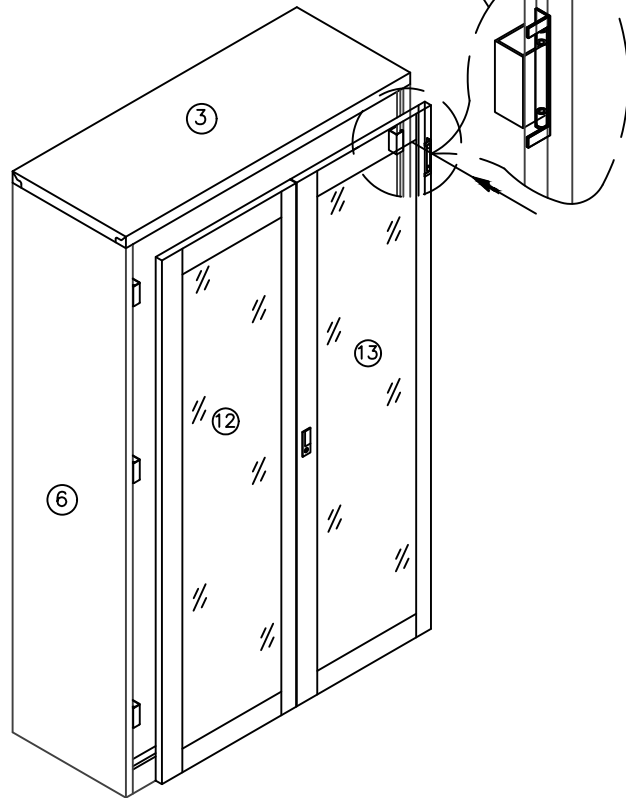

Fix the bangers at 2 corners of door RH & LH as shown.

# SHELF PANEL FIXING

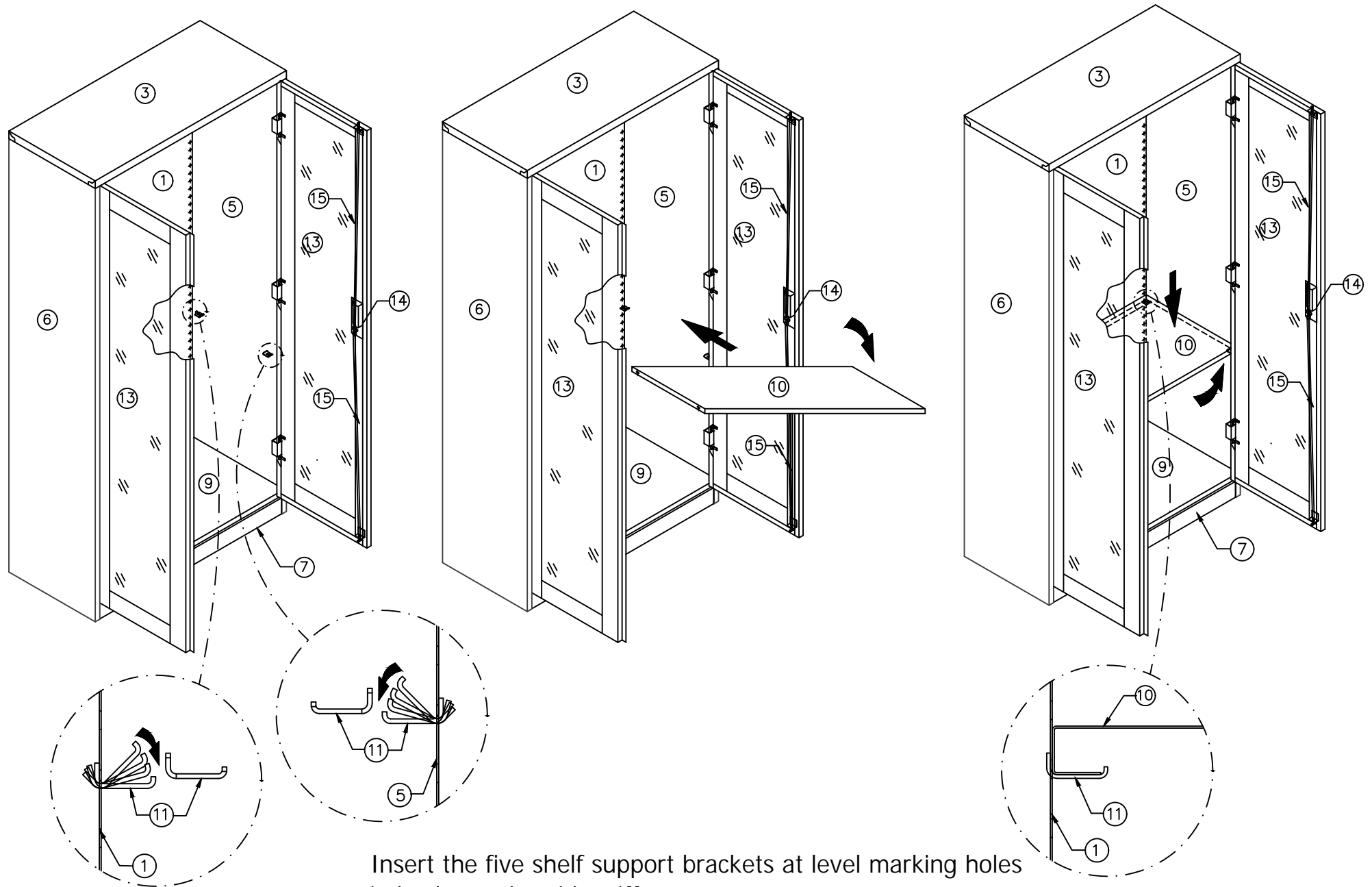

Insert the five shelf support brackets at level marking holes in back panel & side stiffener.

Place the shelf on shelf supports.