

# ASSEMBLY INSTRUCTIONS FOR COMBINATION SWING DOOR CUPBOARD

- \* PLEASE STUDY THE ASSEMBLY INSTRUCTIONS CAREFULLY & FAMILIARISE YOURSELF WITH THE PARTS BEFORE ASSEMBLY
- \* TOOLS REQUIRED : SCREW DRIVER, POP RIVET MACHINE & SOFT HAMMER.
- \* ENSURE THAT ALL THE ITEMS LISTED IN PART LIST ARE PRESENT BEFORE ASSEMBLY.

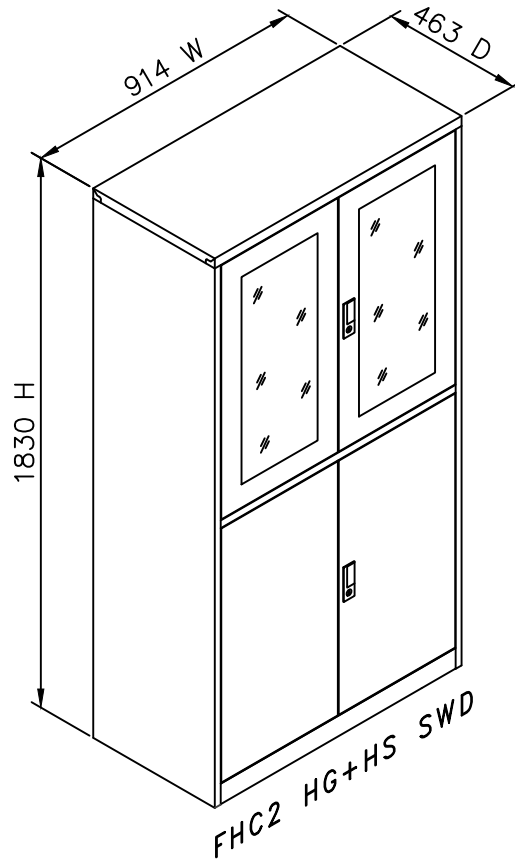

## PARTS LIST

PART NO.	DESCRIPTION	QTY.
1.	FHC2 HG + HS SWD - R.H. BACK PANEL	1
2.	FHC2 HG + HS SWD - L.H. BACK PANEL	1
3.	TOP PANEL	1
4.	CORNER STRENGTHENING PIECE	2
5.	FHC2 HG + HS SWD - R.H. SIDE PANEL	1
6.	FHC2 HG + HS SWD - L.H. SIDE PANEL	1
7.	FRONT FRAME ASSEMBLY	1
8.	BACK FRAME ASSEMBLY	1
9.	BOTTOM PANEL	1
10.	DEPTH REDUCED SHELF	2
11.	SHELF SUPPORT BRACKET	10
12.	MID BOTTOM	1
13.	MID FRAME	1
14.	L.H STEEL DOOR	1
15.	R.H STEEL DOOR	1
16.	L.H. GLASS DOOR	1
17.	R.H. GLASS DOOR	1
18.	HINGE PIN	8
19.	RIVET	2
20.	Handle cum lock with 2way cam	2

## HARDWARE

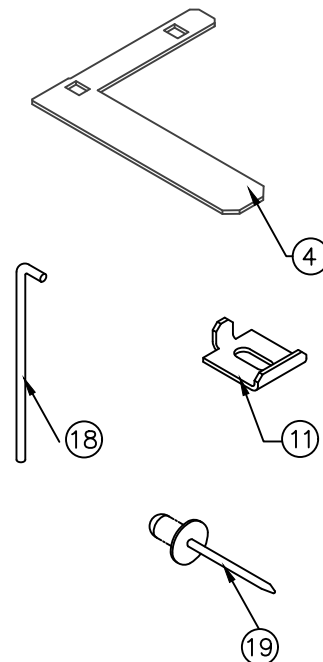

STEP : 1

BACK PANEL RH&LH JOINING

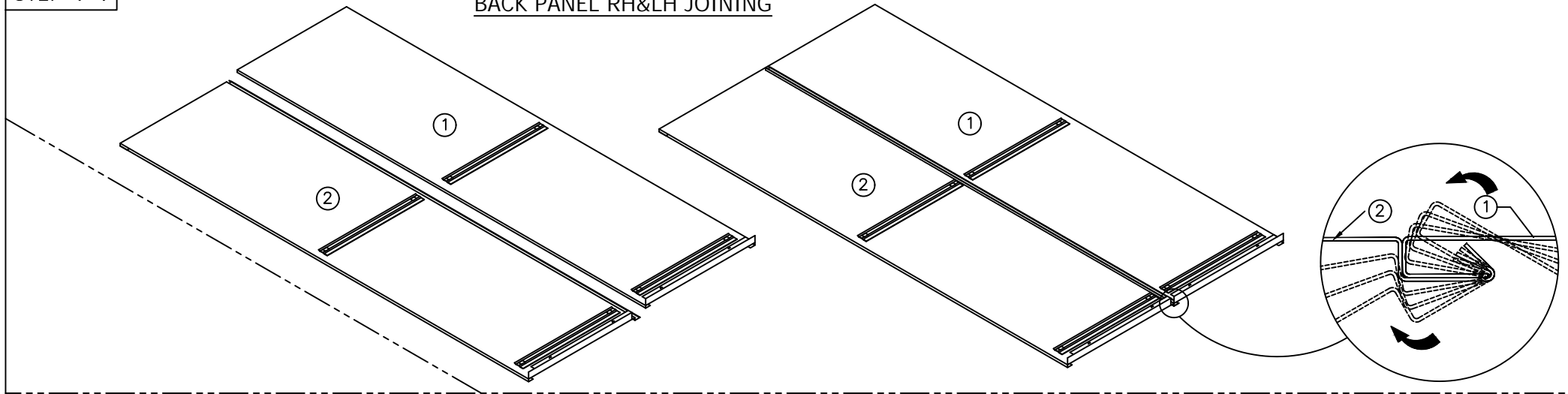

STEP : 2

TOP PANEL INSERTION

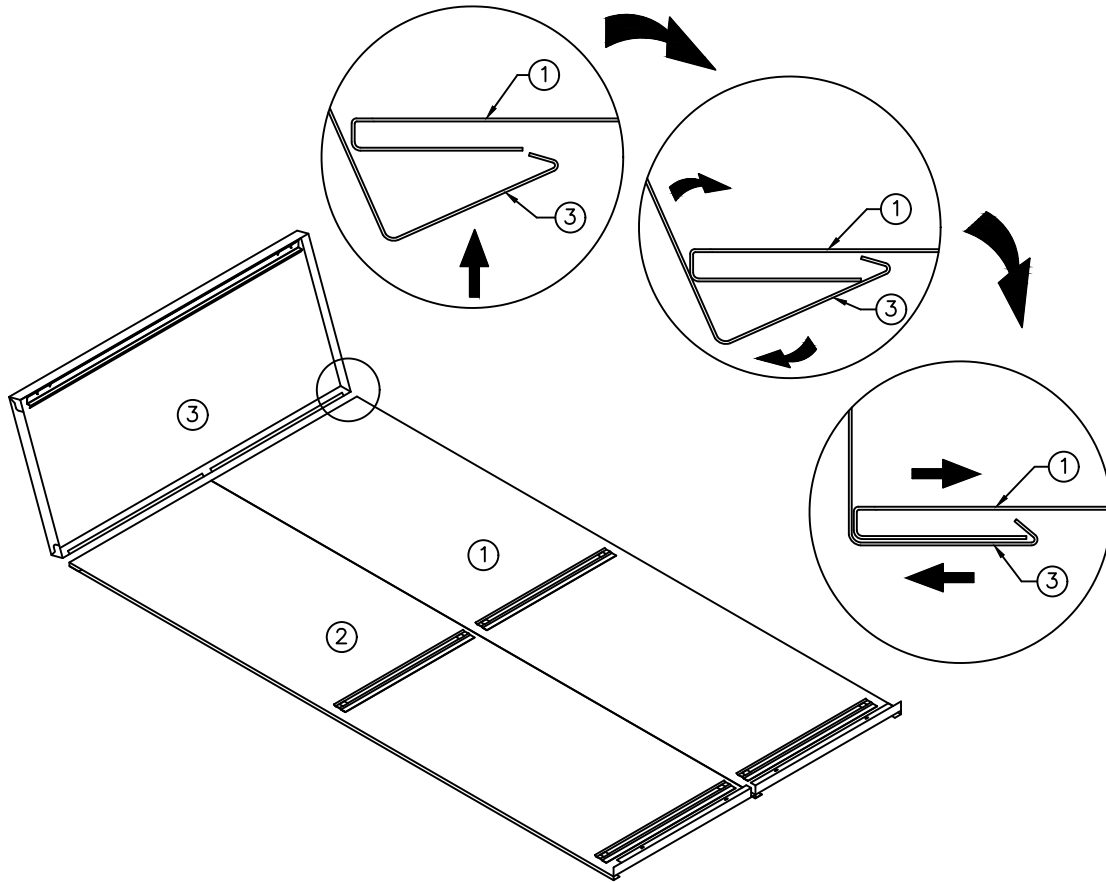

STEP : 3

LOCATING THE CORNER STRENGTHENING PIECE IN THE TOP PANEL

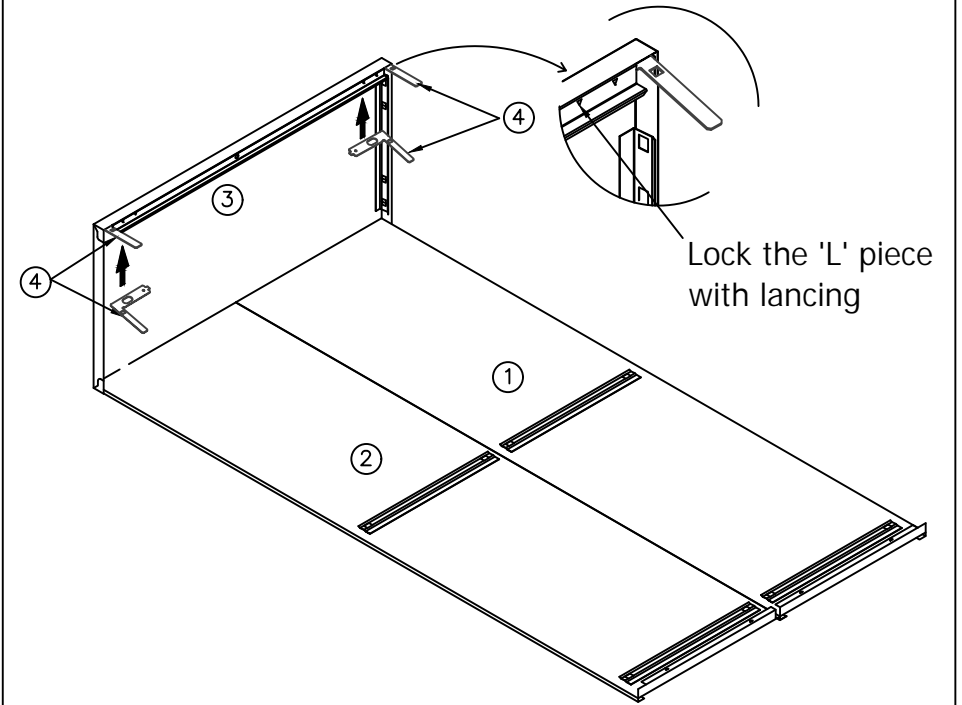

STEP : 4A

### SIDE PANEL INSERTION

Insert the side panel RH & LH into the back panel as shown.

Then slide the side RH & LH till it connects the 'L' piece.

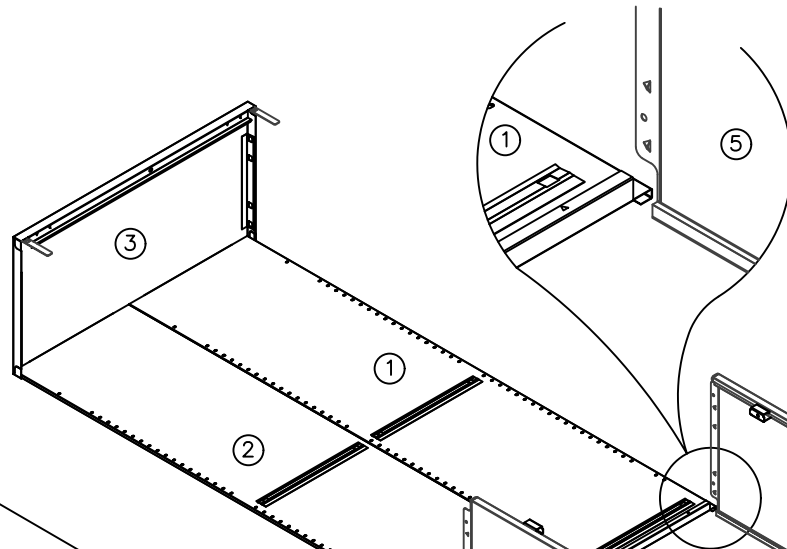

STEP : 4B

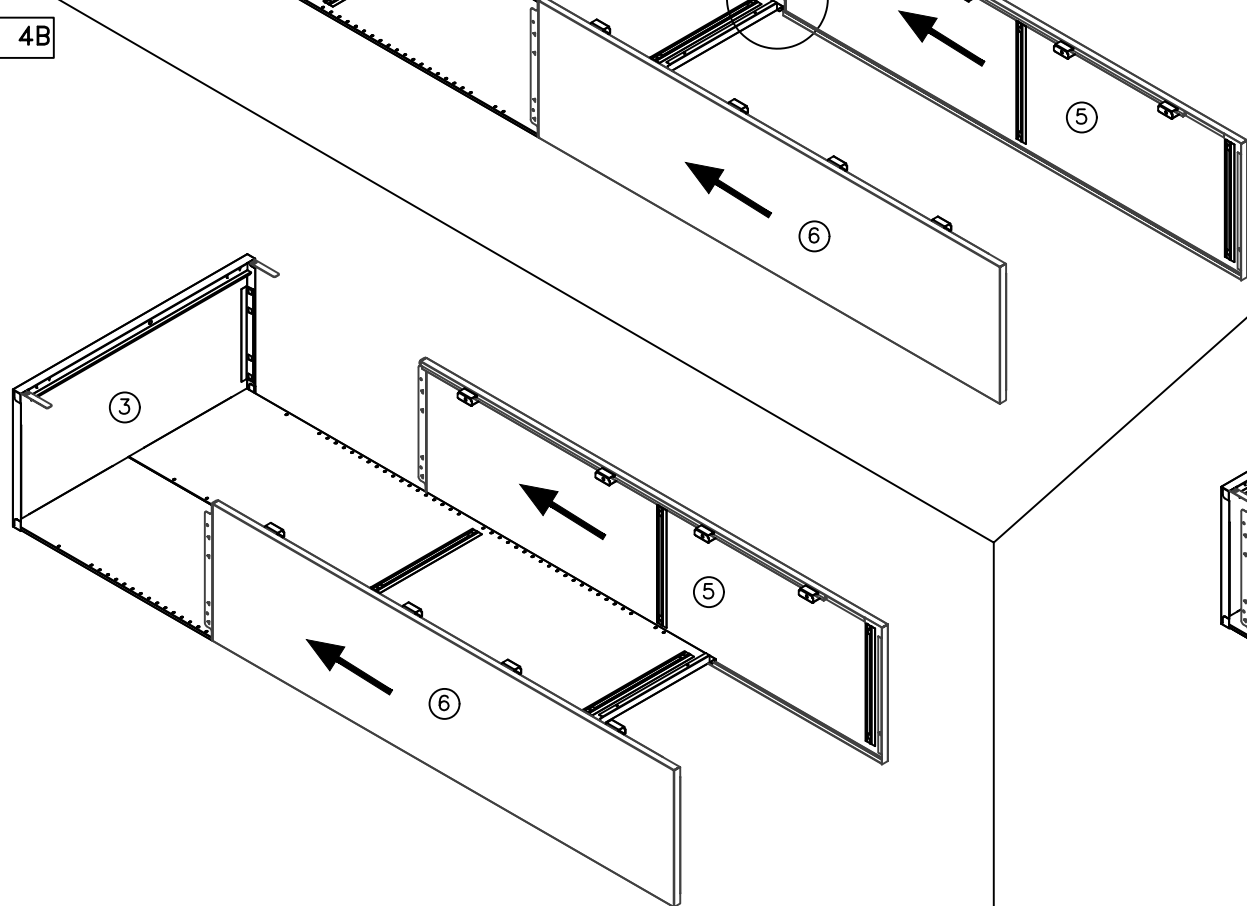

STEP : 4C

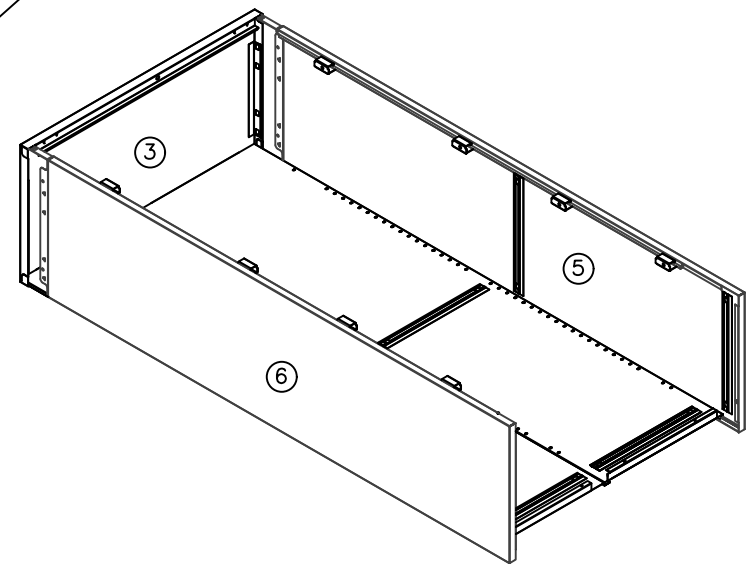

### SIDE PANEL INSERTION

Before the lancements are engaged with top retainers, ensure the side panel front & rear fold profiled edges are covered by top panel.

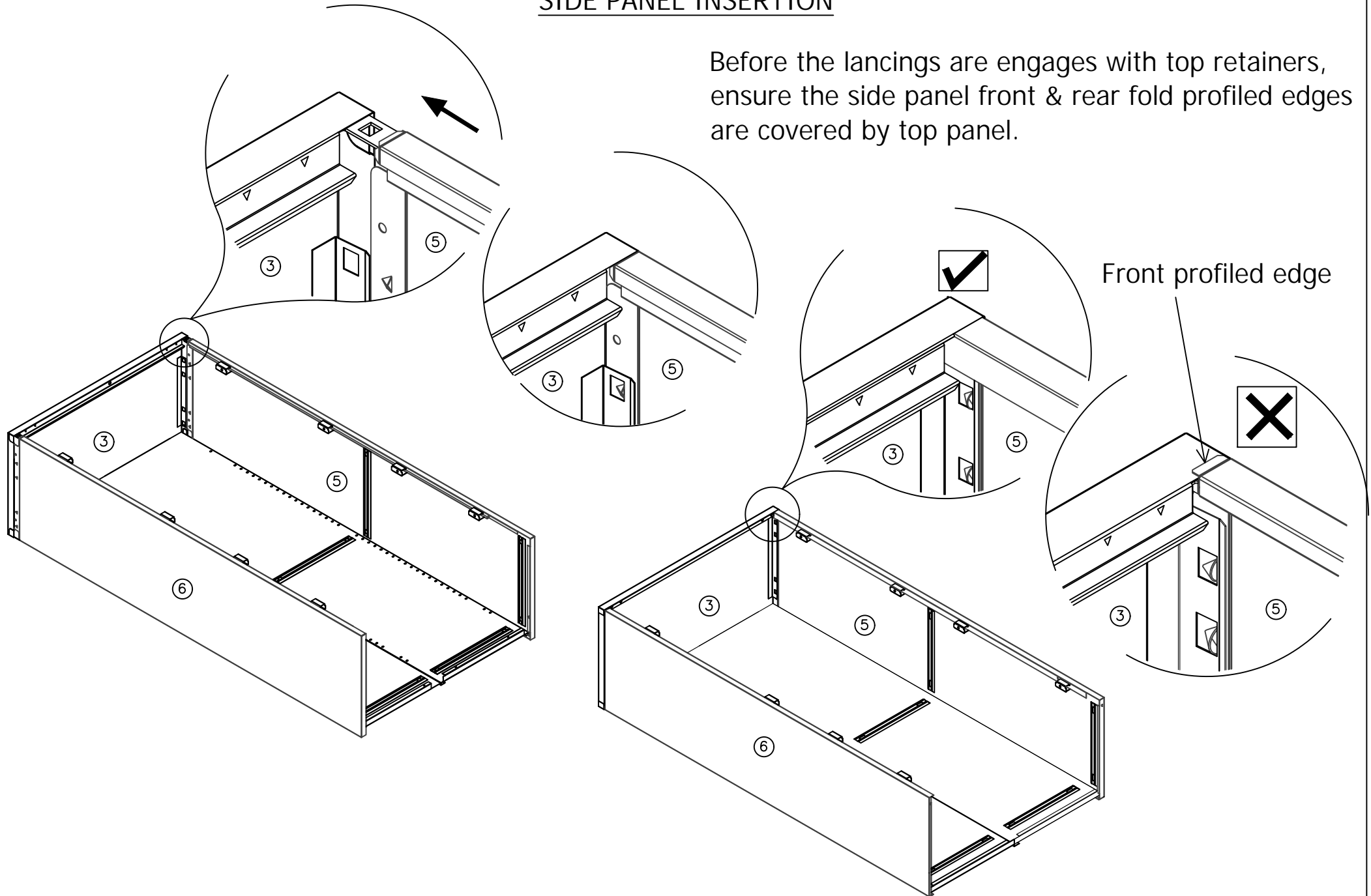

## FRONT FRAME INSERTION

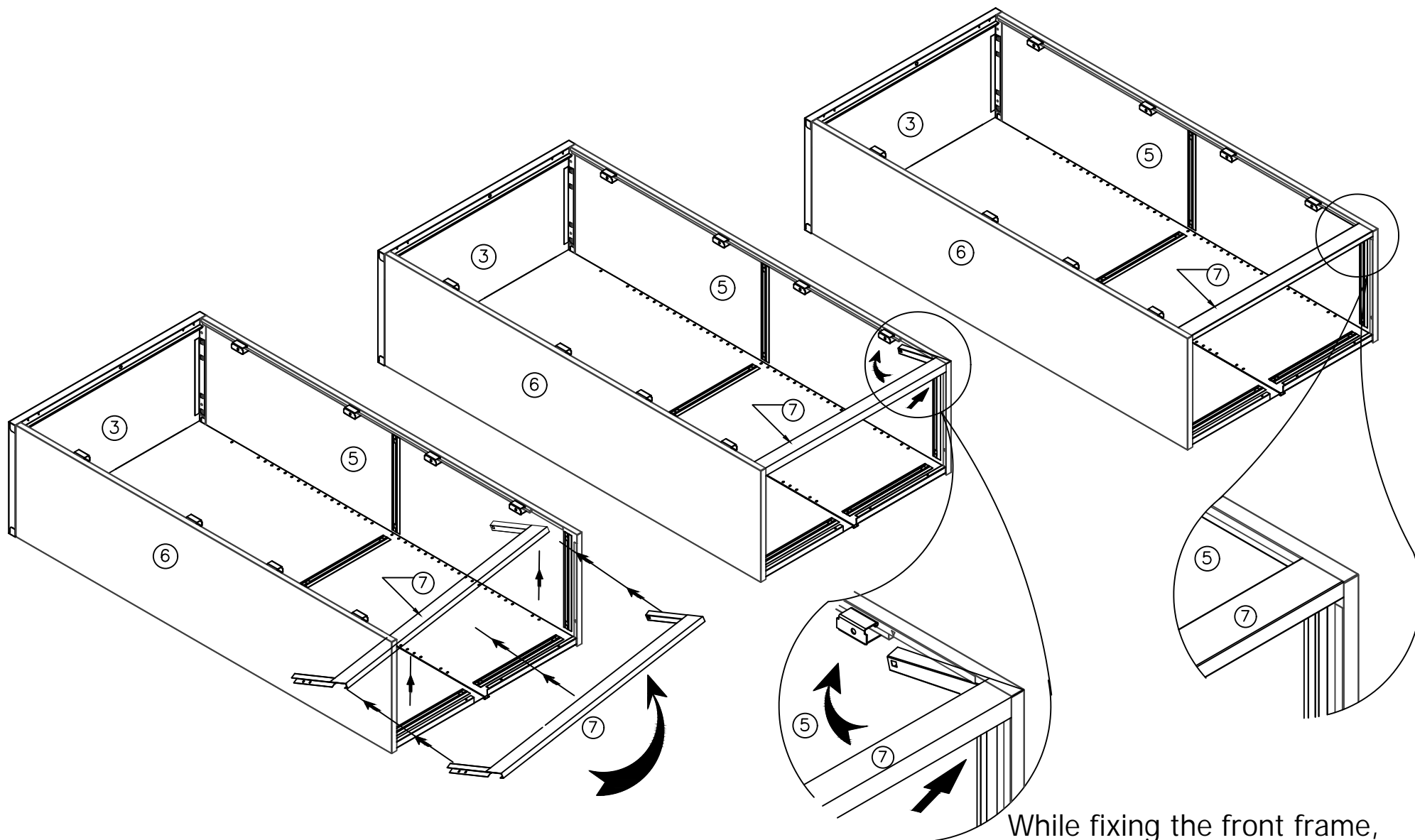

While fixing the front frame, ensure side panels front fold lancing's are engage with the front frame slots.

STEP : 7

### BACK FRAME INSERTION

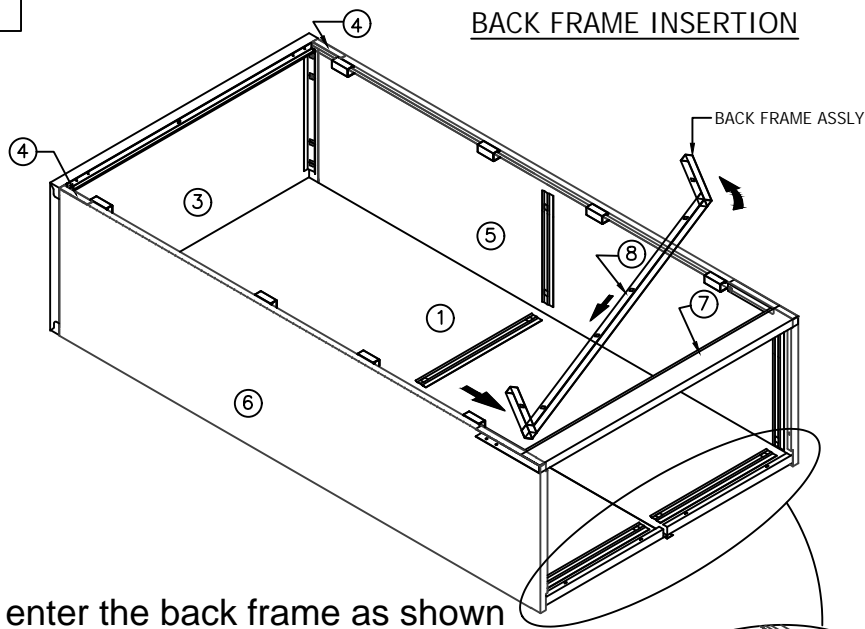

Tilt and enter the back frame as shown and insert into the side & back folds.

While fixing back frame, ensure the side panels and back panels bottom fold lancing's are engage with the back frame slots.

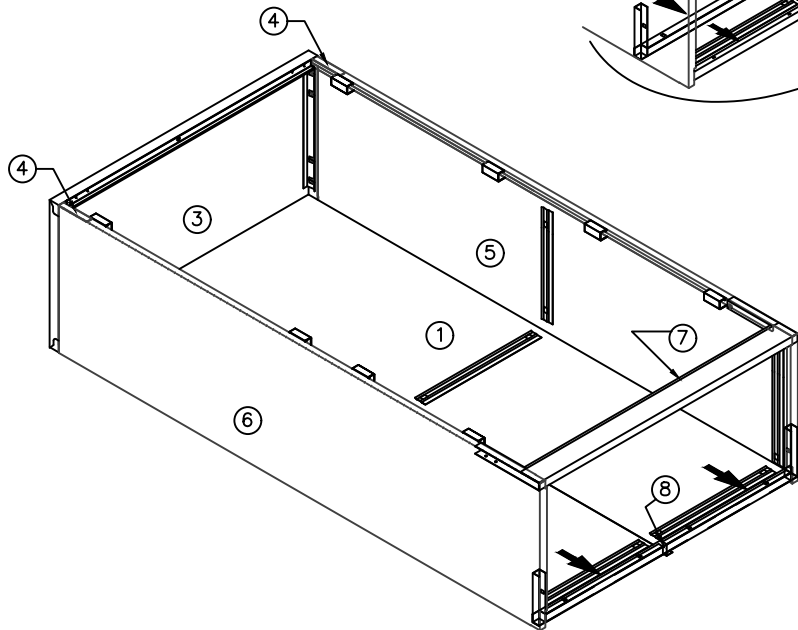
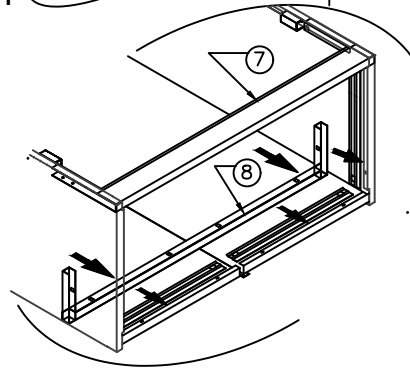

STEP : 8

### BOTTOM PANEL FIXING

Fix the bottom panel as shown.

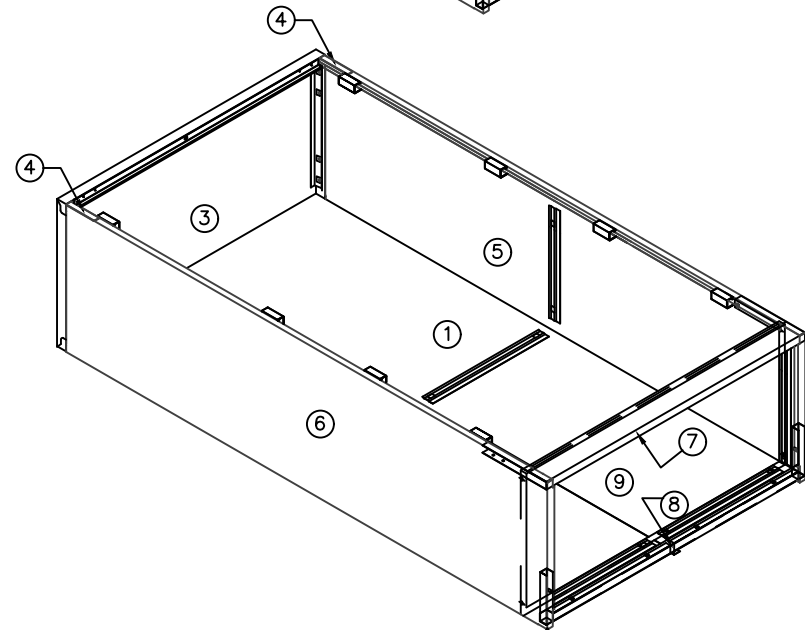
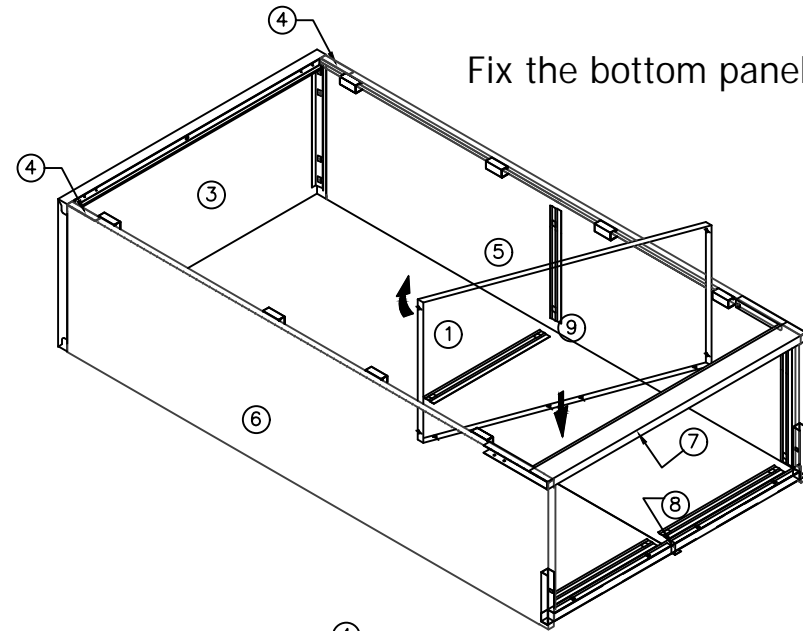

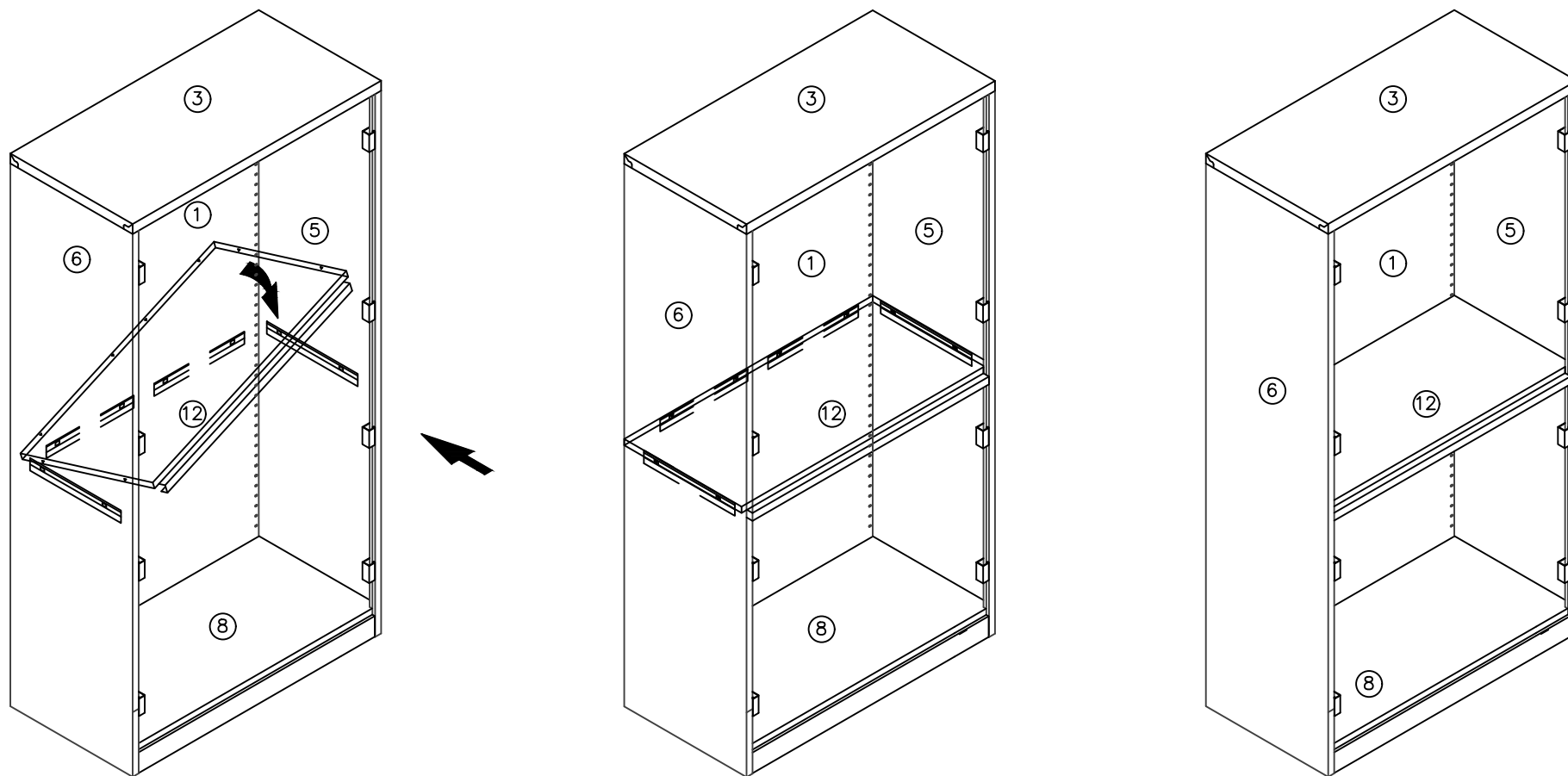
MID BOTTOM FIXING

Fix the mid bottom in to the offset of side and back panel as shown.

## MID FRAME FIXING

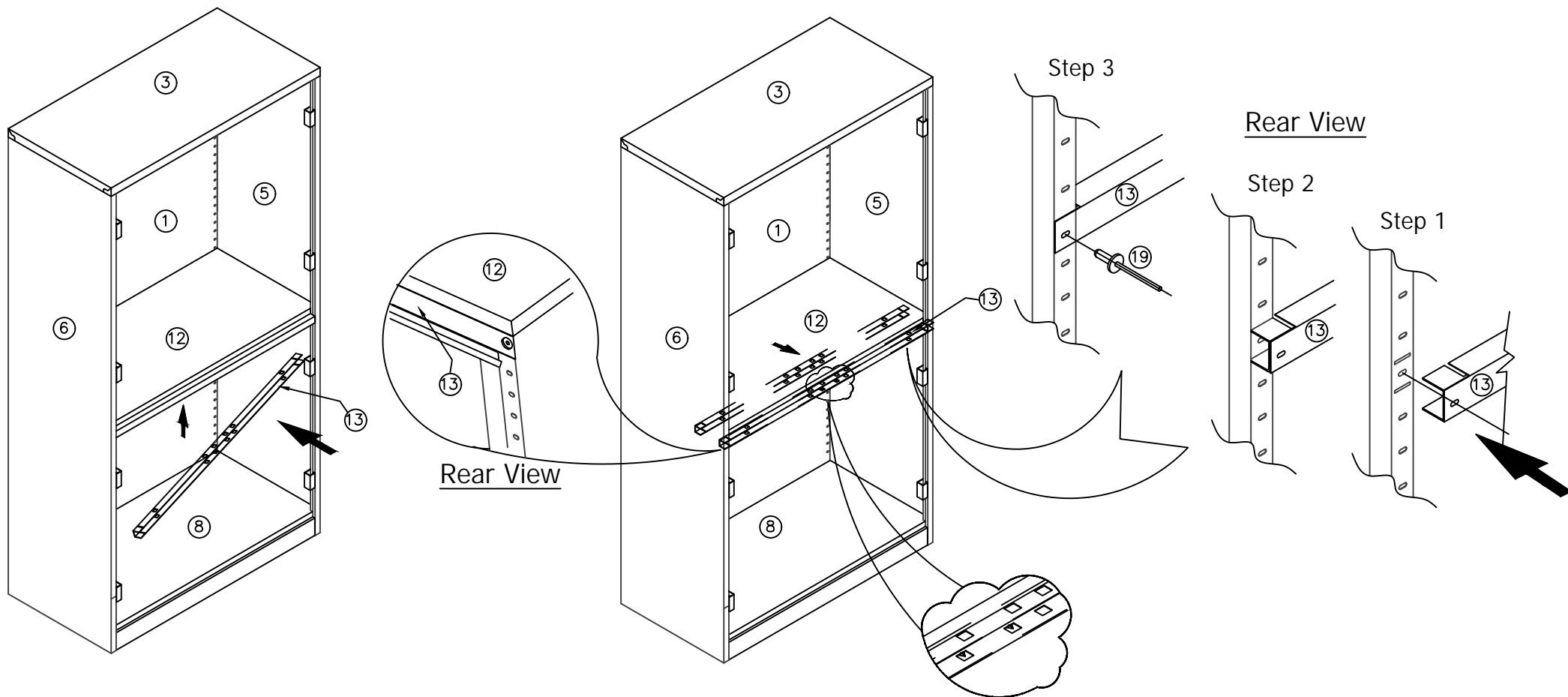

Tilt and enter the mid frame below the mid bottom panel as shown.

Then engage the mid frame end bracket prongs into the relevant slots of side stiffener and insert into the mid bottom front folds.

While fixing mid frame, ensure mid bottom lancements are fall into the mid frame slots

SHELF PANEL FIXING

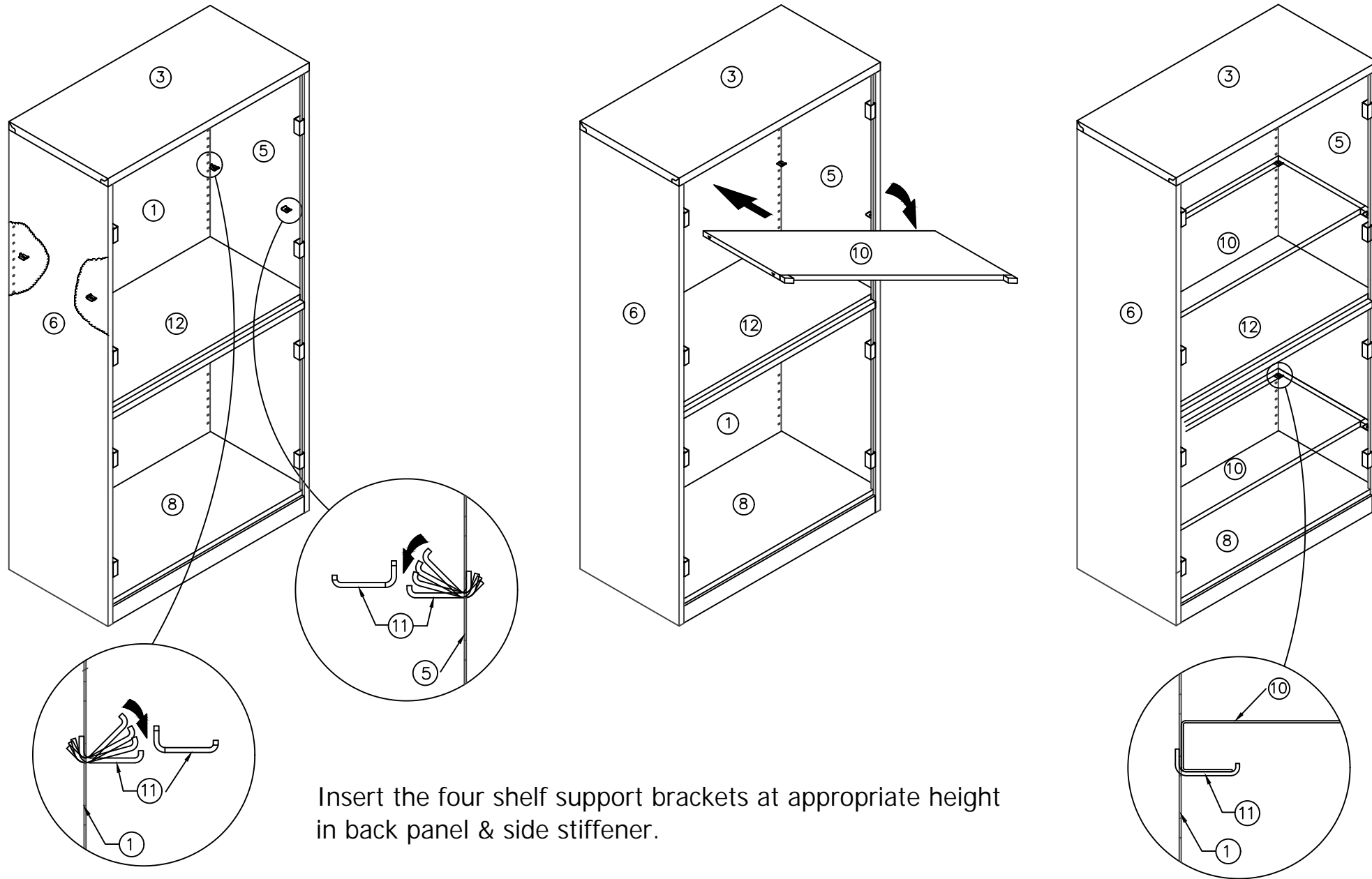

Insert the four shelf support brackets at appropriate height in back panel & side stiffener.

Place the shelf on shelf supports.

STEP : 12

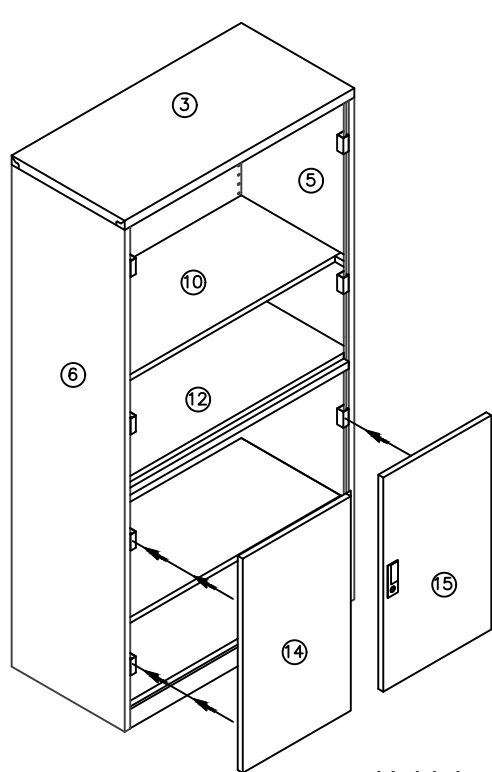

Hold the door in closed position and align the door hinges with the side hinges, then push it inside to fix.

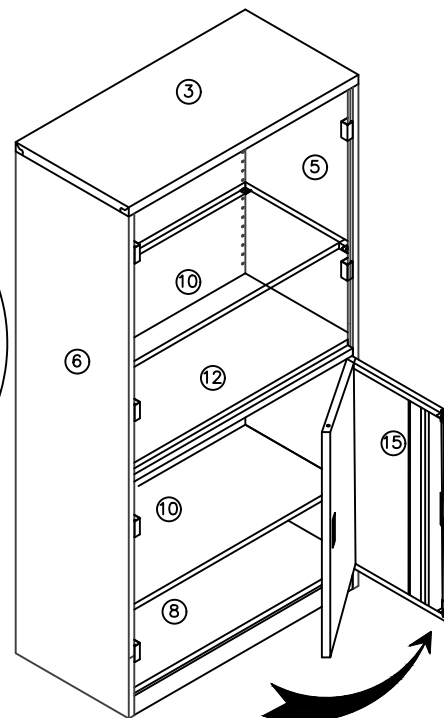
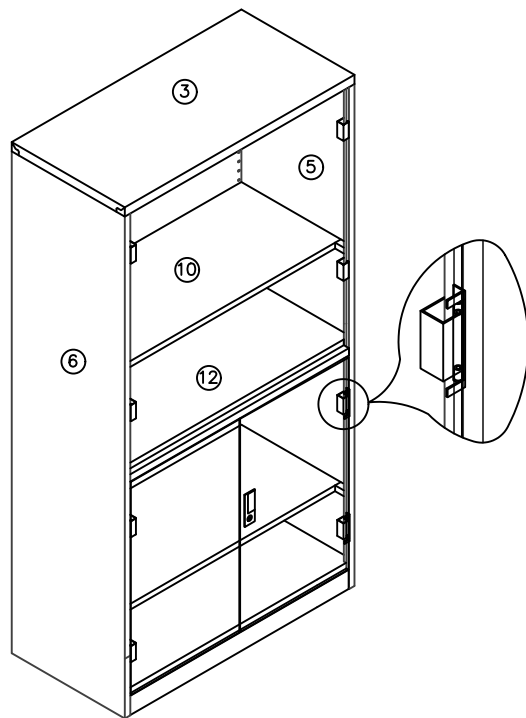

Slowly open the door and insert the hinge pin as shown.

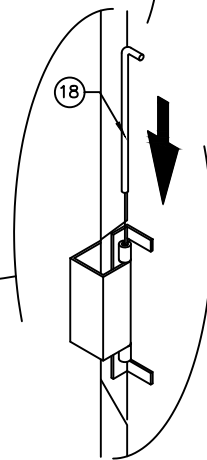
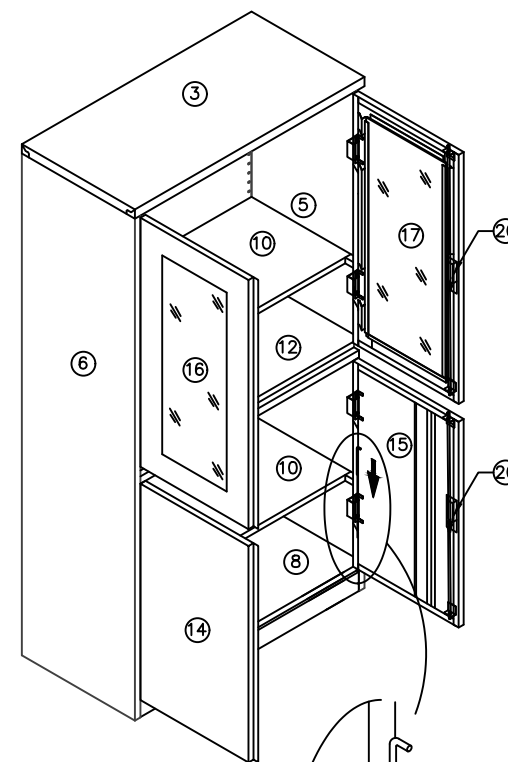

FHC Combination Glass / Steel

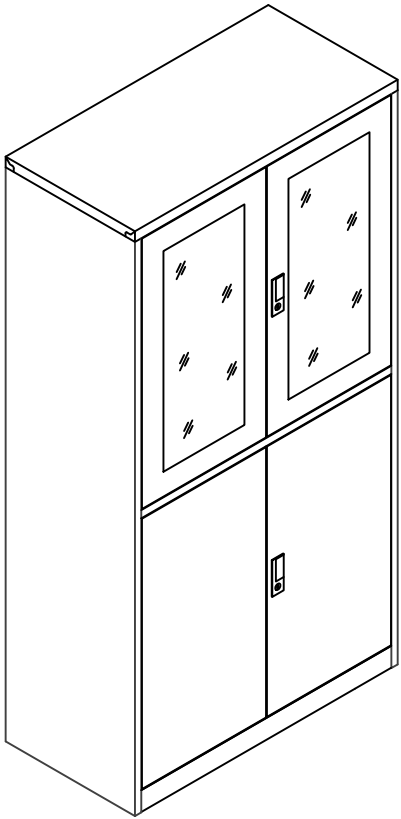

St / GI

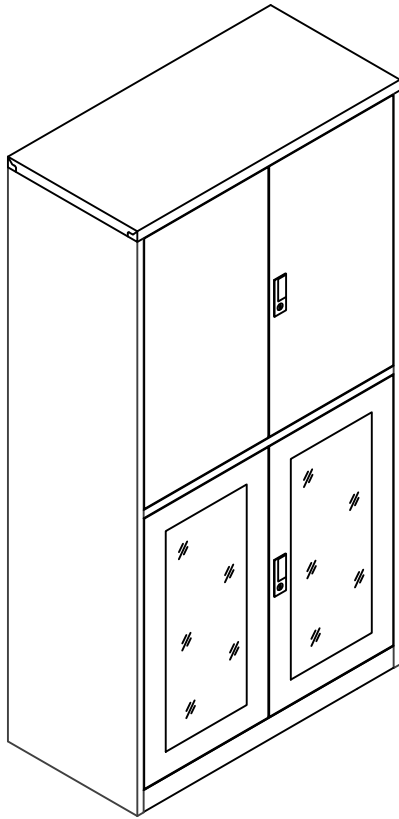

GI / GI

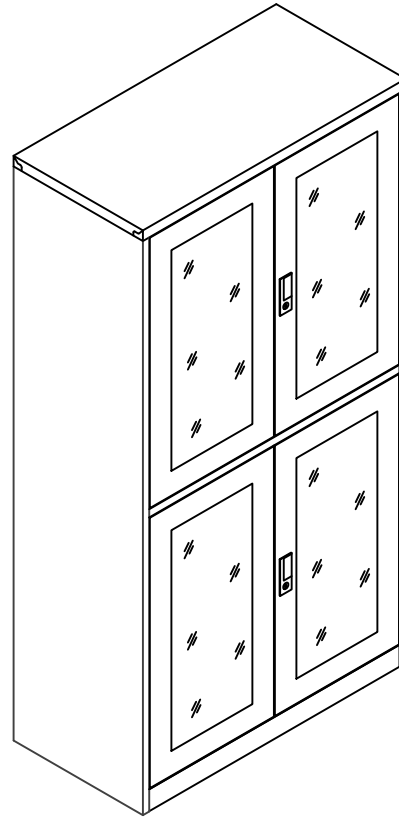

St / St

