

Lateral Filing Cabinet (LFC)

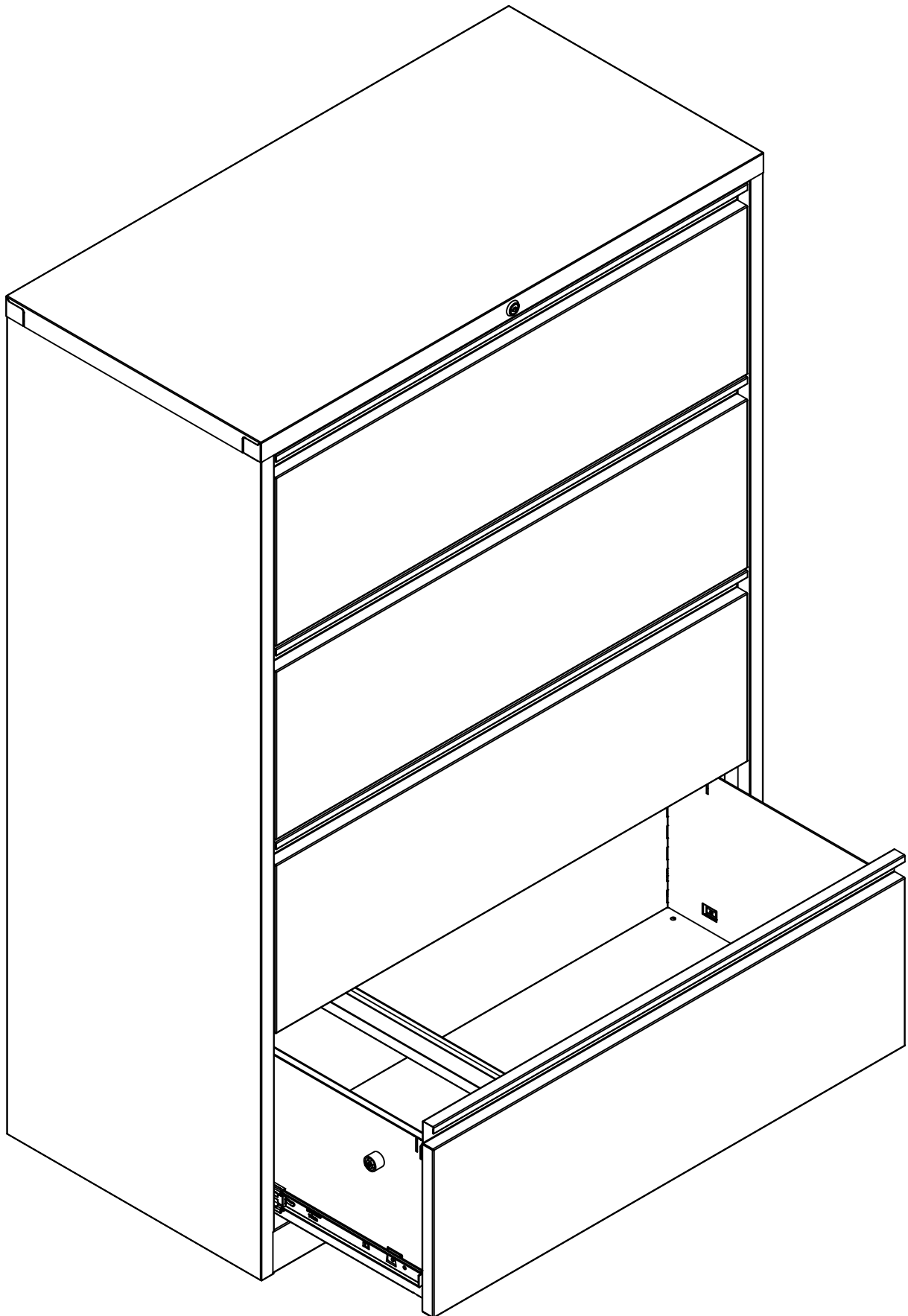

Assembly Instructions

Assembly of Drawer

Components of each Drawer

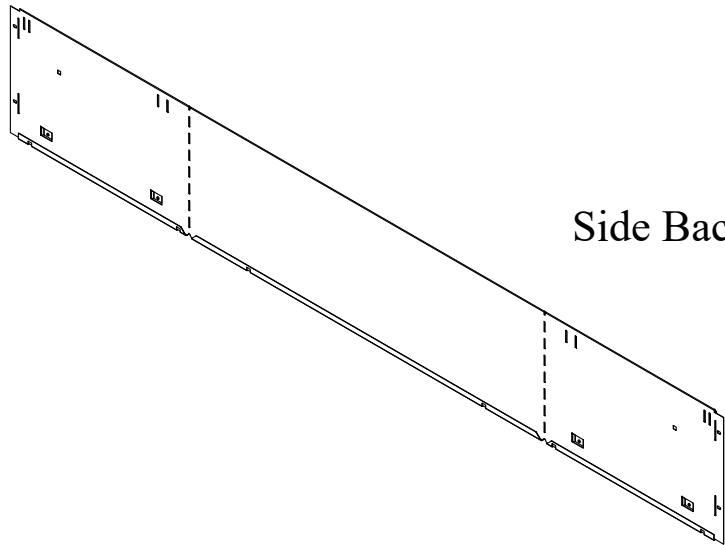

Side Back Side (SBS) Panel

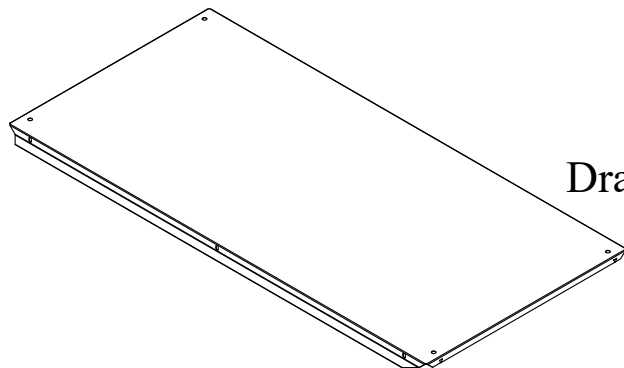

Drawer Bottom Panel

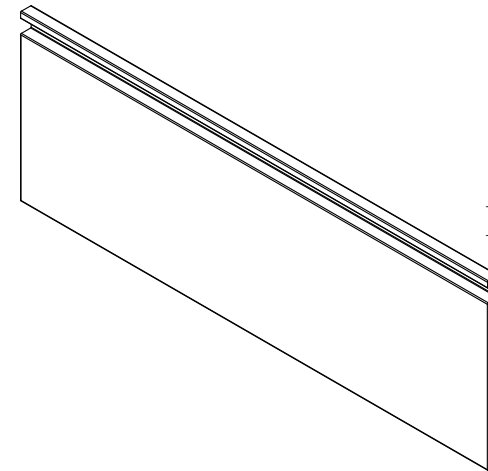

Drawer Front Panel

Assembled Drawer

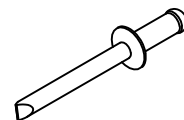
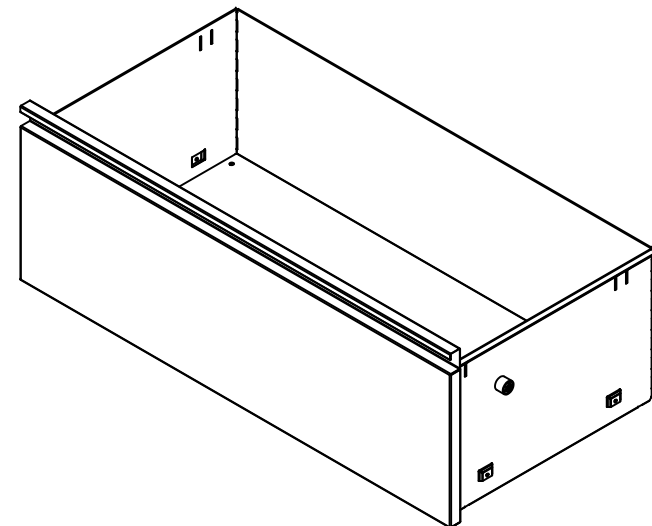

Rivet
(7 Nos.)

Folding of Side Back Side (SBS) Panel

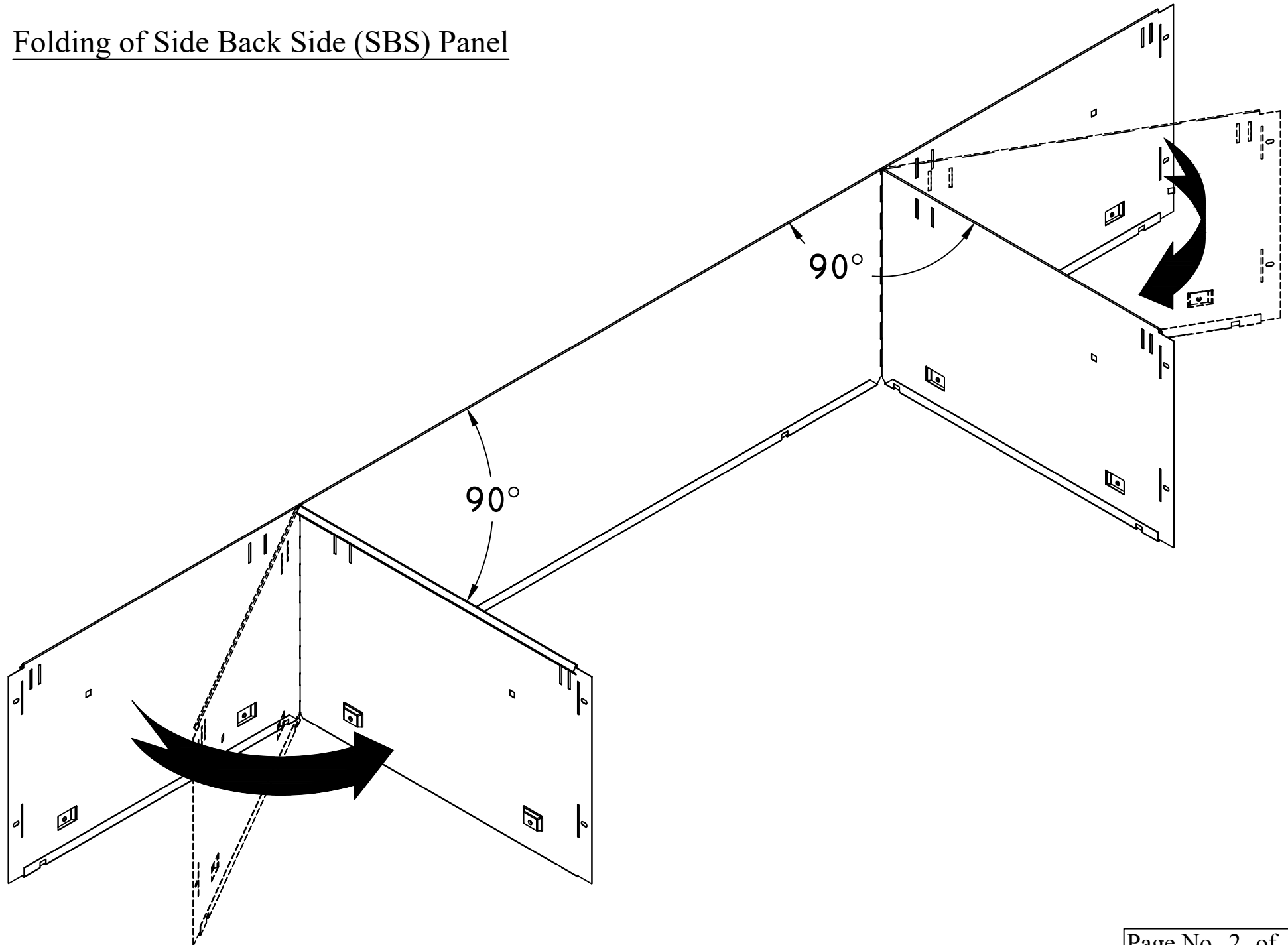

Insertion of SBS into the Drawer Front

Before inserting SBS, fold sides 2° further inwards from its right angle fold.

After insertion, all four flaps into the relevant slots on the sides and fold them firmly towards the drawer front.

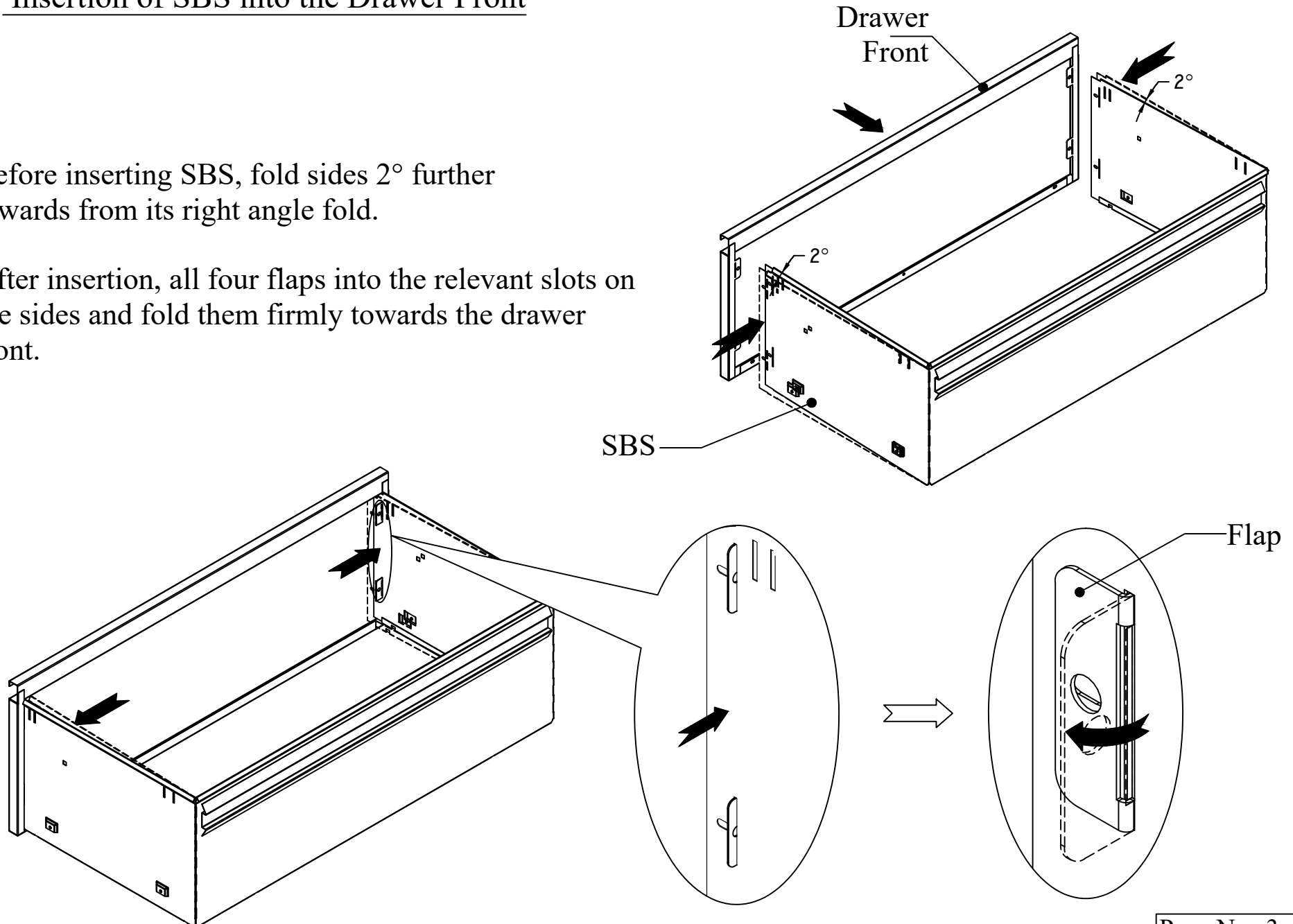

Fixing of Drawer Bottom

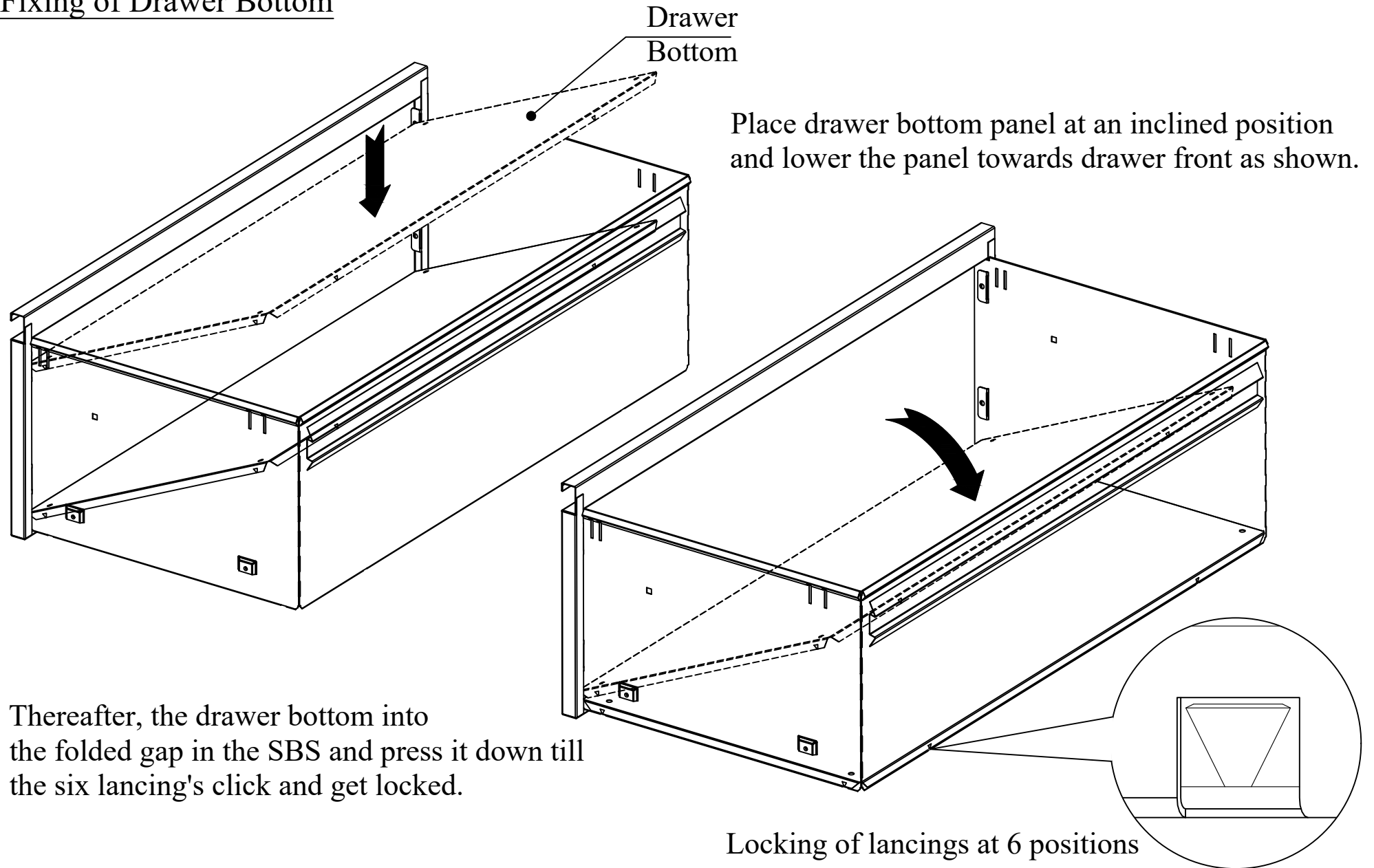

Riveting of Drawer

Rivet the drawer front
to the sides

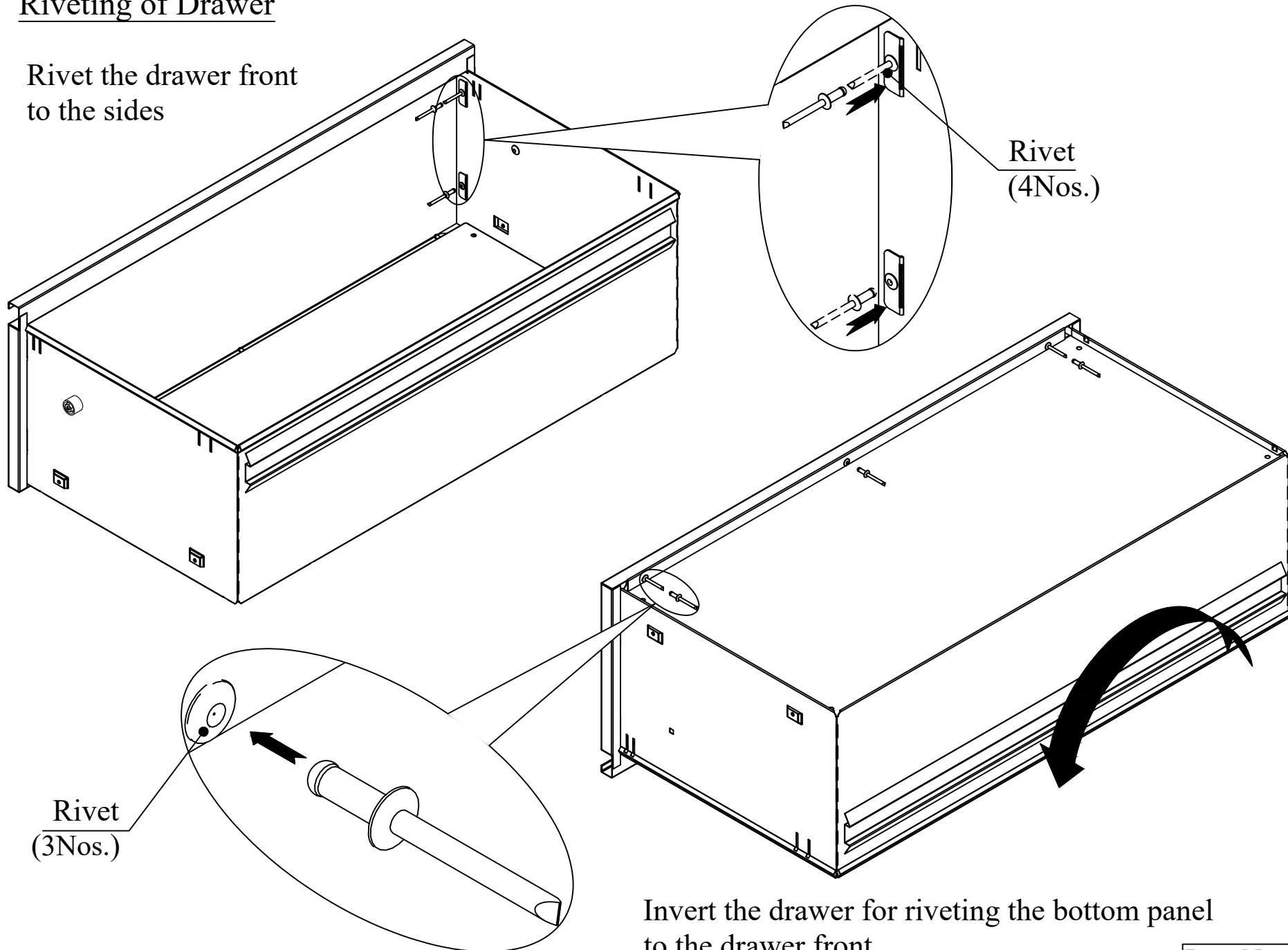

Assembly of LFC Body

Components of LFC

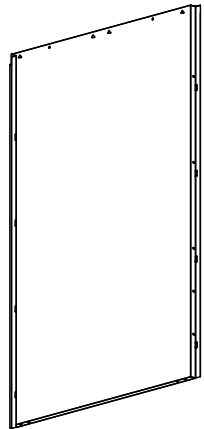

Body Back Panel

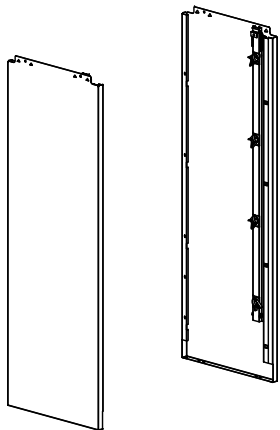

Side
Panel.
(LH&RH)

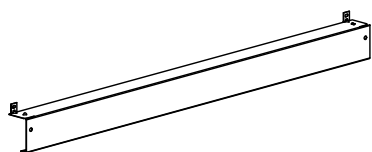

Kick Plate

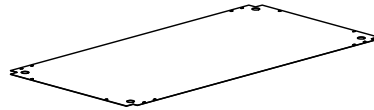

Body Bottom
Panel

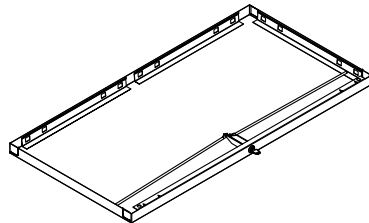

Top Panel

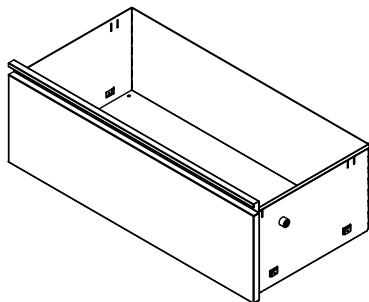

Drawer

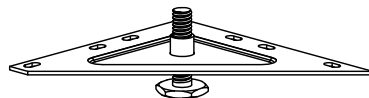

Triangle Plate
with Glide
(4 Nos.)

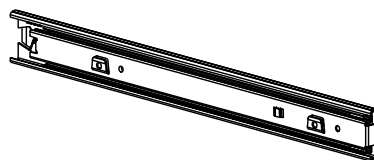

Slide
(1 Pair for each
Drawer)

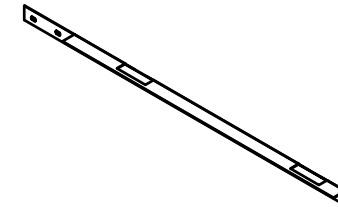

Counter Weight
Holding Section
(LH&RH)

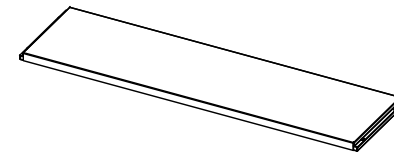

Counter Weight

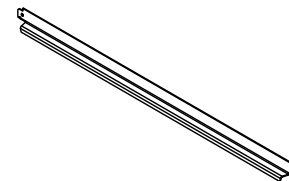

File Bar
(2 No. per Drawer Unit)

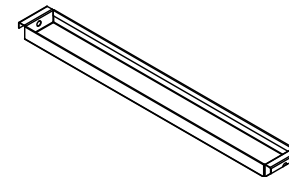

Hanging Folder Rail
(Optional)

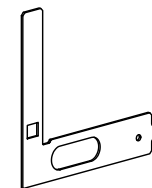

'L' Piece
(4 Nos.)

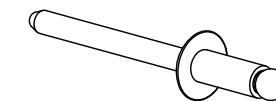

Rivets
(22 Nos.)

Hooking two side panels with back panel

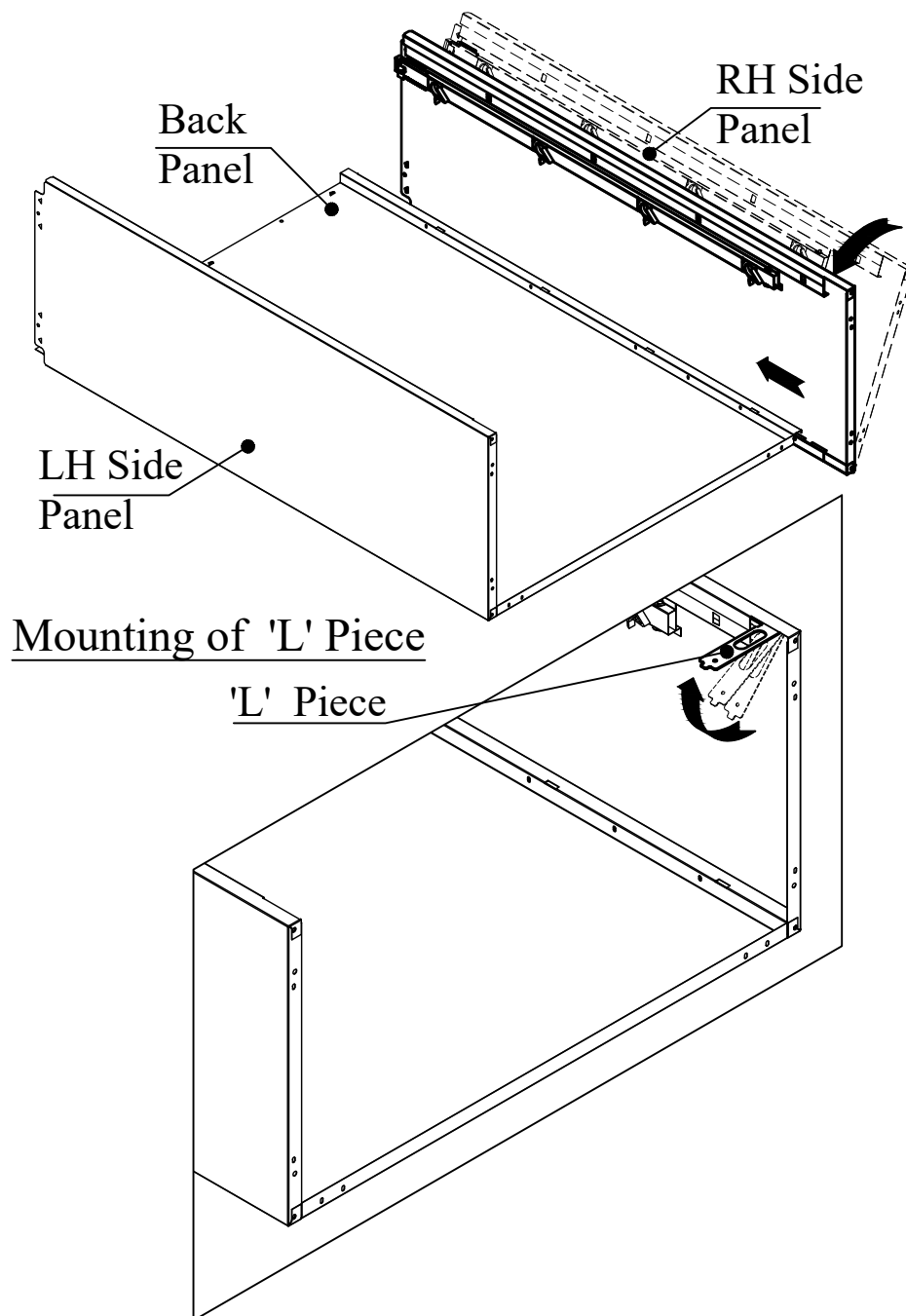

Fixing & Riveting of Kick Plate

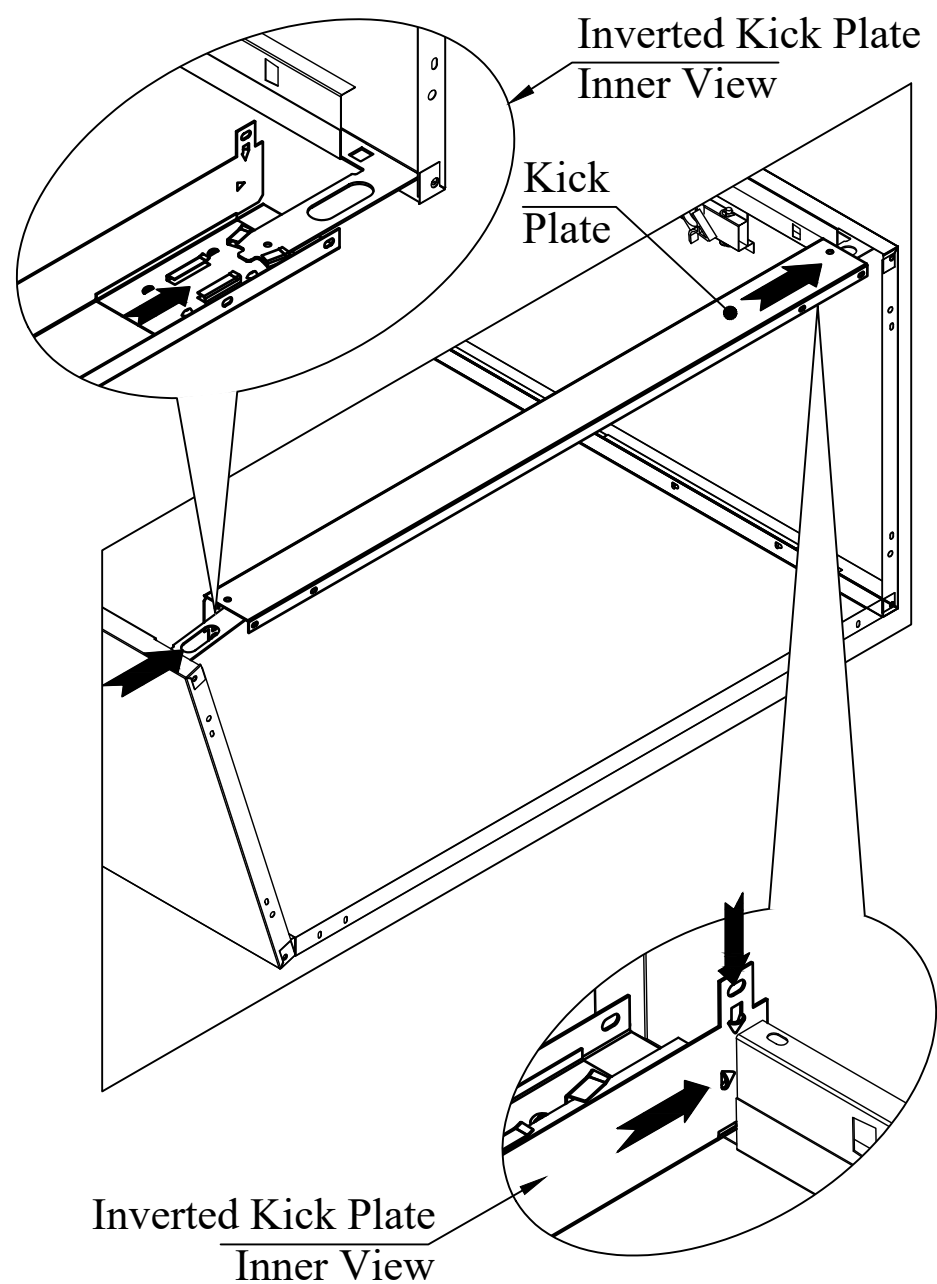

Fixing of Body Bottom Panel

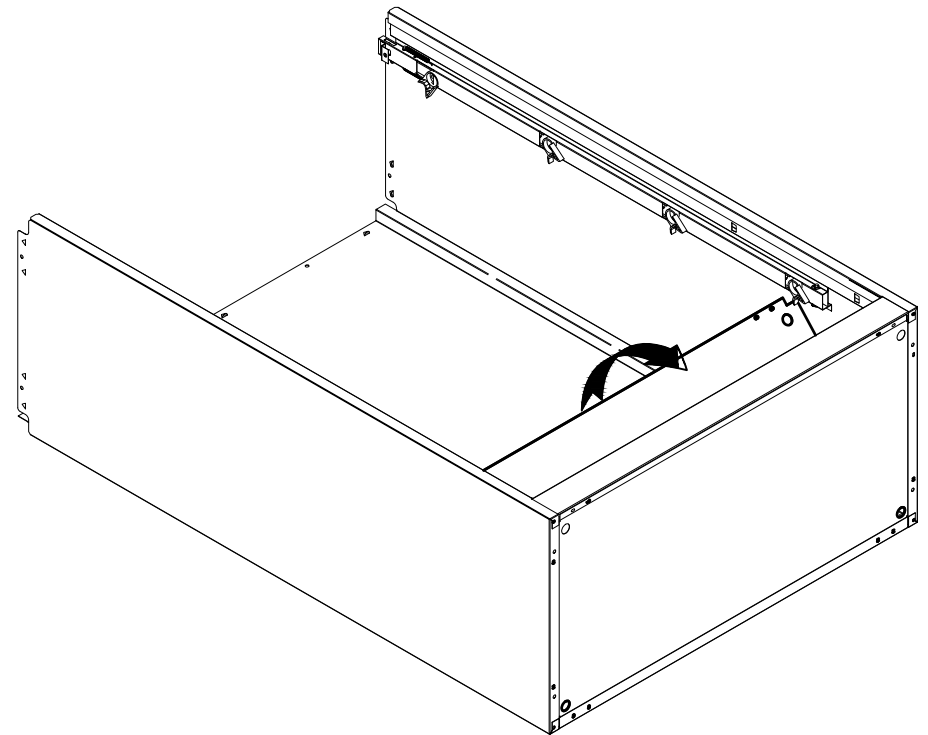
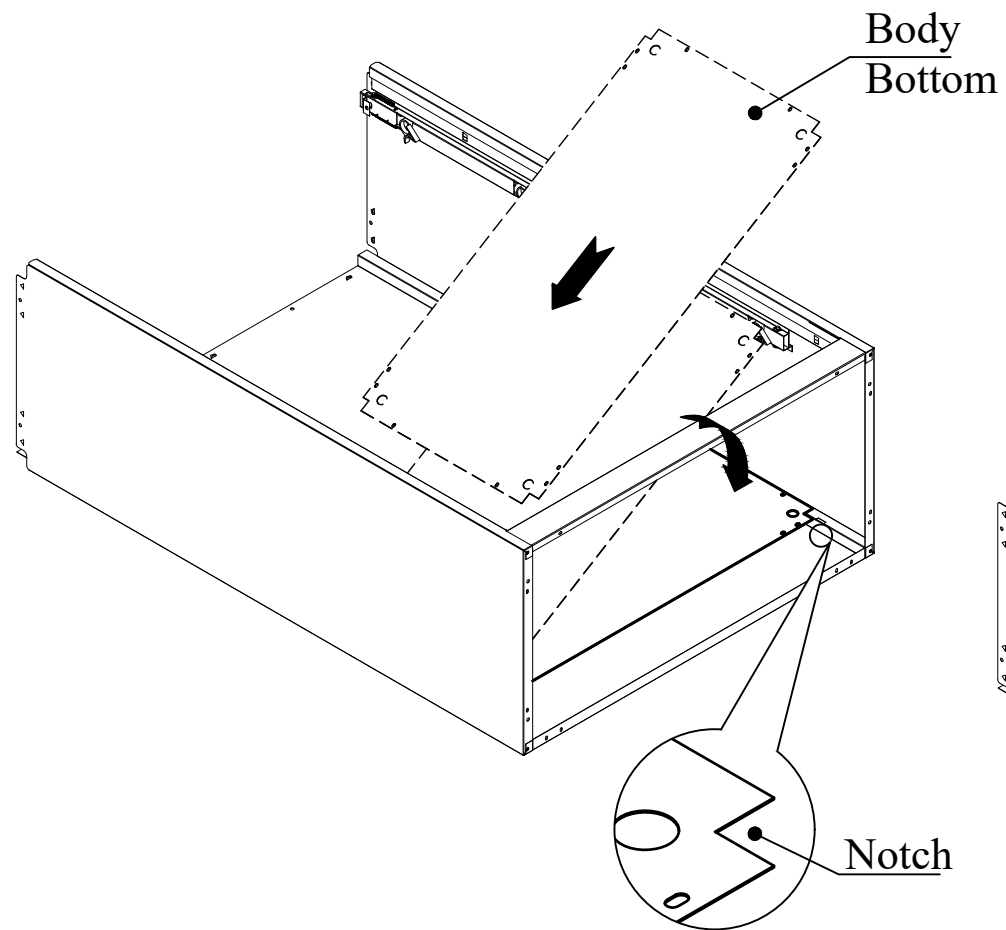

While inserting the body bottom panel, keep big notch at back side and small notch at front side

Counter Weight Holding Section & Slide Fixing

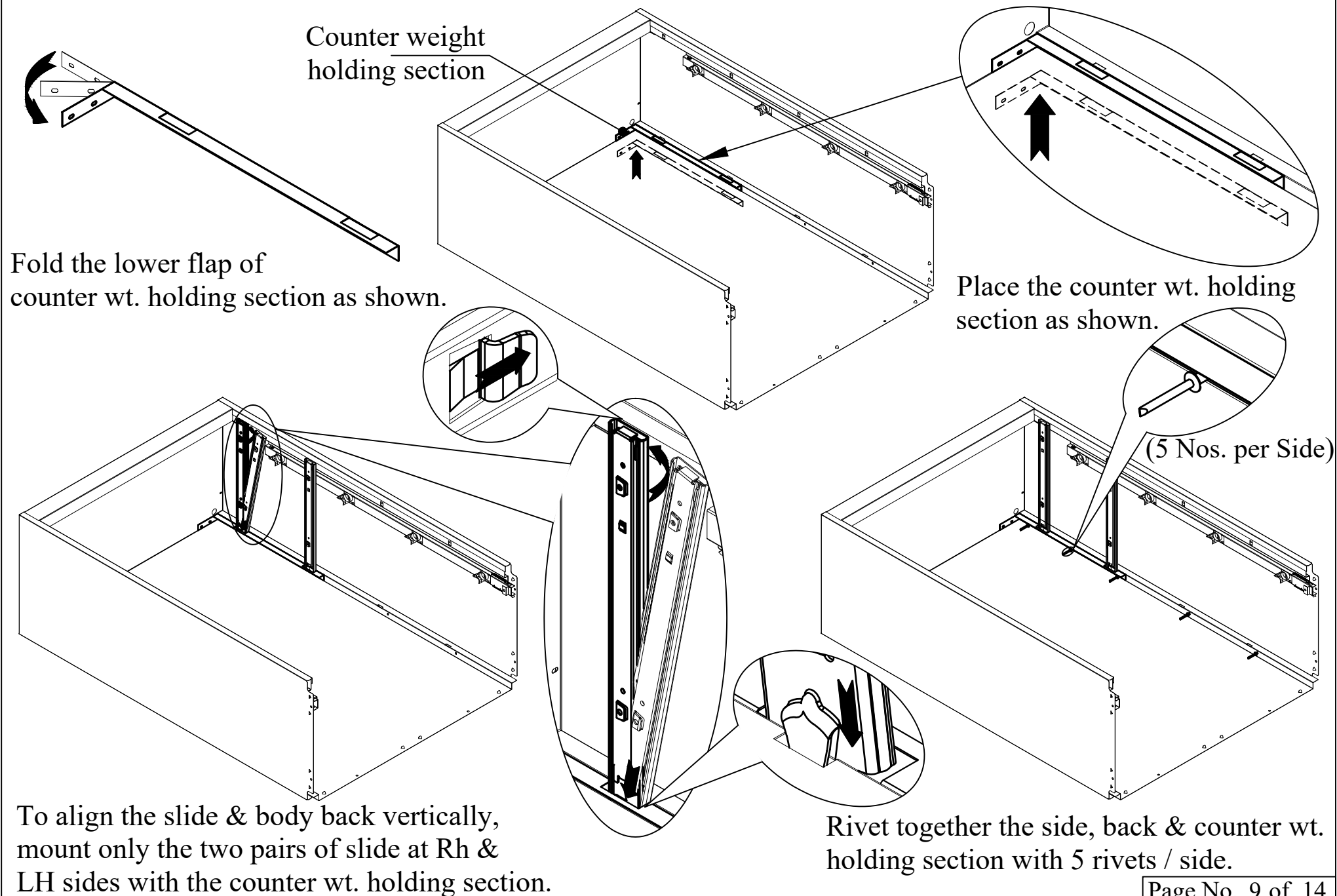

Triangle Plate Mounting & Riveting

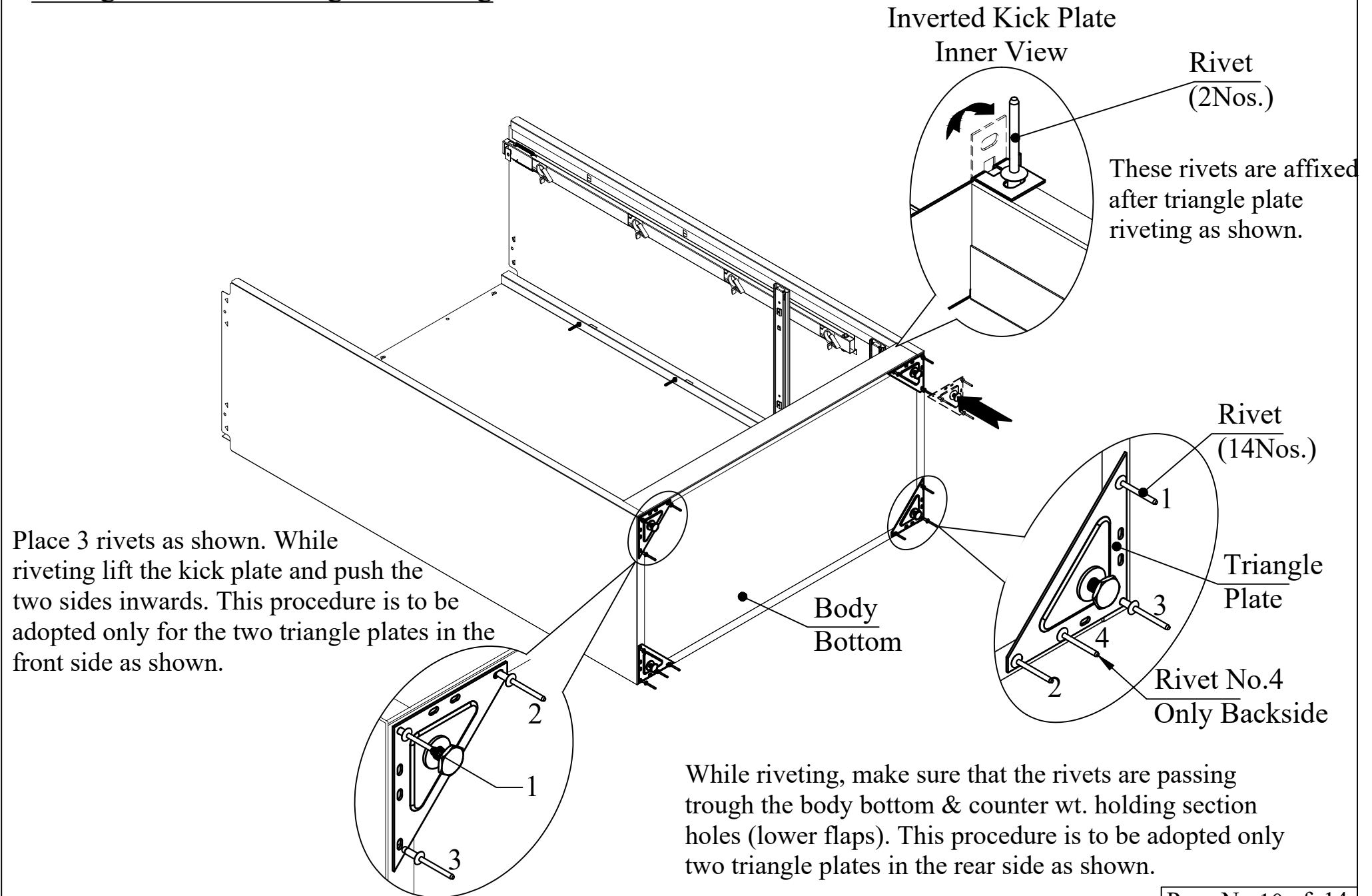

Adding Counter Weight

Before adding the counter weight, remove all slides.

Add 1st counter wt. into the counter wt. holding section.

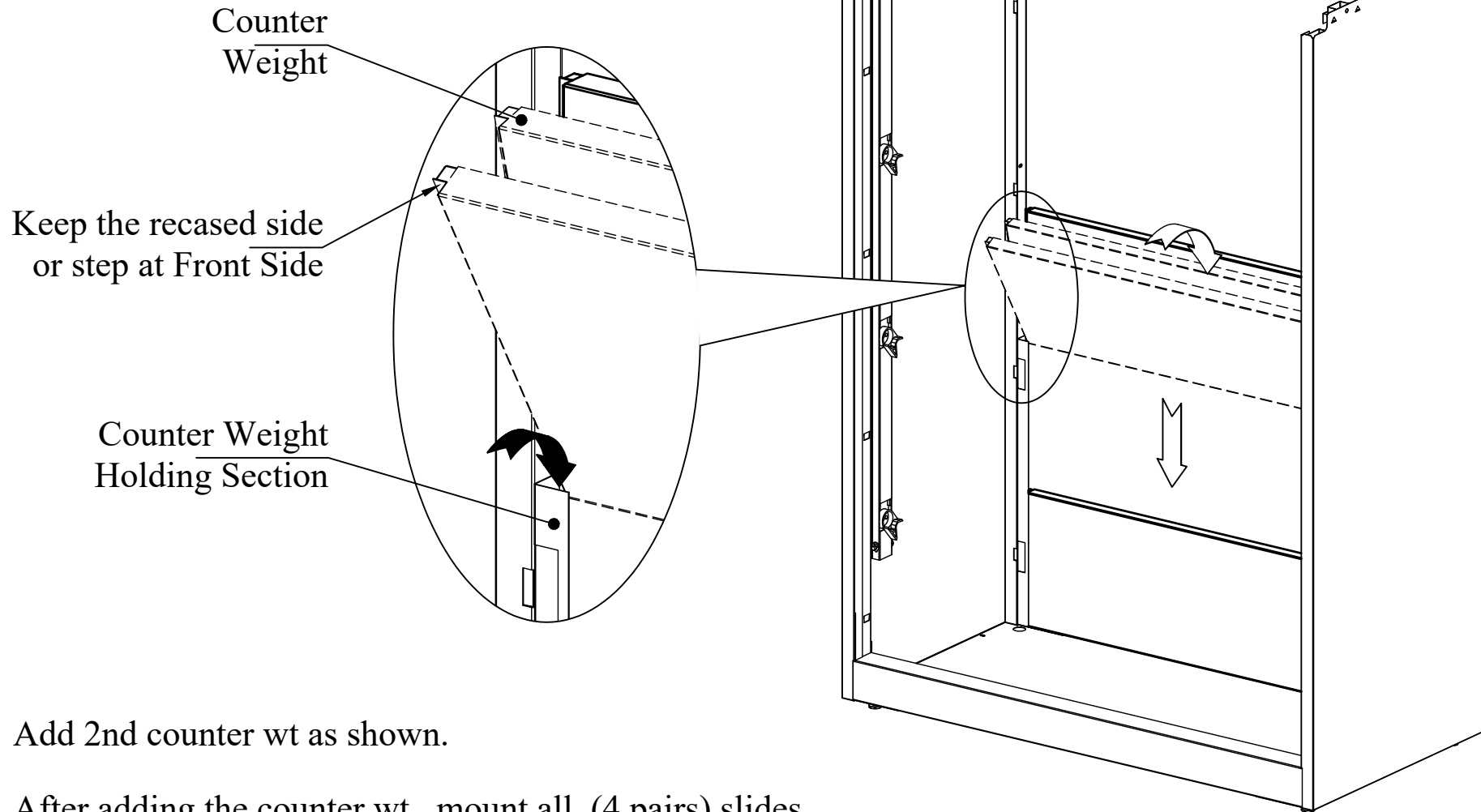

Add 2nd counter wt as shown.

After adding the counter wt., mount all (4 pairs) slides.

Fixing of Top Panel

Insert the top panel into the back & side panel and hold at an angle as shown.

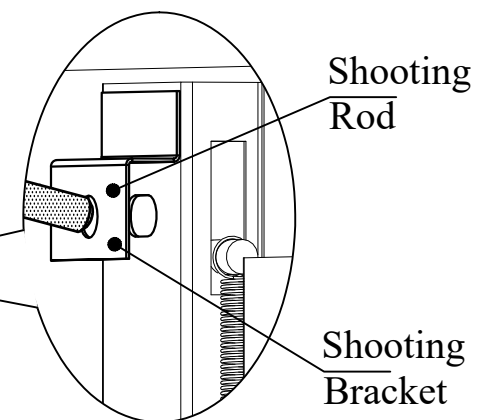
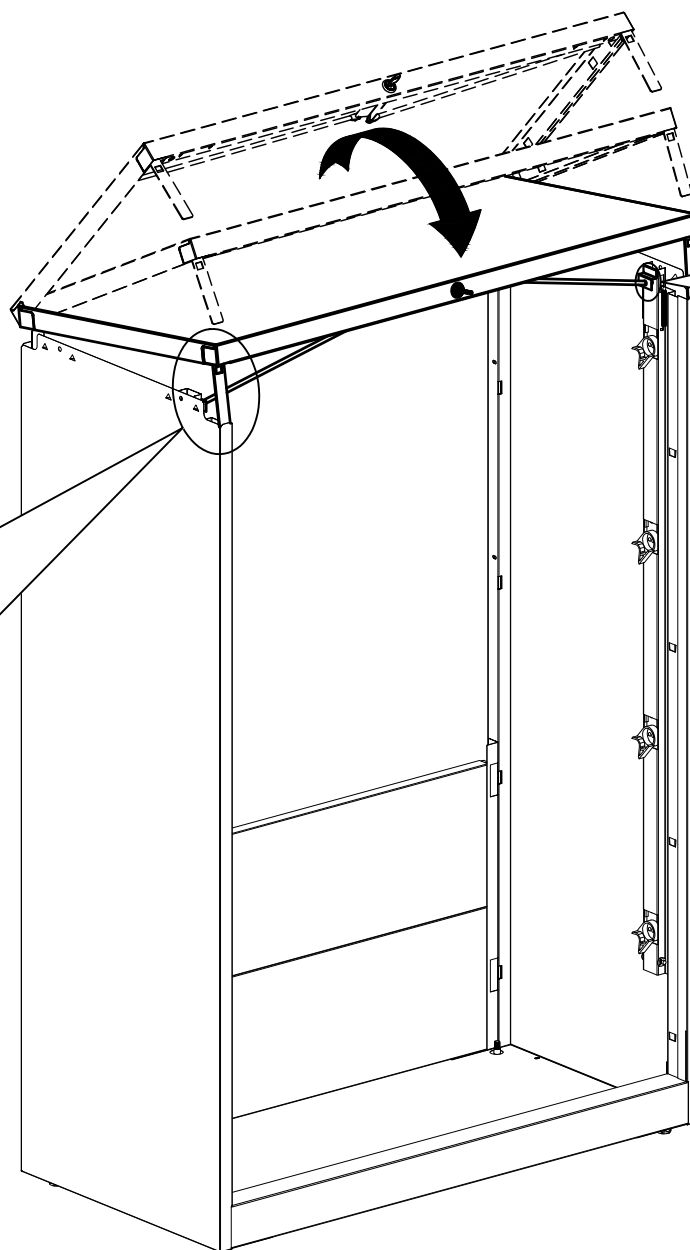
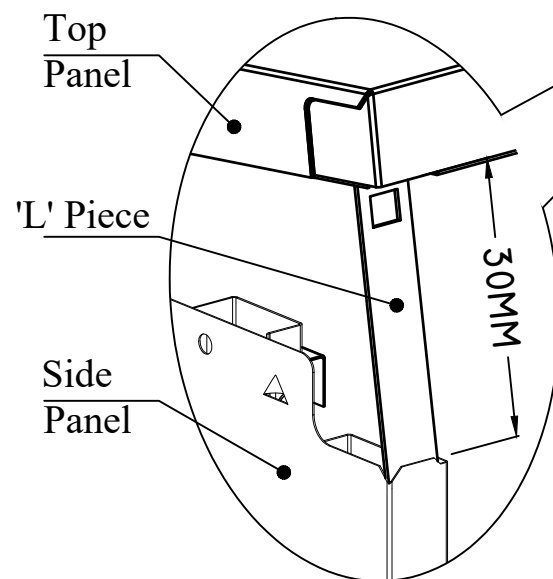

After 'L' piece insertion, turn the key in counterclockwise (Unlock position) and insert the shooting rods into the shooting bracket of R.H. & L.H. sides.

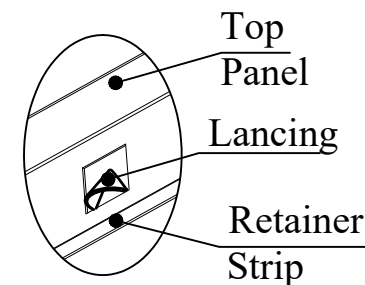

While closing the top, make sure that the back & Sides panels are passing into the angular strip as shown above.

Ensure that all lancing's are engaged with the retainer strip.

LFC DRAWER UNIT

CAUTION

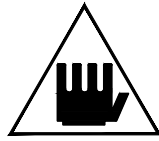

PRECAUTION

To prevent tipping and possible injury

1. Each cabinet is equipped with interlock mechanism so that only one drawer can be opened at a time. However, for added safety, always close the drawer in use before opening another drawer.
2. Load cabinet starting with the bottom drawer and work upwards. Reverse this procedure for unloading.
3. Wherever possible, place heavier material in the lower drawers.
4. Cabinets may be bolted together for additional stability. Counter weight may be required for cabinets that cannot be bolted together.

Even if counter weight is provided, it is always advisable to follow the above precautions.

Before Drawer Mounting

RH & LH Knobs are in closed position and pointing inwards

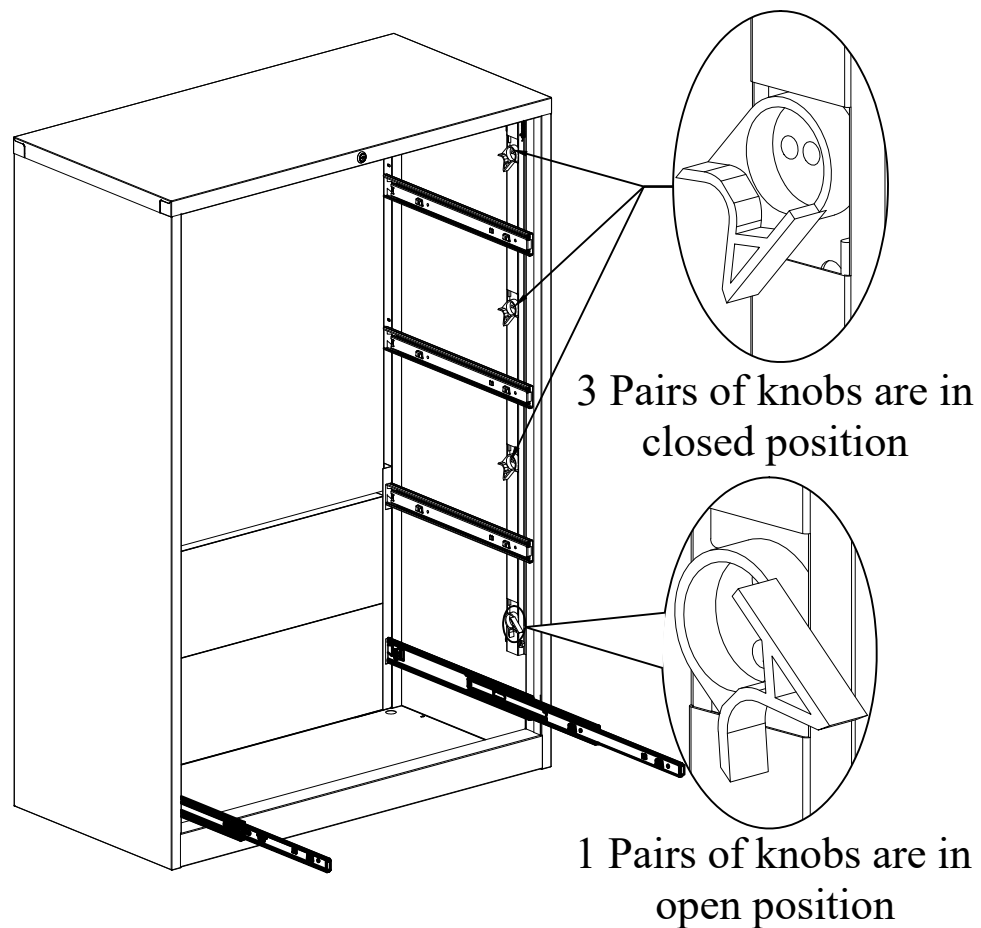

RH & LH Knobs are in open position and pointing outwards to enable mounting of the drawer units.

Mounting of Drawer Unit

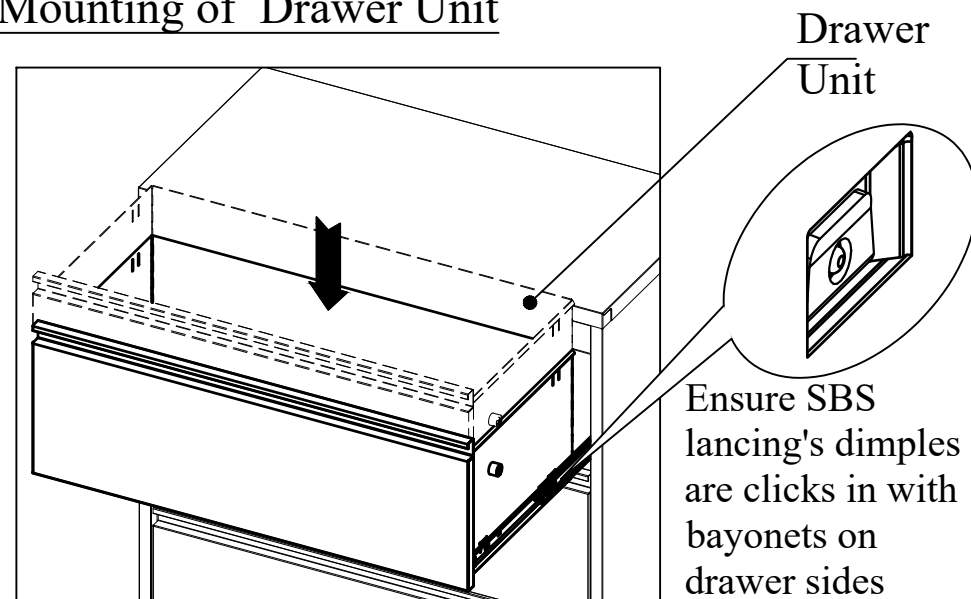

Close each mounted drawer unit for mounting of subsequent drawer units.

Mounting of File Bar and Hanging Folder Rail

